



**Application Guide**  
**Universal Shaver Unit**

**CAT. NO.**  
**ET3727V**

**NEO**

Thank you for using **Schneider Electric** NEO Universal Shaver Unit. To ensure proper application of our product, please read the following information before installation and use.

**This application guide applies to the following shaver socket outlet:**



**Cat. no.**  
ET3727V

**Description**  
115/240V Universal Shaver Unit,  
Vertical

## **FEATURES**

1. Distinctive and superior socket outlet, which enhances your interior design.
2. Slim and stylish flush plate finishes with cross-type structural support to provide extra rigidity to flush plate.

## **SPECIFICATIONS**

Input Voltage	: 240V~ 50/60Hz
Output Voltage	: 115/240V~
Dimension	: 147mm x 87mm x 57mm
Mounting Centre	: 120.6mm
Compliance	: IEC 61558-1, IEC 61558-2-5

## MOUNTING INSTRUCTION

Please refer to the following diagram for proper installation of the faceplate and surround.

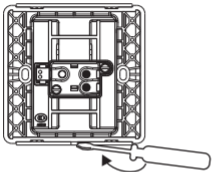

Wall Box

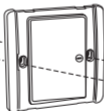

Faceplate

Mounting  
Screws



Surround

### Remark:

For surround mounting, align the clip locks on the faceplate and press firmly on the surround. Complete engagement of the clip locks is indicated by a clear "click" sound.

## IMPORTANT NOTE

1. Please check your local wiring regulation before actual installation.
2. Only suitable for chargers or electrical products not exceeding 20VA.

## WIRING DIAGRAM

