

# Datasheet

## Sealed Miniature Toggle

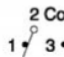
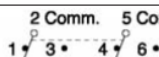

RS Stock number 448-1037

### Number of Poles/Dimensions

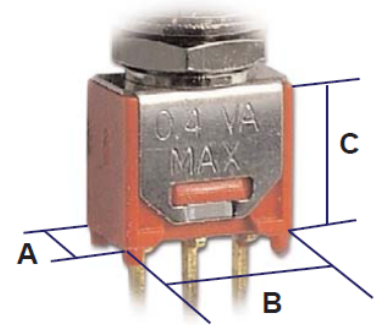
		A	B	C
<b>1</b>	SPDT  2 Comm. 1 3	5,08 mm	8,13 mm	8,64 mm
<b>2</b>	DPDT  2 Comm. 5 Comm. 1 3 4 6	9,14 mm	8,13 mm	8,64 mm

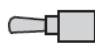

### Electrical Functions

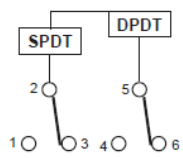
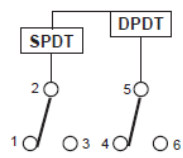
			
<b>1</b>	on	none	on
<b>2</b>	on	none	(on)
<b>3</b>	on	off	on
<b>4</b>	(on)	off	(on)
<b>5</b>	on	off	(on)
		open	

**Actuators**

**N - ROUND TOGGLE**

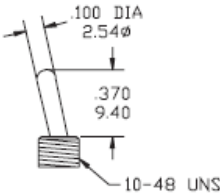

**N2 - ROUND TOGGLE**

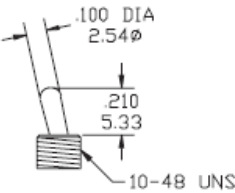

**N3 - ROUND TOGGLE**

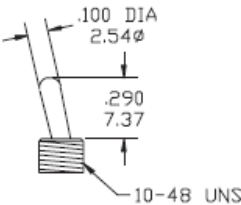

**N4 - ROUND TOGGLE**

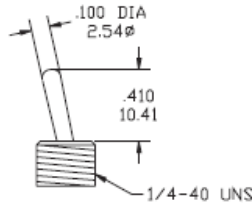

**N5 - ROUND TOGGLE**

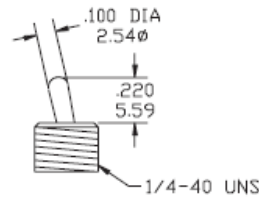

**LK - LOCKING LEVER**

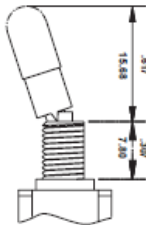

**LK1 - LOCKING LEVER**

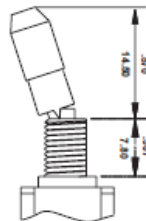

### Bushing

**F1 - THREADED**  
**F2 - UNTHREADED**

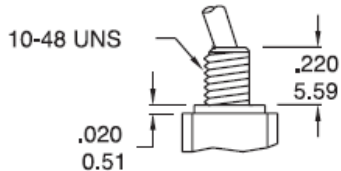

**F3 - THREADED**  
**F4 - UNTHREADED**

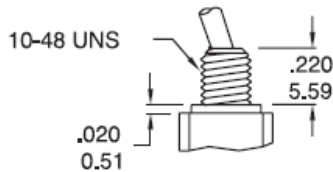
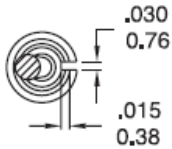

**B1 - THREADED**  
**B2 - UNTHREADED**

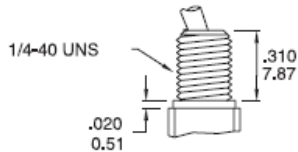
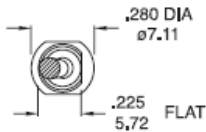

**B3 - THREADED**  
**B4 - UNTHREADED**

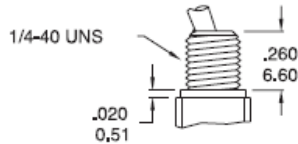
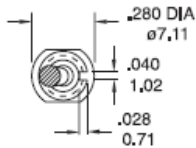

### Sealing



**E**

# Terminations

For single pole

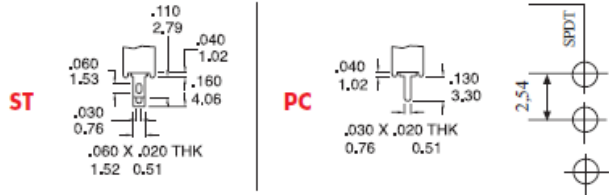

For double pole

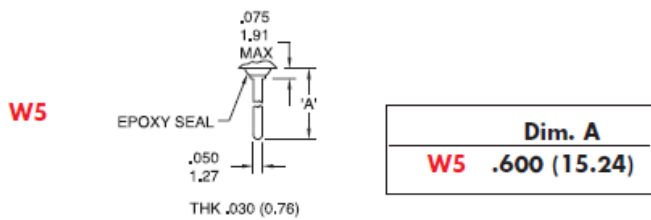
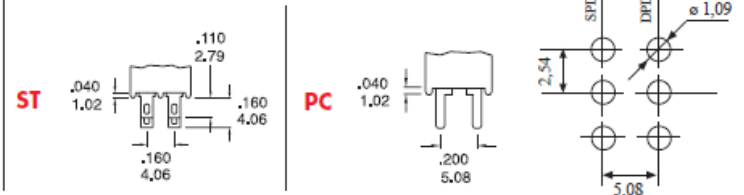

**H9**  
SPDT

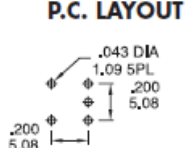
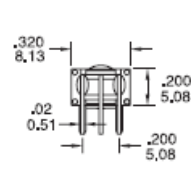
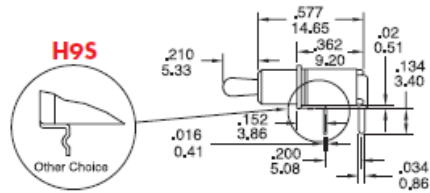
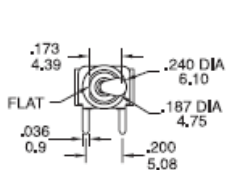

Part N° shown: 2A11-N2F2H9AE

**H9**  
DPDT

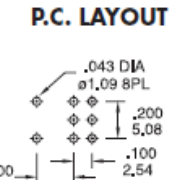
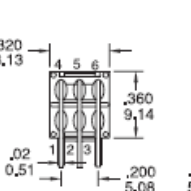
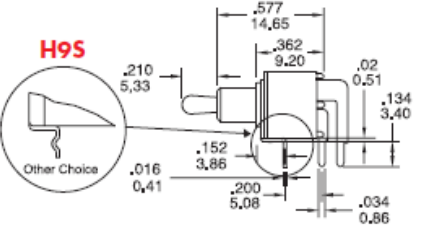
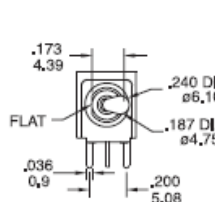

Part N° shown: 2A21-N2F2H9AE

**V9**  
SPDT

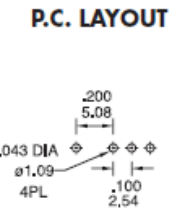
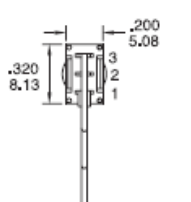
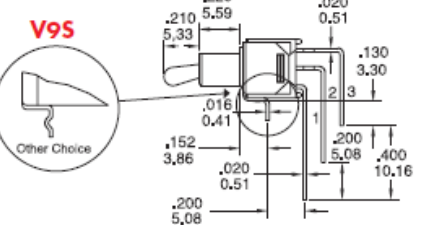
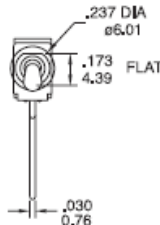

Part N° shown: 2A11-N2F2V9AE

**V9**  
DPDT

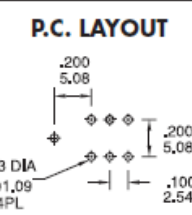
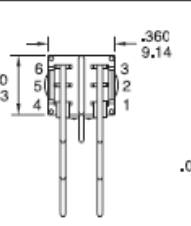
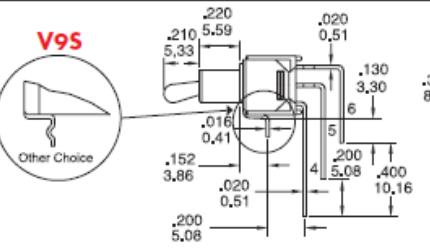
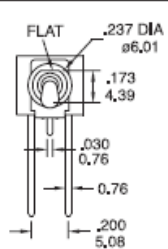

Part N° shown: 2A21-N2F2V9AE

## Terminations

**U2**  
**SPDT**

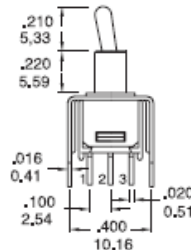
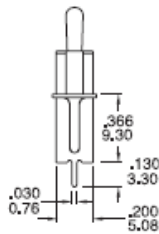

**P.C. LAYOUT**

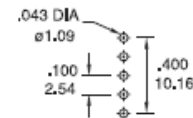

**Part N° shown: 2A11-N2F2U2AE**

**U2**  
**DPDT**

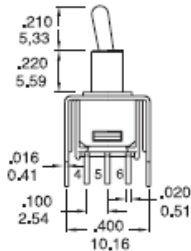
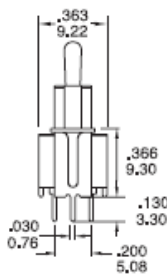

**P.C. LAYOUT**

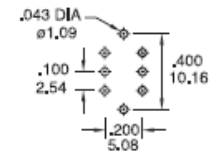

**Part N° shown: 2A21-N2F2U2AE**

## Contact Materials – Contact Ratings

- S** **Moving Contacts:** coin silver, silver plated  
**Terminals:** brass, silver plated  
**Rating:** 3 Amps @ 120 VAC or 28 VDC  
1.5 Amps @ 250 VAC
- A** **Moving Contacts:** brass with gold plate over nickel plate  
**Terminals:** brass with gold plate over nickel plate  
**Rating:** 0.4 Volts/Amps max @ 20 VAC or DC max
- G** **Moving Contacts:** coin silver gold plated  
**Terminals:** brass silver plated and gold plated  
**Note:** **G** option used for either "high" (2 Amps @ 250 VAC) or "low" (0.4 Volts/Amps max) contact rating (one exclude the other)
- K** **Moving Contacts:** copper alloy with gold plating over nickel plating  
**Terminals:** copper alloy with gold plating over nickel plating  
**Rating:** 0.4 Volts/Amps max @ 20 Volts max (AC or DC)