

## FEATURES

- A blind rivet nut is a one-piece internally threaded tubular rivet used to create highly durable threads particularly in thin materials where only one side is accessible
- The countersunk head provides a flush surface finish
- Requires a countersink in the hole preparation
- Used for multiple applications
- Zinc plated corrosion resistant finish
- Easy to install

## RS PRO COUNTERSUNK HEAD ROUND KNURLED BODY OPEN END BLIND RIVET NUT - STEEL

RS Stock No.: 2065476, 2065477, 2065478, 2065479, 2065480, 2065482, 2065483, 2065484, 2065485, 2065486, 2065487, 2065488, 2065489



## Family Name

RS Professionally Approved Products bring to you professional quality parts across all product categories. Our product range has been tested by engineers and provides a comparable quality to the leading brands without paying a premium price.

### Product Description

A blind rivet nut is a one-piece internally threaded and counterbored tubular rivet used to create highly durable threads particularly in thin materials where only one side is accessible and for further component assembly.

A blind rivet nut creates a strong thread in some of the following ways:

- thin metal sheet/profiles where no thread forming is possible
- thick metal sheet/profiles that are too hard for thread forming
- composite or plastic materials where no thread forming is possible
- use in box section or enclosed applications where there is restricted access
- clinching separate sheets together therefore acting like a blind rivet
- allows you to assemble another component with a bolt or screw
- on-site repairs to damaged or stripped threads
- 

The countersunk head is used where a flush or non-interference fit is required. The hole on installation side of the material needs to ensure the countersink is a little bit deeper than the countersunk head thickness itself. The blind rivet nut can be used in a conventional way of fixing into one piece of material or in multiple materials clamping them similarly to a blind rivet connection.

Used in white goods, electrical enclosures, indoor and outdoor electronic signs, automotive, aerospace, rail and HVAC.

### General Specifications

Thread Size mm (A)	Article Number	Grip Range Min mm (G)	Grip Range Max mm (G)	Hole Size mm	Body Diameter mm (B)	Flange Diameter mm (H)	Flange Thickness mm (T)	Body Overall Length mm (L)	Max Tightening Torque Nm	Tensile Strength N	Bag Quantity
M3	2065476	1.5	2.5	5.0	4.9	7.5	1.5	9.5	1.0	3900	100
	2065477	2.5	4.0					10.5			100
M4	2065478	1.5	3.0	6.0	5.9	8.5		12.0	3.0	6800	100
	2065479	3.0	5.0					13.0			100
M5	2065480	2.0	3.5	7.0	6.9	10.0		13.0	6.0	10000	100
	2065482	2.0	3.5					15.0			100
M6	2065483	1.5	4.0	9.0	8.9	12.0		15.5	10.0	15000	100
	2065484	4.0	6.0					17.0			100
M8	2065485	2.0	4.5	11.0	10.9	14.0		18.5	24.0	27000	50
	2065486	4.5	6.0					19.0			50
M10	2065487	2.0	5.0	13.0	12.9	16.0	21.0	32.0	28500	50	
	2065488	3.5	6.5				24.0			50	
M12	2065489	2.0	5.0	16.0	15.9	19.0	1.9	24.0	44.0	48000	50

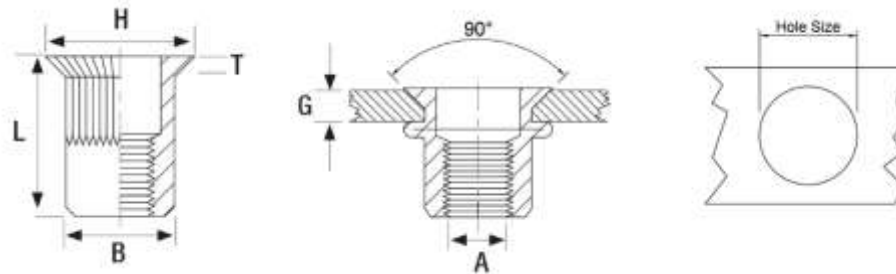

## TECHNICAL DATA

### HOW TO MEASURE A BLIND RIVET NUT

**Flat Head** - the rivet nut body length (L) is always measured overall.

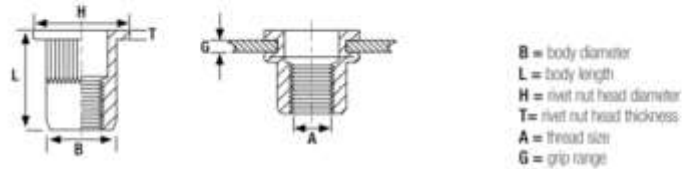

**Countersunk Head or Reduced Head** - the rivet body length (L) is always measured from the top of the head to the end of the body.

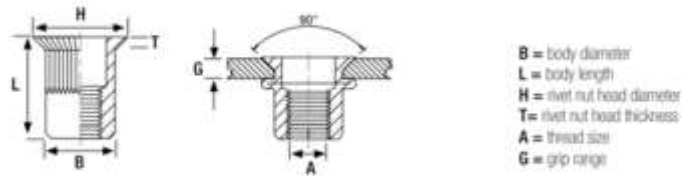

### HOW TO INSTALL A BLIND RIVET NUT

Blind rivet nuts have a simple and rapid installation.

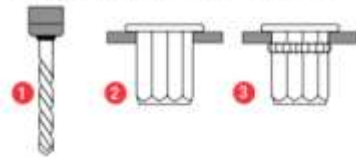

- 1 Firstly drill the hole.
- 2 To set the nut, screw it onto the threaded mandrel of the setting tool, and insert into the component hole.  
The nut is then set through the stroke of the setting tool pulling it up onto the material. This causes the collapsible part of the nut to form on the rear of the material or blindside.
- 3 After the threaded mandrel of the setting tool is removed, the rivet nut thread is left ready for use.