

FEATURES

- Single handed operation
- Light and compact
- Safety version
- Silicon free

RS PRO FEMALE PLUG - EUROPEAN PROFILE – 7.8 mm

RS Stock No.: 2312516



RS PROfessionally Approved Products bring to you professional quality parts across all product categories. Our product range has been tested by engineers and provides a comparable quality to the leading brands without paying a premium price.

Product Description

The RS PRO female plug - European profile – 7.8 mm works in 0 to 16 bar pressure range. It mainly used in compressed air & tools, pneumatic & fluid technology, food & beverages. It is available in nickel-plated brass. Used for compressed air and for moulding injection cooling system. RoHS and REACH compliant. Operating temperature range is from - 20 °C to + 80 °C.

General Specifications

Material	Nickel Plated Brass
Applications	Lubrication System, Cooling System, Pneumatic Machinery Equipment

Mechanical Specifications

Connection Type	Connection Type
Tube Connection Size	11
Coupling Gender	Female
Threaded Connection	1/4 in Female
Thread Size	1/4in
Wrench Size	17Hex
Length	33mm

Similar Products

Parameters	2312515
Brand	RS PRO
Wrench Size	9
Length	11.5mm
Tube Connection Size	33.5mm
Thread Size	3/8in

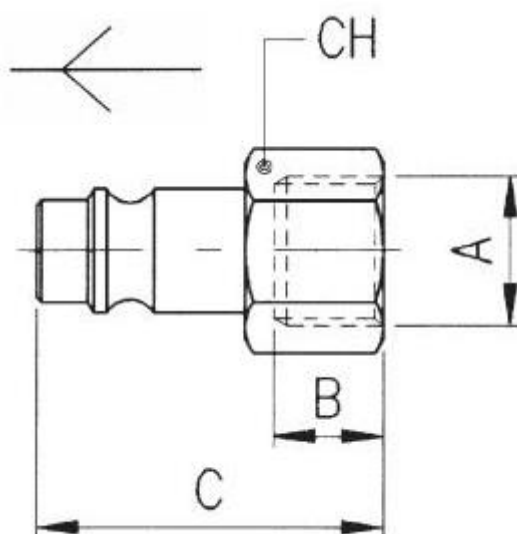

A	B	C	CH	Pack.
1/4	11	33	17	10