

Datasheet

Clear Filament Indicator Lamp

RS Stock number [339-3440](#)

Dimensions: (mm)

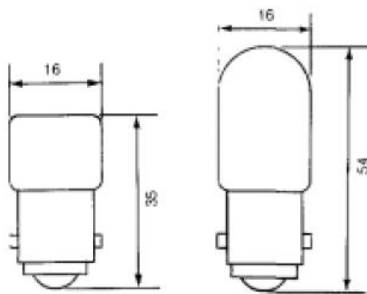

RERATED M.S.C.P. = $\left(\frac{V}{V_i}\right)^{3.5}$ M.S.C.P. AT DESIGN VOLTS
 RERATED LIFE = $\left(\frac{V_i}{V}\right)^{12}$ LIFE AT DESIGN VOLTS
 RERATED CURRENT = $\left(\frac{V}{V_i}\right)^{.55}$
 V = APPLICATION VOLTAGE
 V_i = DESIGN VOLTAGE

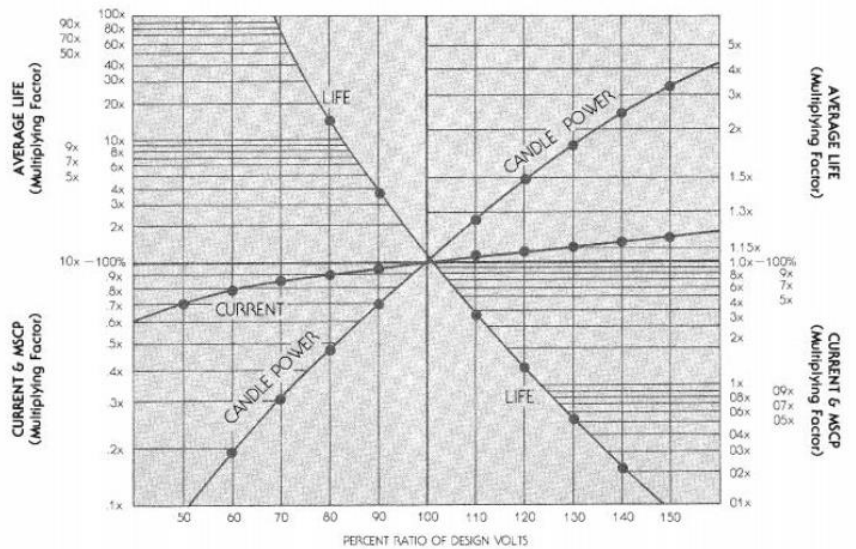

Specifications

- Life: Average life hours are based on rated voltage, 6 cycle alternating current in a room temperature ambient environment, under static conditions.
- Converting Brightness: Mean Spherical Candle Power (MSCP) is convertible to lumens, its metric equivalent, by a factor of 4π. That is MSCP x 4π (approx. 12.6) = lumens.