

Datasheet

# Thermocouple Spade Terminals - Crimp-on spade terminations in Thermocouple Types 'K' & 'J'

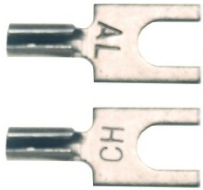

Thermocouple Type 'K' CH/AL

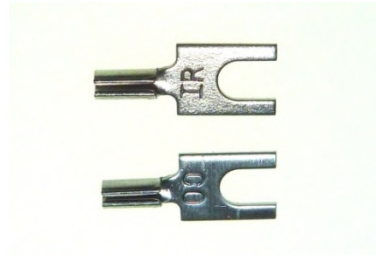

Thermocouple Type 'J' IR/CO

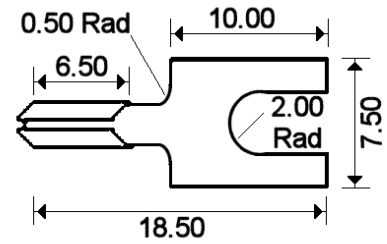

Thermocouple Spade Terminal

- Made from thermocouple material for Types 'K' or 'J'
- Code letters stamped on each termination to ensure correct thermocouple alloy type
- Crimp-on – for wires up to 18awg
- Supplied in packs of 20 pairs

| T/C Type | +Positive Contact (alloy type) | Negative Contact (alloy type) | Allied Code | RS order Code   |
|----------|--------------------------------|-------------------------------|-------------|-----------------|
| K        | +Nickel Chromium (CH)          | -Nickel Alloy (AL)            | 70641751    | <b>236-4160</b> |
| J        | +Iron (IR)                     | -Copper Nickel (CO)           | 70641752    | <b>236-4182</b> |

Optional Barrier Terminal Blocks:



Thermocouple Type 'K'



Thermocouple Type 'J'

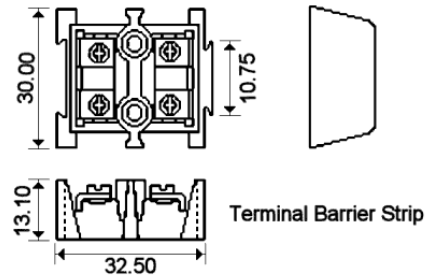

Terminal Barrier Strip

- Interlocking barrier terminal blocks
- Blocks supplied singularly with end caps allowing a multiple number of blocks to be joined together
- Thermocouple Types 'K' or 'J'
- Connections made from thermocouple material
- Colour coded to IEC-584
- Max temperature 220°C

| Type | Allied Code | RS order Code   |
|------|-------------|-----------------|
| K    | 70641754    | <b>236-4205</b> |
| J    | 70641753    | <b>236-4198</b> |