

FEATURES

- Comes in black colour
- Low density polyethylene (LDPE) construction
- High strength cable cleats
- Corrosion resistance
- Impact resistant

RS PRO Cable Clip Black Screw PE Cable Clip, 12.7mm Max. Bundle

RS Stock No.: 184-5214



RS Professionally Approved Products bring to you professional quality parts across all product categories. Our product range has been tested by engineers and provides a comparable quality to the leading brands without paying a premium price.

Product Description

RS PRO single hole heavy duty cable cleats which are manufactured from LDPE (low density polythene) which has high strength and impact resistance. The material is also resistant to corrosion and UV light. These cable cleats are ideal for clamping and tying armoured and unarmoured cables.

Options available with various maximum diameters:

[184-4609](#) - 10.0 mm

[184-5214](#) - 12.7 mm

[184-4615](#) - 15.2 mm

[184-5220](#) - 17.8 mm

[184-4621](#) - 20.3 mm

[184-4637](#) - 22.8 mm

[184-4643](#) - 25.4 mm

General Specifications

| | |
|-------------------------------|---|
| Material | PE(polyethylene) |
| Colour | Black |
| Affixing Method | Screw. |
| Cable Clip/Clamp Style | Cable Clip |
| Packing | 50pcs. |
| UV-Resistant | Yes |
| Applications | They are widely used in both home and workplace settings, and places where you are likely to find lengths of wire running between components outside of a cabinet or other housing. |

Mechanical Specifications

| | |
|--------------------------------|---------------|
| Dimensions | 17.5mm x 28mm |
| Width | 17.5mm |
| Depth | 28mm |
| Maximum Bundle Diameter | 12.7mm |
| Clearance | 6mm |

Operation Environment Specifications

| | |
|---------------------|-------|
| Maximum Temperature | -30°C |
| Minimum Temperature | +60°C |



- MS4 = RS 184-4609
- MS5 = RS 184-5214
- MS6 = RS 184-4615
- MS7 = RS 184-5220
- MS8 = RS 184-4621
- MS9 = RS 184-4637
- MS10 = RS 184-4643

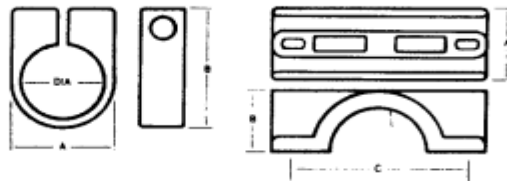

Dimensional Data

| Reference Numbers | Dimensions | | | |
|-------------------------------|------------------|-------------------|------------------------------|----------------------------------|
| | Width A mm | Height B mm | Fixing Centres C mm | Clearance Bolt Holes mm |
| Standard Polypropylene | | | | |
| MS 5 | 17.5 | 28.0 | N/A | 6 |
| MS 6 | 20.0 | 31.0 | N/A | 6 |
| MS 7 | 23.0 | 34.0 | N/A | 6 |
| MS 8 | 25.0 | 38.0 | N/A | 6 |
| MS 9 | 28.5 | 41.0 | N/A | 6 |
| MS 10 | 30.0 | 43.5 | N/A | 6 |