



Datasheet

Non-Insulated Pin Terminals

RS Stock No:809-2366



A.W.G.	26	24	22	20	18	16	14	12	10	8	6	4	2	1/0	2/0	3/0
AMP.	5.5	7	9	12	17	18	30	35	50	70	95	125	170	230	265	310

Terminal Material:
Copper

Maximum Electric Current:



Dimensions:

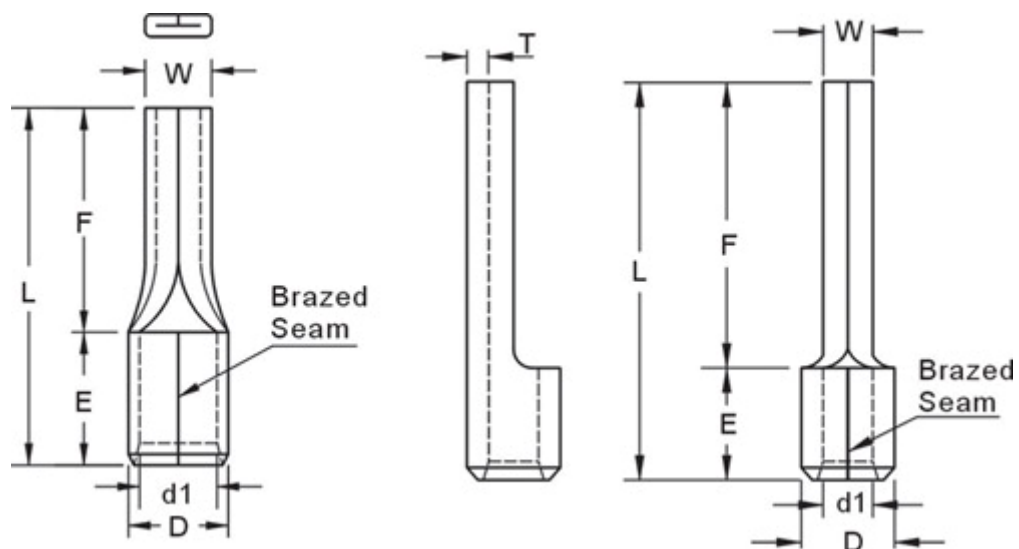

WIRE RANGE A.W.G. mm ²	ITEM NO.	DIMENSION (mm)						
		W	F	L	E	D	d1	T
22-16 A.W.G. 0.5-1.5 mm ²	809-2341	1.9	9.0	13.8	4.8	3.4	1.7	0.75
16-14 A.W.G. 1.5-2.5 mm ²	809-2350	1.9	9.0	13.8	4.8	4.1	2.3	0.8
12-10 A.W.G. 2.5-6 mm ²	809-2353	2.8	10.0	17.0	6.0	5.6	3.4	1.0
8 A.W.G. 10 mm ²	809-2357	4.3	14.0	22.0	8.0	6.9	4.5	1.1
6 A.W.G. 16 mm ²	809-2366	5.5	16.0	26.0	10.0	8.4	5.8	1.2



rspro.com

