

Datasheet

15 Tooth Pilot Sprocket

RS Stock number 183-423

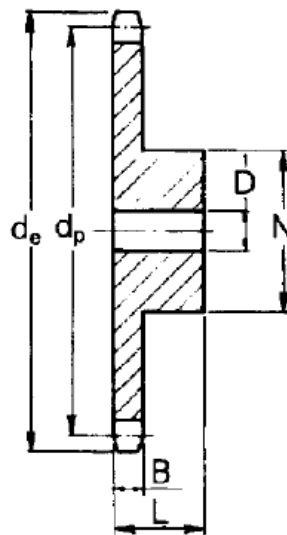

Type 1

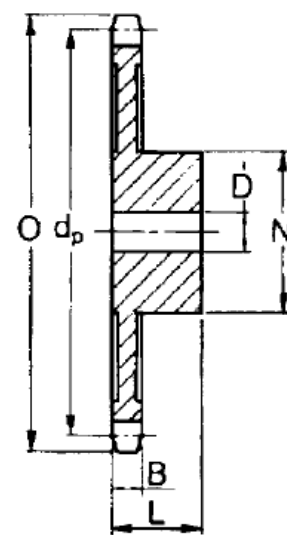

Type 4

Description:

British Standard Pilot Bored Sprockets

Manufactured to BS228/13 from steel with black passivated finish
Easily re-bored as required

Specifications:

Bore Type:	Pilot
Material:	Steel
Maximum Bore Diameter:	12mm
Number of Teeth:	15
Pitch Diameter:	45.81mm
Pulley Width:	35mm
To fit British Standard Chain Type:	08B-1



ENGLISH

SIMPLEX

06B1 3/8" Pitch 9,5mm

Catalogue Code 027A01--

Teeth	Outer Diameter O	Pitch Diameter d_p	Hub Diameter N	Length through Bore L	Plate Thickness B_e	Stock Bore D	Max Bore	Type
8	28,00	24,89	15,00*	22	5,3	6	6	1
9	31,00	27,85	18,00*	22	5,3	8	8	1
10	34,00	30,82	20,00	22	5,3	8	8	1
11	37,00	33,80	22,00	25	5,3	8	8	1
12	40,00	36,80	25,00	25	5,3	8	10	1
13	43,00	39,79	28,00	25	5,3	10	12	1
14	46,30	42,80	31,00	25	5,3	10	15	1
15	49,30	45,81	34,00	25	5,3	10	18	1
16	52,30	48,82	37,00	28	5,3	10	20	1
17	55,30	51,83	40,00	28	5,3	10	23	1
18	58,30	54,85	43,00	28	5,3	10	26	1
19	61,30	57,87	45,00	28	5,3	10	28	1
20	64,30	60,89	46,00	28	5,3	10	28	1
21	68,00	63,91	48,00	28	5,3	12	30	1
22	71,00	66,93	50,00	28	5,3	12	35	1
23	73,50	69,96	52,00	28	5,3	12	35	1
24	77,00	72,97	54,00	28	5,3	12	36	1
25	80,00	76,00	57,00	28	5,3	12	40	1
26	83,00	79,02	60,00	28	5,3	12	40	1
27	86,00	82,05	60,00	28	5,3	12	40	1
28	89,00	85,07	60,00	28	5,3	12	40	1
29	92,00	88,09	60,00	28	5,3	12	40	1
30	94,70	91,12	60,00	28	5,3	12	40	1
31	98,30	94,15	65,00	30	5,3	14	43	1
32	101,30	97,17	65,00	30	5,3	14	43	1
33	104,30	100,20	65,00	30	5,3	14	43	1
34	107,30	103,23	65,00	30	5,3	14	43	1
35	110,40	106,26	65,00	30	5,3	14	43	1
36	113,40	109,29	70,00	30	5,3	16	48	1
37	116,40	112,32	70,00	30	5,3	16	48	1
38	119,50	115,35	70,00	30	5,3	16	48	1
39	122,50	118,37	70,00	30	5,3	16	48	1
40	125,50	121,40	70,00	30	5,3	16	48	1
38†	119,50	115,35	70,00	32	5,3	19	40	4
45	140,70	136,55	70,00	32	5,3	19	40	4
57	176,90	172,91	70,00	32	5,3	19	40	4
76	234,50	230,49	70,00	32	5,3	19	50	4
95	292,50	288,08	80,00	40	5,3	19	55	4

08B1 ½" Pitch 12,7mm Catalogue Code 027B01--

Teeth	Outer Diameter O	Pitch Diameter d_p	Hub Diameter N	Length through Bore L	Plate Thickness B	Stock Bore D	Max Bore	Type
8	37.20	33.18	20.00*	25	7.2	10	10	1
9	41.00	37.13	24.00*	25	7.2	10	10	1
10	45.20	41.10	28.00	25	7.2	10	11	1
11	48.70	45.07	29.00	25	7.2	10	13	1
12	53.00	49.07	33.00	28	7.2	10	17	1
13	57.40	53.06	37.00	28	7.2	10	20	1
14	61.80	57.07	41.00	28	7.2	10	24	1
15	65.50	61.09	45.00	28	7.2	10	28	1
16	69.50	65.10	50.00	28	7.2	12	30	1
17	73.60	69.11	52.00	28	7.2	12	30	1
18	77.80	73.14	56.00	28	7.2	12	35	1
19	81.70	77.16	60.00	28	7.2	12	40	1
20	85.80	81.19	64.00	28	7.2	12	40	1
21	89.70	85.22	68.00	28	7.2	14	40	1
22	93.80	89.24	70.00	28	7.2	14	40	1
23	98.20	93.27	70.00	28	7.2	14	40	1
24	101.80	97.29	70.00	28	7.2	14	40	1
25	105.80	101.33	70.00	28	7.2	14	40	1
26	110.00	105.36	70.00	30	7.2	15	46	1
27	114.00	109.40	70.00	30	7.2	15	46	1
28	118.00	113.42	70.00	30	7.2	15	46	1
29	122.00	117.46	80.00	30	7.2	15	46	1
30	126.10	121.50	80.00	30	7.2	15	46	1
31	130.20	125.54	90.00	30	7.2	16	46	1
32	134.30	129.56	90.00	30	7.2	16	46	1
33	138.40	133.60	90.00	30	7.2	16	46	1
34	142.60	137.64	90.00	30	7.2	16	46	1
35	146.70	141.68	90.00	30	7.2	16	46	1
36	151.00	145.72	90.00	35	7.2	20	50	1
37	154.60	149.76	90.00	35	7.2	20	50	1
38	158.60	153.80	90.00	35	7.2	20	50	1
39	162.70	157.83	90.00	35	7.2	20	50	1
40	166.80	161.87	90.00	35	7.2	20	50	1
38†	158.60	153.80	70.00	40	7.2	19	50	4
45	188.00	182.07	70.00	40	7.2	19	50	4
57	236.40	230.54	70.00	40	7.2	19	50	4
78	313.30	307.33	80.00	40	7.2	23	50	4
95	390.10	384.11	80.00	45	7.2	23	55	4

* Has recessed groove in hub for chain clearance.

To complete Catalogue Code insert number of teeth required.

† For Type 4, 38 tooth sprockets, designate with ninth digit 0.



10B1 5/8" Pitch

Catalogue Code 027C01--

Teeth	Outer Diameter O	Pitch Diameter d _p	Hub Diameter N	Length through Bore L	Plate Thickness B	Stock Bore D	Max Bore	Type
8	47,00	41,48	25,00*	25	9,1	10	11	1
9	52,60	46,42	30,00*	25	9,1	10	15	1
10	57,50	51,37	35,00*	25	9,1	10	18	1
11	63,00	56,34	37,00	28	9,1	12	21	1
12	68,00	61,34	42,00	28	9,1	12	25	1
13	73,00	66,32	47,00	28	9,1	12	28	1
14	78,00	71,34	52,00	28	9,1	12	32	1
15	83,00	76,36	57,00	28	9,1	12	35	1
16	88,00	81,37	60,00	30	9,1	14	40	1
17	93,00	86,39	60,00	30	9,1	14	40	1
18	98,30	91,42	70,00	30	9,1	14	50	1
19	103,30	96,45	70,00	30	9,1	14	50	1
20	108,40	101,49	75,00	30	9,1	14	50	1
21	113,40	106,52	75,00	30	9,1	16	50	1
22	118,00	111,55	80,00	30	9,1	16	50	1
23	123,40	116,58	80,00	30	9,1	16	50	1
24	128,30	121,62	80,00	30	9,1	16	50	1
25	134,00	126,66	80,00	30	9,1	16	50	1
26	139,00	131,70	85,00	35	9,1	20	55	1
27	144,00	136,75	85,00	35	9,1	20	55	1
28	148,70	141,78	90,00	35	9,1	20	55	1
29	153,80	146,83	90,00	35	9,1	20	55	1
30	158,80	151,87	90,00	35	9,1	20	58	1
31	163,90	156,92	95,00	35	9,1	20	58	1
32	168,90	161,95	95,00	35	9,1	20	58	1
33	174,50	167,00	95,00	35	9,1	20	58	1
34	179,00	172,05	95,00	35	9,1	20	58	1
35	184,10	177,10	95,00	35	9,1	20	58	1
36	189,10	182,15	100,00	35	9,1	20	63	1
37	194,20	187,20	100,00	35	9,1	20	63	1
38	199,20	192,24	100,00	35	9,1	20	63	1
39	204,20	197,29	100,00	35	9,1	20	63	1
40	209,30	202,34	100,00	35	9,1	20	63	1
38	199,20	192,24	80,00	40	9,1	19	50	4
45	235,00	227,58	80,00	40	9,1	19	55	4
57	296,00	288,18	90,00	45	9,1	23	55	4
76	392,10	384,16	90,00	50	9,1	23	60	4
95	488,50	480,14	100,00	56	9,1	23	60	4

12B1 ¼" Pitch 19 mm Catalogue Code 027D01--

Teeth	Outer Diameter O	Pitch Diameter d _p	Hub Diameter N	Length through Bore L	Plate Thickness B	Stock Bore D	Max Bore	Type
8	57,60	49,78	31,00*	30	11,1	12	16	1
9	62,00	56,70	37,00*	30	11,1	12	20	1
10	68,00	61,64	42,00*	30	11,1	12	23	1
11	75,00	67,61	46,00	35	11,1	14	28	1
12	81,50	73,61	52,00	35	11,1	14	32	1
13	87,50	79,59	58,00	35	11,1	14	36	1
14	93,60	85,61	64,00	35	11,1	14	40	1
15	99,80	91,63	70,00	35	11,1	14	44	1
16	105,50	97,65	75,00	35	11,1	16	48	1
17	111,50	103,67	80,00	35	11,1	16	55	1
18	118,00	109,71	80,00	35	11,1	16	55	1
19	124,20	115,75	80,00	35	11,1	16	55	1
20	129,70	121,78	80,00	35	11,1	16	55	1
21	136,00	127,82	90,00	40	11,1	20	55	1
22	141,80	133,88	90,00	40	11,1	20	55	1
23	149,00	139,90	90,00	40	11,1	20	55	1
24	153,90	145,94	90,00	40	11,1	20	55	1
25	160,00	152,00	90,00	40	11,1	20	55	1
26	166,90	158,04	95,00	40	11,1	20	58	1
27	172,30	164,09	95,00	40	11,1	20	58	1
28	178,00	170,13	95,00	40	11,1	20	58	1
29	184,10	176,19	95,00	40	11,1	20	60	1
30	190,50	182,25	95,00	40	11,1	20	60	1
31	196,30	188,31	100,00	40	11,1	20	64	1
32	203,30	194,35	100,00	40	11,1	20	64	1
33	209,30	200,40	100,00	40	11,1	20	64	1
34	214,60	206,46	100,00	40	11,1	20	64	1
35	221,00	212,52	100,00	40	11,1	20	64	1
36	226,80	218,58	100,00	40	11,1	20	70	1
37	232,90	224,64	100,00	40	11,1	20	70	1
38	239,00	230,69	100,00	40	11,1	20	70	1
39	245,10	236,75	100,00	40	11,1	20	70	1
40	251,30	242,81	100,00	40	11,1	20	70	1
38†	239,00	230,69	100,00	56	11,1	23	60	4
45	282,50	273,10	100,00	56	11,1	23	60	4
57	354,00	345,81	100,00	58	11,1	29	60	4
76	469,90	460,99	100,00	58	11,1	29	60	4

* Has recessed groove in hub for chain clearance.

To complete Catalogue Code insert number of teeth required.

† For Type 4, 38 tooth sprockets, designate with ninth digit 0.



16B1 1" Pitch 25,4mm Catalogue Code 027E01--

Teeth	Outer Diameter O	Pitch Diameter d _p	Hub Diameter N	Length through Bore L	Plate Thickness B	Stock Bore D	Max Bore	Type
8	77.00	66.37	42.00*	35	16.2	16	22	1
9	85.00	74.27	50.00*	35	16.2	16	28	1
10	93.00	82.19	55.00	35	16.2	16	34	1
11	99.50	90.14	61.00	40	16.2	16	38	1
12	109.00	98.14	69.00	40	16.2	16	44	1
13	117.00	106.12	78.00	40	16.2	16	48	1
14	125.00	114.15	84.00	40	16.2	16	53	1
15	133.00	122.17	92.00	40	16.2	16	58	1
16	141.00	130.20	100.00	45	16.2	20	64	1
17	149.00	138.22	100.00	45	16.2	20	70	1
18	157.00	146.28	100.00	45	16.2	20	70	1
19	165.20	154.33	100.00	45	16.2	20	70	1
20	173.20	162.38	100.00	45	16.2	20	70	1
21	181.20	170.43	110.00	50	16.2	20	70	1
22	189.30	178.48	110.00	50	16.2	20	70	1
23	197.50	186.53	110.00	50	16.2	20	70	1
24	205.50	194.59	110.00	50	16.2	20	70	1
25	213.50	202.66	110.00	50	16.2	20	70	1
26	221.60	210.72	120.00	50	16.2	20	76	1
27	229.60	218.79	120.00	50	16.2	20	76	1
28	237.70	226.85	120.00	50	16.2	20	76	1
29	245.80	234.92	120.00	50	16.2	20	76	1
30	254.00	243.00	120.00	50	16.2	20	76	1
31	262.00	251.08	120.00	50	16.2	25	76	1
32	270.00	259.13	120.00	50	16.2	25	76	1
33	278.50	267.21	120.00	50	16.2	25	76	1
34	287.00	275.28	120.00	50	16.2	25	76	1
35	296.20	283.38	120.00	50	16.2	26	76	1
36	304.60	291.44	120.00	50	16.2	25	76	1
37	312.60	299.51	120.00	50	16.2	25	76	1
38	320.70	307.59	120.00	50	16.2	25	76	1
39	328.80	315.67	120.00	50	16.2	25	76	1
40	336.90	323.75	120.00	50	16.2	25	76	1
38†	254.00	243.00	110.00	65	16.2	29	65	4
46	320.00	307.59	110.00	65	16.2	29	65	4
57	377.00	364.13	125.00	70	16.2	29	65	4
78	474.00	461.08	125.00	70	16.2	34	75	4
95	627.00	614.65	140.00	80	16.2	34	85	4



WEIGHTS (GRAMS)

Teeth	06B	08B	10B	12B	16B
8	37	71	142	224	519
9	48	100	169	304	692
10	61	131	220	386	854
11	82	164	272	513	1140
12	105	211	372	687	1743
13	126	269	456	844	2132
14	153	326	547	1011	2480
15	184	388	647	1192	2552
16	239	460	760	1356	3209
17	280	507	805	1544	3414
18	333	584	1012	1627	3634
19	368	667	1062	1718	3865
20	392	754	1204	1809	4107
21	422	838	1249	2342	5064
22	463	916	1403	2444	5333
23	504	947	1464	2562	5613
24	547	979	1528	2664	5907
25	607	1014	1595	2781	6212
26	670	1101	1940	3060	6889
27	685	1138	2012	3187	7319

WEIGHTS (GRAMS)

Teeth	06B	08B	10B	12B	16B
28	702	1176	2220	3318	7662
29	718	1420	2298	3455	8014
30	736	1461	2378	3596	8387
31	879	1729	2601	3907	8701
32	898	1774	2687	4057	9004
33	917	1819	2776	4213	9499
34	937	1866	2867	4374	9918
35	957	1915	2961	4539	10348
36	1088	2167	3206	4709	10791
37	1090	2219	3305	4883	11247
38	1111	2272	3408	5063	11715
39	1135	2326	3512	5247	12195
40	1157	2381	3619	5436	12689
38	1159	1800	3073	5558	9898
45	1353	2180	3894	8798	12703
57	1753	2862	6048	7016	15838
76	2575	3681	6684	10323	23750
86	3089	6419	11422	-	-