

# Spur Gears 1.0MOD 20° p.a. Steel EN8, 080M40/080M46 or equivalent

All dimensions in mm

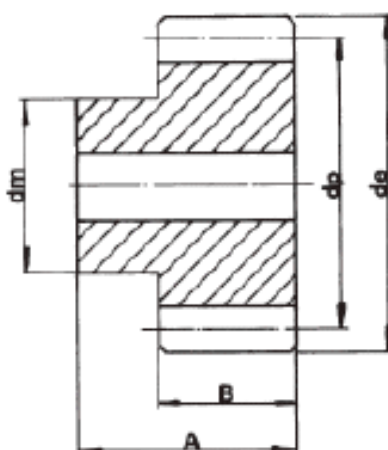

Intermediate sizes &  
Special gears to drawing up to 1000mm diameter  
Standard : DIN 3962 Grade 8/9  
Standard tolerances, unless otherwise stated  $\pm 0.25\text{mm}$ .

Code	No. of Teeth	Pitch $\varnothing$ dp	Bore $\varnothing$ H7	Hub/Boss $\varnothing$ dm	Outside $\varnothing$ de	O/A Width A	Face Width B
SS10/12B**	12	12	6	14	14	30	10
SS10/15B**	15	15	8	17	17	30	10
SS10/16B**	16	16	8	18	18	30	10
SS10/18B**	18	18	8	20	20	30	10
SS10/20B	20	20	8	16	22	20	10
SS10/22B	22	22	8	18	24	20	10
SS10/24B	24	24	8	20	26	20	10
SS10/25B	25	25	8	20	27	20	10
SS10/26B	26	26	8	22	28	20	10
SS10/28B	28	28	8	22	30	20	10
SS10/30B	30	30	10	25	32	20	10
SS10/32B	32	32	10	26	34	20	10
SS10/36B	36	36	10	28	38	20	10
SS10/40B	40	40	10	35	42	20	10
SS10/44B	44	44	10	35	46	20	10
SS10/50B	50	50	10	35	52	20	10
SS10/60B	60	60	10	35	62	20	10
SS10/80B	80	80	10	40	82	20	10

SS Gears have a black oxide finish

\*\*SS10/12B to SS10/18B are hobbed type pinions where the OD and Boss diam. are both the same diameter. These gears are hobbed for 10 mm face width and then there is cutter run-out.