

BOW SCREW PIN ANCHOR SHACKLE

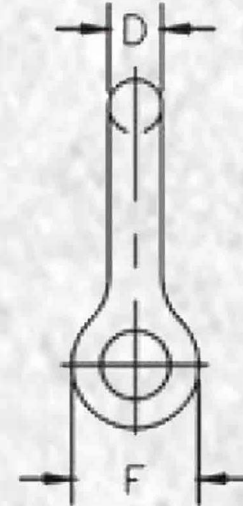

- Safe Working Load capacity from 0.5T to 55T
- Design according to US Federal specification RR-C-271C
- Safety factor 6:1
- Type IV, Class 1
- Safe Working Load embossed on every shackles.
- For 'TOYO' recognition, 'TOYO' is embossed on every shackles.
- Shackles proof loaded twice the Safe Working Load.
- Hot dipped galvanized.

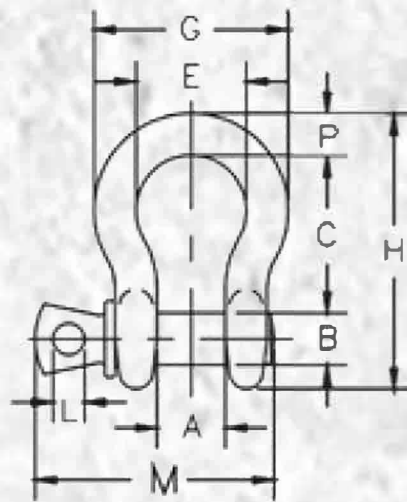

PRODUCT DESCRIPTION	Nominal size	SWL	Weight (KG)	DIMENSION (mm)											
				A +/- 2	B +/- 2	C +/- 2	D +/- 2	E +/- 2	F +/- 2	G +/- 2	H +/- 2	L +/- 2	M +/- 2	P +/- 2	
BSP0.5T	1/4	0.5T	0.05	11.9	7.85	28.7	6.35	149.8	15.5	32.5	46.7	4.85	35.1	6.35	
BSP0.75T	5/16	0.75T	0.09	13.5	9.65	31	7.85	21.3	19.1	37.3	53	5.60	42.2	7.85	
BSP1T	3/8	1T	0.14	16.8	11.2	36.6	9.65	26.2	23.1	45.2	63	6.35	51.5	9.65	
BSP1.5T	7/16	1.5T	0.17	19.1	12.7	42.9	11.2	29.5	26.9	51.5	74	7.85	60.5	11.2	
BSP2T	1/2	2T	0.33	20.6	16.0	47.8	12.7	33.3	30.2	58.5	83.5	9.65	68.5	12.7	
BSP3.25T	5/8	3.25T	0.62	26.9	19.1	60.5	16.0	42.9	38.1	74.5	106	11.2	85.0	17.5	
BSP4.75T	3/4	4.75T	1.07	31.8	22.4	71.5	19.1	51.0	46.0	89.0	126	12.7	101	20.6	
BSP6.5T	7/8	6.5T	1.64	36.6	25.4	84.0	22.4	58.0	53.0	102	148	12.7	114	24.6	
BSP8.5T	1	8.5T	2.28	42.9	28.7	95.5	25.4	68.5	60.5	119	167	14.2	129	26.9	
BSP9.5T	1-1/8	9.5T	3.36	46.0	31.8	108	29.5	74.0	68.5	131	190	16.0	142	31.8	
BSP12T	1-1/4	12T	4.31	51.5	35.1	119	32.8	82.5	76.0	165	210	17.5	156	35.1	
BSP13.5T	1-3/8	13.5T	6.14	57.0	38.1	133	36.1	92.0	84.0	162	233	19.1	174	38.1	
BSP17.5T	1-1/2	17T	7.8	60.5	41.4	146	39.1	98.5	92.0	175	254	20.6	187	41.1	
BSP25T	1-3/4	25T	12.6	73.0	51.0	178	46.7	127	106	225	313	25.4	231	57.0	
BSP35T	2	35T	20.4	82.5	57.0	197	53.0	146	122	253	348	31.0	263	61.0	
BSP55T	2-1/2	55T	38.9	105	70.0	267	69.0	184	145	327	453	35.1	330	79.5	