

# Spur Gears 1.5MOD - 20° p.a. Steel EN8, 080M40/080M46 or equivalent

All dimensions in mm

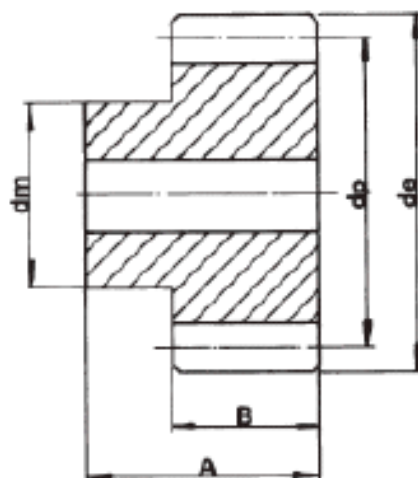

Intermediate sizes &  
Special gears to drawing up to 1000mm diameter

Standard : DIN 3962 Grade 8/9

Standard tolerances, unless otherwise stated  $\pm 0.25\text{mm}$ .

Code	No. of Teeth	Pitch $\varnothing dp$	Bore $\varnothing H7$	Hub/Boss $\varnothing dm$	Outside $\varnothing de$	O/A Width A	Face Width B
SS15/12B**	12	18	8	21	21	30	15
SS15/15B	15	22.5	8	18	25.5	25	15
SS15/16B	16	24	8	20	27	25	15
SS15/18B	18	27	8	22	30	25	15
SS15/20B	20	30	8	24	33	25	15
SS15/24B	24	36	8	28	39	25	15
SS15/30B	30	45	10	38	48	25	15
SS15/32B	32	48	10	40	51	25	15
SS15/36B	36	54	10	45	57	25	15
SS15/40B	40	60	12	45	63	25	15
SS15/44B	44	66	12	45	69	25	15
SS15/50B	50	75	12	45	78	25	15
SS15/60B	60	90	15	50	93	25	15
SS15/80B	80	120	15	60	123	25	15

SS Gears have a black oxide finish

\*\*SS15/12B is a hobbed type pinion where the OD and Boss diam. are both the same diameter.  
This gear is hobbed for 10 mm face width and then there is cutter run-out.