

FEATURES

- Thermoplastic body and brass female insert
- High tensile strength yet light in weight
- Low shank height for space-restricted applications

RS PRO Black Knurled Clamping Knob, M4

RS Stock No.: 631-9085



RS Professionally Approved Products bring to you professional quality parts across all product categories. Our product range has been tested by engineers and provides a comparable quality to the leading brands without paying a premium price.

Product Description

Knobs are used in a wide variety of applications in our day-to-day lives and perform many functions, from being used as fixed handles to being used to tighten, loosen, adjust, clamp and push other components or pieces of equipment. They are used in various applications, from industrial and construction machinery to audio and visual equipment.

Female thumbscrew knobs: M4 (RS [6319085](#)), M5 (RS [6319108](#)), M6 (RS [6319091](#)).

General Specifications

Thread	M4
Knob Shape	Knurled
Mounting Type	Threaded Hole
Body Material	High impact resistant thermoplastic
Insert Material	Brass
Colour	Black
Finish	matt
Application	Industrial machinery, Electronics enclosures, Lighting equipment, Audio equipment, Office and domestic furniture

Mechanical Specifications

Thread Diameter	4mm
Knob Diameter	15mm

Approvals

Compliance/Certifications	EN61340
----------------------------------	---------

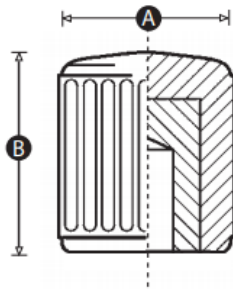

Part No.	A	B	Thread size
6319085	15	16	M4
6319108	20	22	M5
6319091	25	34	M6