

FEATURES

- 1/4" mini jack
- 3 Pole jack plug for stereo applications
- Nickel plated contact
- Moulded strain relief
- Easy to terminate

RS PRO 6.35 mm Cable Mount Stereo Jack Plug, 3Pole

RS Stock No.: 392-665



RS Professionally Approved Products bring to you professional quality parts across all product categories. Our product range has been tested by engineers and provides a comparable quality to the leading brands without paying a premium price.

Product Description

From RS PRO, this 3 pole stereo jack plug offers an economic and reliable solution for audio applications. The phono connector is easy to terminate and has a plastic cap for insulation. It also features a moulded cable sleeve to protect against potential damage caused by tugging and pulling of the cable. The unique hexagonal shape of the jack connector casing means it is easier to grip, which is ideal for plugging and unplugging in difficult to access areas. This insulated jack plug has solder tab termination, and a nickel plated contact for a cost-effective audio connection solution.

[392-609](#) is an Insulated Commercial Grade Mono 1/4" Jack Plug

[392-637](#) is an Insulated Commercial Grade Mono 1/4" Jack Socket

[392-665](#) is an Insulated Commercial Grade Stereo 1/4" Jack Plug

[392-598](#) is an Insulated Commercial Grade Stereo 1/4" Jack Socket

[392-605](#) is a Screened Commercial Grade Mono 1/4" Jack Plug

General Specifications

Type	Stereo
Gender	Male
Mounting Type	Cable Mount
Contact Plating	Nickel
Colour	Black
Contact Material	Brass
No of Poles/Way	3
Application	Used in both domestic and commercial sound systems, where a custom audio set-up is required. They are frequently used to connect electronic instruments to amplifiers.

Mechanical Specifications

Size	6.35mm
Body Orientation	Straight
Termination Method	Solder
Housing Material	PE

Approvals

Compliance/Certifications	2011/65/EU and 2015/863
----------------------------------	-------------------------



Dimensions(mm):

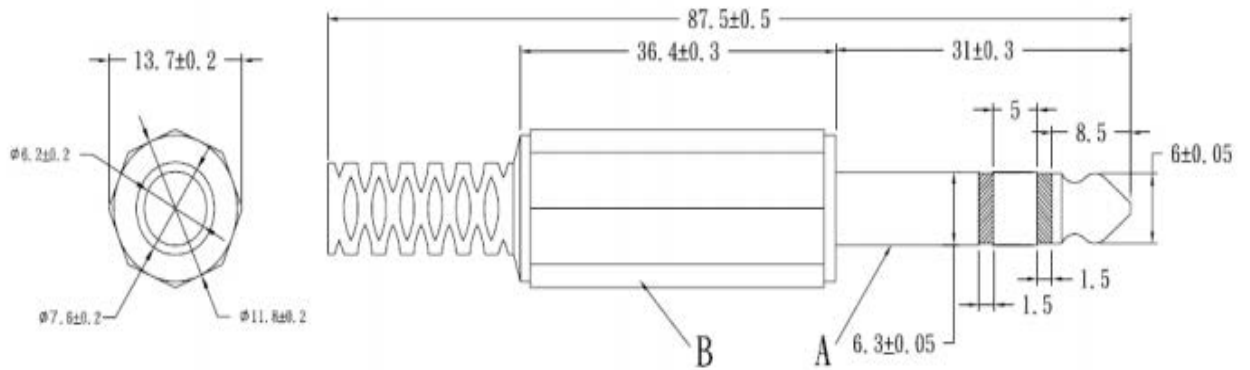

No.	Description	Unit	Material	Finish/Colour
A	6.3SP	1	Brass	NI
B	Plastic Cap	1	PE	B