

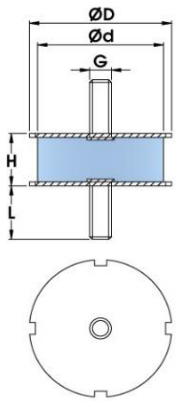

ENGLISH

Compacter Mounts

These mounts are ideal for use where equipment is subjected to high torsion and shear stress during operation. Typical applications include use in compactors, vibratory plates etc.



KBRA Mount

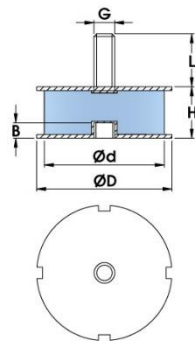

KBRB Mount

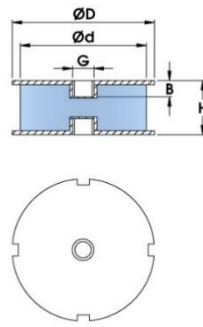

KBRC Mount

H = Height
 D = Diameter
 G = Tread
 L = Stud Length

RS Code	Item Code	Description	Metal	D (mm)	H (mm)	GxL (mm)	Max Compression Load (kg)	Max Deflection (mm)
1712657	KBRA10540M1641-1.5	Compactor Cyl Mtg (M/M) 105x40 M16x41 50 ShA	Mild Steel	105	40	M16x4 1	355	95.1
1712658	KBRA10555M16253-6-1.5	Compactor Cyl Mtg (M/M) 105x55 M16x41 50 ShA	Mild Steel	105	55	M16x4 1	215.5	63.4

1712659	KBRB10540M1616-1.55	Compactor Cyl Mtg (M/F) 105x40 M16/M16x16mm 55 ShA	Mild Steel	105	40	M16x1 6	272	48
1712660	KBRC10555M16-1.5	Compactor Cyl Mtg Female/Female M16 50 shore A	Mild Steel	105	55	M16	215.5	63.4