

Datasheet

Clear Filament Indicator Lamp

RS Stock number [339-3412](#)

Dimensions: (mm)

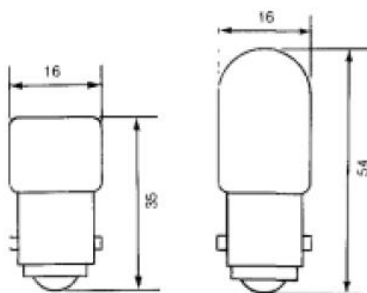

RERATED M.S.C.P. = $\left(\frac{V}{V_1}\right)^{3.5}$ M.S.C.P. AT DESIGN VOLTS

RERATED LIFE = $\left(\frac{V}{V_1}\right)^{12}$ LIFE AT DESIGN VOLTS

RERATED CURRENT = $\left(\frac{V}{V_1}\right)^{.55}$

V = APPLICATION VOLTAGE
 V₁ = DESIGN VOLTAGE

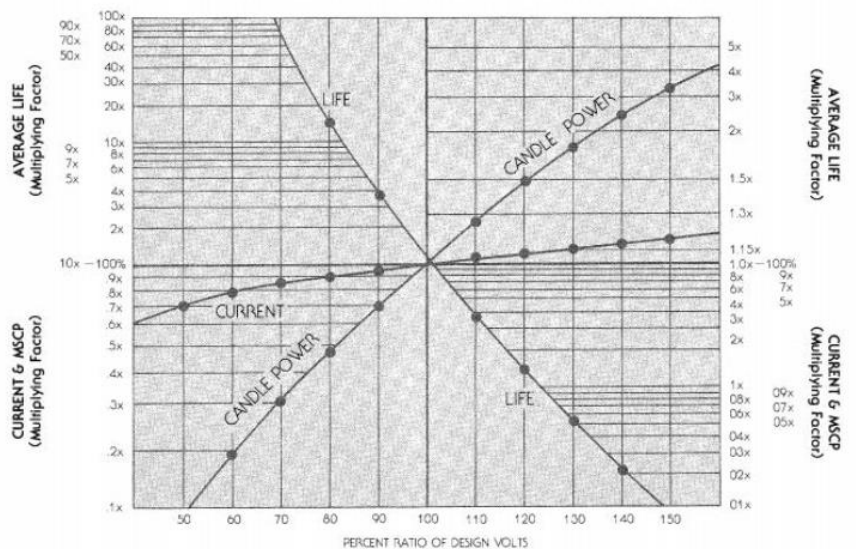

Specifications

- Life: Average life hours are based on rated voltage, 6 cycle alternating current in a room temperature ambient environment, under static conditions.
- Converting Brightness: Mean Spherical Candle Power (MSCP) is convertible to lumens, its metric equivalent, by a factor of 4π. That is MSCP x 4π (approx. 12.6) = lumens.