

FEATURES

- Dial caliper
- Made of hardened stainless steel with a satin chrome finish
- Features a depth rod to
- Storage box included
- Four-way measurement capability
- Capacity of 150 mm
- Metric units
- Analogue display
- Accuracy of ± 0.03 mm
- Resolution of 0.02mm
- Outside
- Inside
- Step
- Depth
- White dial face

RS PRO 150mm Dial Caliper 0.02 mm, Metric

RS Stock No.: 725-5698

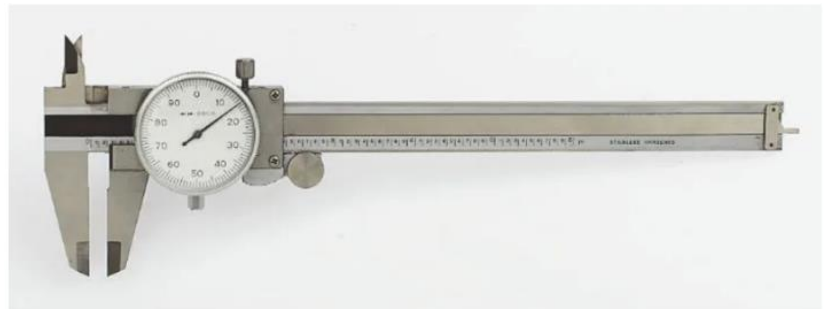

RS Professionally Approved Products bring to you professional quality parts across all product categories. Our product range has been tested by engineers and provides a comparable quality to the leading brands without paying a premium price.

Product Description

Use this stainless steel dial caliper when you need to obtain extremely accurate measurements of objects, distances or gaps. With an additional rotating dial mounted on its main graduated measuring scale, this caliper can record fractions of a millimetre for an extra level of precision.

By adjusting the jaws with a thumb roll, you can use this caliper to obtain measurements quickly. It features knurled lockscrews to lock the jaws in place. The white face of the caliper's dial makes the fractional measurements easy to read, even in low light. Its analogue display makes it a low-maintenance alternative to a digital caliper, and it also features a depth rod to provide four-way measurement capabilities. A storage box is included to keep your precision instrument safe and dry in transit or when it's not in use.

General Specifications

Caliper Type	Dial
Imperial Or Metric	Metric
Display Type	Analogue
Accuracy	±0.03mm
Resolution	0.02mm
Style Of Caliper	Standard
Depth Rod Type	Flat
Thumb Roller	Yes
Applications	Machining and workshop environments and is ideal for woodworking applications

Mechanical Specifications

Capacity	150mm
External Jaw Length	40mm
Internal Jaw Length	18mm
Metric Grads	0.02mm
Accuracy External Jaws	±0.04mm
Accuracy Internal Jaws & Depth Rod	±0.04mm

Code	Range	Metric Grads	Inch Grads	Accuracy External Jaws	Accuracy Internal Jaws & Depth Rod	External Jaw Length	Internal Jaw Length
725-5698	150mm	0.02mm	N/A	±0.02mm	±0.04mm	40mm	18mm

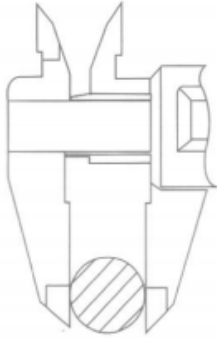

Outside Measurement

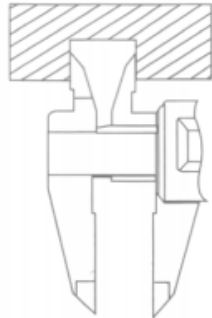

Inside Measurement



Step Measurement

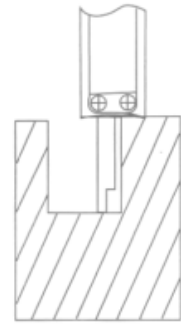

Depth Measurement