

Datasheet

Nickel Plated Brass Manual Ball Valve, 3/4 in BSP Threaded, 25bar

RS Stock number **486-287**

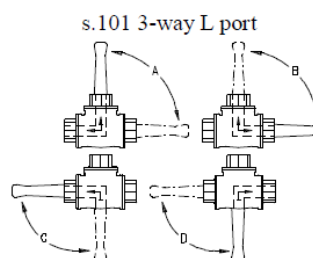
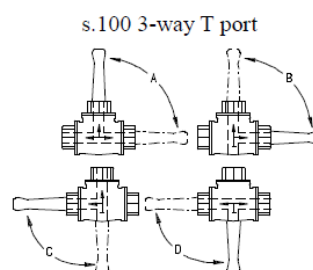

Features and Specifications:

- * 3-way T (s.100) or L (s.101) design allows complete range of flow handling applications,
- * **Hot forged** sand blasted nickel plated brass body and caps,
- * Copper alloy brass according to EN 12165 and EN 12164 specifications,
- * **Extra port** for lowest pressure drop,
- * **Teflon®** (Dupont registered trademark) seats,
- * **UNI 8858** cycle and torque tests performed,
- * **Four seats** design limits mixture among various fluids in the system,
- * Chrome plated brass ball for **longer life**,
- * **No metal-to-metal** moving parts,
- * Two Viton O-rings at the stem for **maximum safety**,
- * **ISO 228** Female threads,
- * 25 bar (Kg/cm²) non-shock cold working pressure,
- * -10°C +120°C **temperature** (Warning: freezing of the fluid in the installation may severely damage the valve).

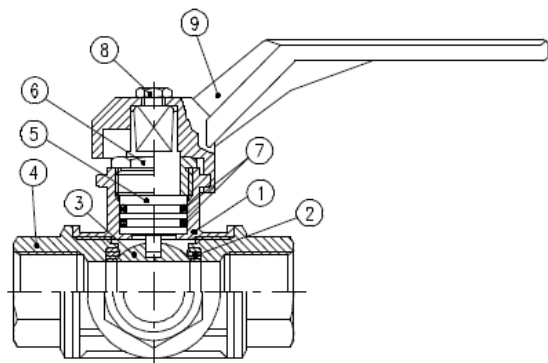

| PART DESCRIPTION | | Material | Q.ty |
|------------------|----------------------------------|-----------|------|
| 1 | Nickel plated body | CW617N | 1 |
| 2 | Seat | Ptfe | 4 |
| 3 | Chrome plated ball | CW617N | 1 |
| 4 | Nickel plated end cap | CW617N | 3 |
| 5 | Nickel plated stem O-Ring design | CW614N | 1 |
| 6 | Nickel plated nut | CW614N | 1 |
| 7 | O-Ring | Viton | 2 |
| 8 | Screw | Steel | 1 |
| 9 | Red handle | Aluminium | 1 |

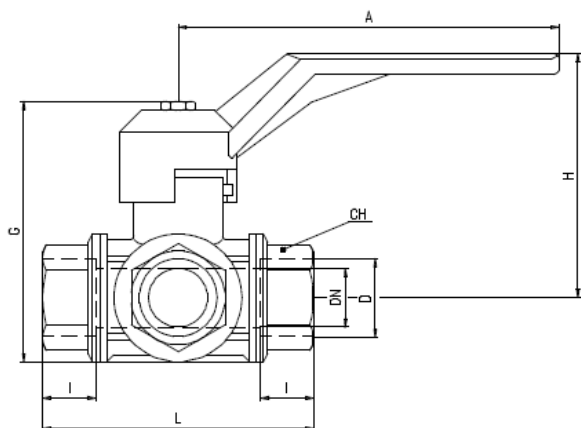

| Code | 100B00 | 100C00 | 100D00 | 100E00 | 100F00 | 100G00 | 100H00 | 100I00 |
|----------|--------|--------|--------|--------|--------|--------|--------|--------|
| | 101B00 | 101C00 | 101D00 | 101E00 | 101F00 | 101G00 | 101H00 | 101I00 |
| D (inch) | 1/4 | 3/8 | 1/2 | 3/4 | 1 | 1 1/4 | 1 1/2 | 2 |
| DN (mm) | 10 | 12 | 14 | 18 | 23 | 29 | 36 | 45 |
| I (mm) | 19 | 19 | 19 | 23 | 25 | 27 | 31 | 36 |
| L (mm) | 77 | 77 | 77 | 92 | 104 | 118 | 138 | 162 |
| G (mm) | 75 | 75 | 75 | 91 | 105 | 115 | 128 | 165 |
| A (mm) | 125 | 125 | 125 | 145 | 170 | 170 | 170 | 260 |
| H (mm) | 65 | 65 | 65 | 83 | 96 | 102 | 109 | 139 |
| CH (mm) | 22 | 22 | 22 | 27 | 34 | 50 | 57 | 70 |

Pressure -Temperature chart

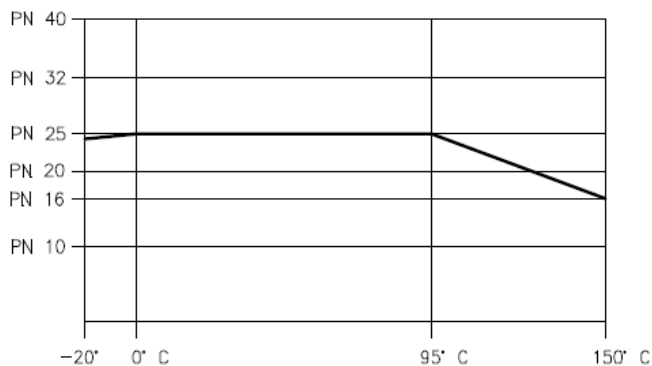

Pressure drop chart

