

Datasheet

Double Action Pneumatic Profile Cylinder

RS Stock number [480-2169](#)

Cylinders

ISO 6431
VDMA 24562

Ø32mm - Ø100mm



Features

- ◆ Double acting and through rod versions
- ◆ Infinitely adjustable end cushioning
- ◆ Magnetic piston as standard

Materials

Seals:

Piston: Polyurethane
Nose: Polyurethane
Cushion: Nitrile rubber
Static: Nitrile rubber

Piston rod: 416 stainless steel (burnished)

Body: Hard anodised aluminium
End caps: Aluminium - black finish
End cap fasteners: 416 stainless steel
Nose bearing: Sintered bronze

Description

- KCL1** Double acting pneumatic cylinder, non-lube, magnetic piston.
- KCK1** Double acting through-rod pneumatic cylinder, non lube, magnetic piston.

Technical Specifications

Pressure range: 0.5 to 10 bar
Temp range: -30 to +70°C
Media: Compressed and filtered air, dry or lubricated
Reed Switch Kit: Comprising (1x) normally open switch with LED and 1m flying lead (1x) mounting bracket

Part number	Cylinder Ø mm	(S) Stroke length mm												Reed switch kit part number (optional)
		25	50	80	100	125	160	200	250	300	400	500	>500	
KCL1	32	●	●	●	●	●	●	●	●	●	-	-	For	Kit 2561
KCK1	32	●	●	●	●	●	●	●	●	●	-	-	stroke	Kit 2561
KCL1	40	●	●	●	●	●	●	●	●	●	-	-	lengths	Kit 2562
KCK1	40	●	●	●	●	●	●	●	●	●	-	-	not	Kit 2562
KCL1	50	●	●	●	●	●	●	●	●	●	●	●	quoted	Kit 2563
KCK1	50	●	●	●	●	●	●	●	●	●	●	●	consult	Kit 2563
KCL1	63	●	●	●	●	●	●	●	●	●	●	●	technical	Kit 2564
KCK1	63	●	●	●	●	●	●	●	●	●	●	●	sales	Kit 2564
KCL1	80	●	●	●	●	●	●	●	●	●	●	●		Kit 2565
KCK1	80	●	●	●	●	●	●	●	●	●	●	●		Kit 2565
KCL1	100	●	●	●	●	●	●	●	●	●	●	●		Kit 2566
KCK1	100	●	●	●	●	●	●	●	●	●	●	●		Kit 2566

Dimensions
units mm

KCL1 Series

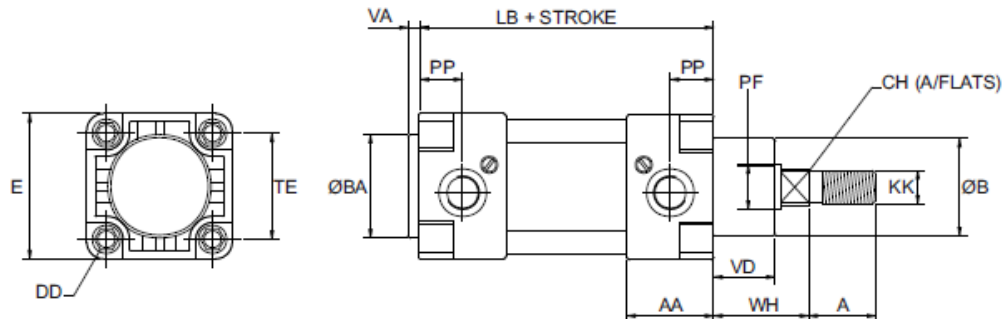
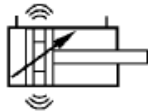

Cyl. Ø	A	AA	B/BA	CH	DD	E	KK	LB	PF	PP	TE	VD	VA	WH	Port
32	22	26	30	10	M6 x 1	48	M10 x 1.25	94	12	13.25	32.5	19	4	26	G1/8
40	24	31	35	13	M6 x 1	52	M12 x 1.25	105	16	15.00	38.0	22	4	30	G1/4
50	32	32	40	16	M8 x 1.25	65	M16 x 1.5	106	20	15.00	46.5	28	4	37	G1/4
63	32	37	45	16	M8 x 1.25	75	M16 x 1.5	121	20	18.50	56.5	20	4	37	G3/8
80	40	41	45	21	M10 x 1.5	95	M20 x 1.5	128	25	20.50	72.0	24	4	46	G3/8
100	40	41	55	21	M10 x 1.5	115	M20 x 1.5	138	30	20.50	89.0	30	4	51	G1/2

KCK1 Series

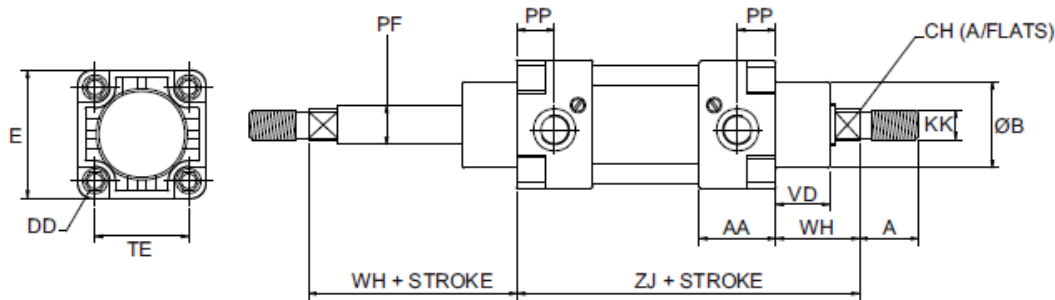
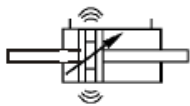

Cyl. Ø	A	AA	B	CH	DD	E	KK	PF	PP	TE	VD	ZJ	WH	Port
32	22	26	30	10	M6 x 1	48	M10 x 1.25	12	13.25	32.5	19	120	26	G1/8
40	24	31	35	13	M6 x 1	52	M12 x 1.25	16	15.00	38.0	22	135	30	G1/4
50	32	32	40	16	M8 x 1.25	65	M16 x 1.5	20	15.00	46.5	28	143	37	G1/4
63	32	37	45	16	M8 x 1.25	75	M16 x 1.5	20	18.50	56.5	20	158	37	G3/8
80	40	41	45	21	M10 x 1.5	95	M20 x 1.5	25	20.50	72.0	24	174	46	G3/8
100	40	41	55	21	M10 x 1.5	115	M20 x 1.5	30	20.50	89.0	30	189	51	G1/2