

NO	DESCRIPTION	DATE
①	BACKGROUND FORMAT UPDATED	05.08.02'
②	BODY ① MODIFICATION INSULATION ② CENTER CONTACT ③	07.19.05'
③	INSULATION ② MODIFICATION CENTER CONTACT ③ DEL RECOMMENDED COUPLING TORQUE	12.03.09'
④	1/4"-36UNS-2A → 1/4"-36UNS	04.06.11'
⑤	WORKING VOLTAGE → VOLTAGE RATING DEL PROOF VOLTAGE	04.08.14'

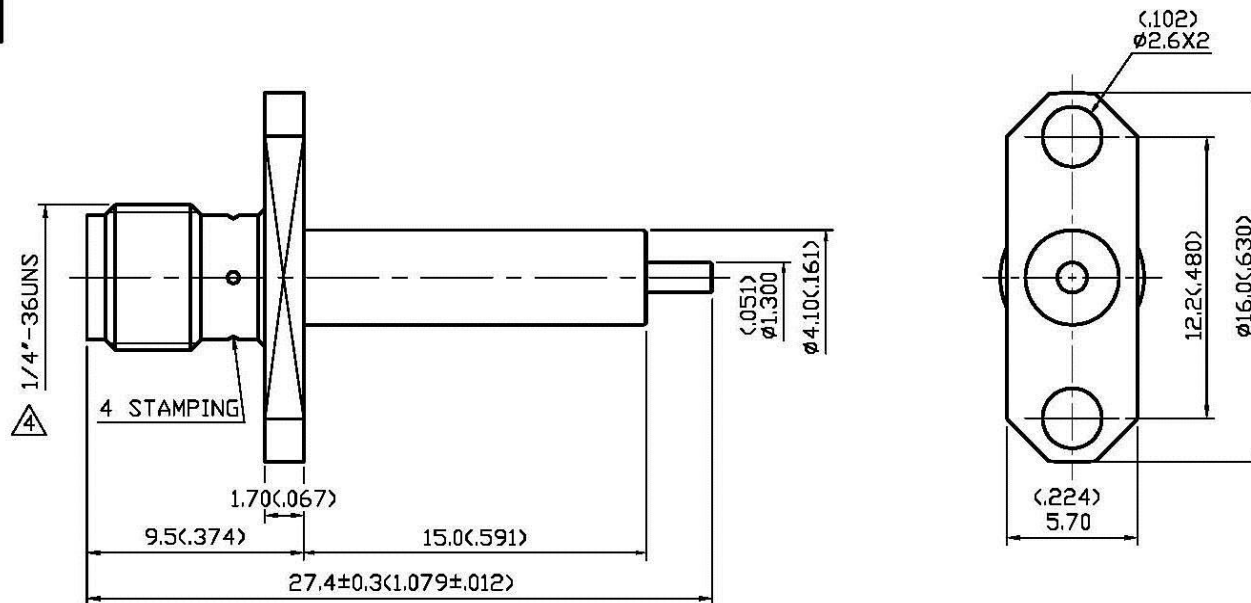

1.0 ELECTRICAL

- 1.1 FREQUENCY RANGE: DC-18 GHz
- 1.2 NOMINAL IMPEDANCE: 50 OHMS
- 1.3 VOLTAGE RATING: 500 VOLTS MAX. ⑤
- 1.4 VSWR: 1.23 MAX.

2.0 MATERIALS

- 2.1 BODIES: STAINLESS STEEL PER JIS SUS 303
- 2.2 CENTER CONTACT: BERYLLIUM COPPER PER ASTM B196 UNS C17300
- 2.3 INSULATION: TEFLON PER ASTM D1457 AND ASTM D1710

3.0 FINISHES AND OTHERS

- 3.1 SEE BELOW TABLE FOR DETAILS.

4.0 MECHANICAL

- 4.1 INTERFACE IN ACCORDANCE WITH: MIL-STD-348A

5.0 ENVIRONMENTAL

- 5.1 OPERATING TEMPERATURE RANGE: -65° C TO +165° C

NO	DESCRIPTION	MATERIAL	Q'TY	FINISH
3	CENTER CONTACT	BERYLLIUM COPPER	1	GOLD 50μ" MIN.
2	INSULATION	TEFLON	1	NONE
1	BODY	STAINLESS STEEL	1	GOLD 3μ" MIN.



APPROVED

by _____ DATE: _____

DESCRIPTION		SMA STRAIGHT 2 HOLE PANEL JACK RECEPTACLE (EXPOSED TEFLON)	
製圖	DRAWN Yoko	TOLERANCE	品名 19-17-13 T.G.G
檢圖	CHECK Arc	單位 mm(in)	DATE 02.11.98'
認定	APPROVAL Angela	比例 4:1	REV. A-5
		DWG.NO.	19-0011
			ROHS COMPLIANT (500)