

FEATURES

- Miniature module fitted with interconnect cable
- N/O (normally open contacts) with no magnet present
- Cable material PVC
- Cable length 500mm

RS PRO Reed Switch Cylindrical 90V, NO, 1A

RS Stock No.: 530-8911



RS Professionally Approved Products bring to you professional quality parts across all product categories. Our product range has been tested by engineers and provides a comparable quality to the leading brands without paying a premium price.

Product Description

RS PRO cylindrical sensors are magnetically operated reed proximity switches in a 4.0 mm diameter miniature module, fitted with interconnect cable. These switches are suitable for various applications including position and limit switch, end position sensing and machinery safety and control. The sensor should be mounted on a fixed surface with the actuating magnet on the moving surface. By presenting or removing the magnetic field determines the closing and opening of the reed switch

General Specifications

Switch Type	Magnetic Proximity
Switch Shape	Cylindrical
Pole and Throw Configuration	SPST
Normal State Configuration	NO
Material	PVC
Applications	Door & Window Contacts, Magnetic Floats for Water Level Detection, Position Sensing

Electrical Specifications

Terminal Type	Wire Lead
Cable	2 x single wire LIY 0,14 mm ² colour of wire: blue cable ends with 5 mm tinned leads

Contact Data	Conditions at 20°C	Min.	Typ.	Max.
Contact Rating	Any combination of the switching voltage and current must not exceed the given rated power			10W / 10VA
Maximum Current				1A
Maximum AC Voltage	AC			90V
Maximum DC Voltage	DC			90V
Contact Resistance	Measured with 40% overdrive			150mOhm
Insulation Resistance	RH 45%	10 ¹² Ohm		
Breakdown Voltage		200VDC		
Operate Time, Including Bounce	Measured with 40% overdrive			0.5ms
Release Time				0.1ms
Capacitance			0.3pF	

Magnetic Characteristics	Conditions at 20°C	Min.	Typ.	Max.
Pull-In Switch unmodified	Testcoil KMS-01	15AT		20AT
Drop Out Switch unmodified	Testcoil	-		-
Pull-In Switch modified	Testcoil KMS-13	28AT		49AT
Drop Out Switch modified	Testcoil	-		-

Mechanical Specifications

Dimensions	4 (Dia.) x 25.5mm
Length	25.5mm
Cable Length	500mm
Total Length	25.5mm

Operation Environment Specifications

Maximum Operating Temperature	-20°C
Minimum Operating Temperature	85°C
Storage Temperature	-20°C to 70°C
Shock	50g (½ sine wave, duration 11ms)
Vibration	20g (from 10 - 2000 Hz)
Sealing Compound	Epoxy resin

Approvals

Compliance/Certifications	RoHS
---------------------------	------

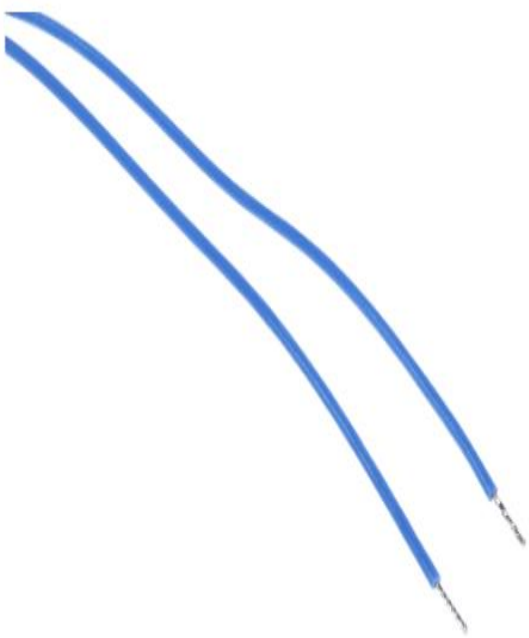

Dimensions (mm)



Marking

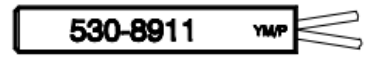
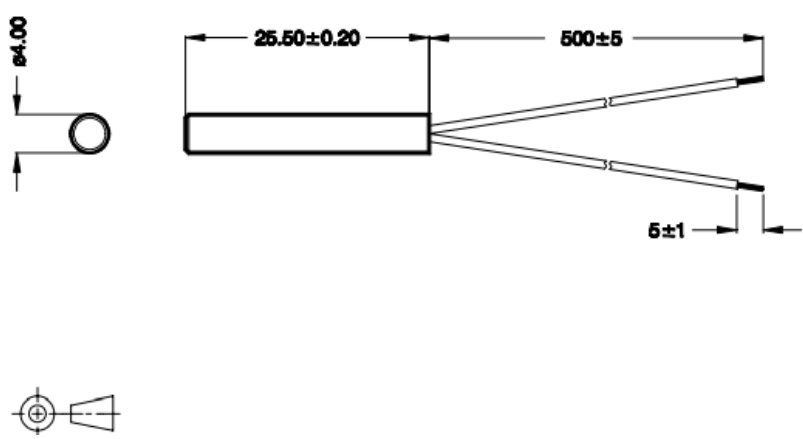

Customer p/n
Production-Code-EN60062/Factory Code