

## Datasheet

### SPDT Slide Switch

RS Stock number 734-7334

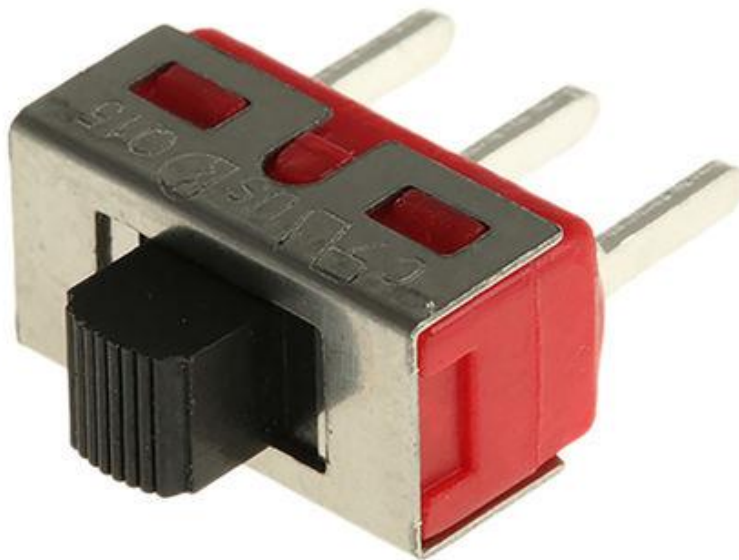

#### SPECIFICATIONS

**MECHANICAL LIFE:** 30,000 make-and-break cycles.

**CONTACT RESISTANCE:** 10m $\Omega$  max. Initial @ 2-4VDC  
100mA for both silver and gold plated contacts.

**INSULATION RESISTANCE:** 1,000M $\Omega$  min.

**DIELECTRIC STRENGTH:** 1,000 V RMS@sea level.

**OPERATING TEMPERATURE:** -30° C to 85° C.

#### MATERIALS

**CASE:** Dially phthalate (DAP) (UL94v-0).

**ACTUATOR:** Nylon,black std.

**HOUSING:** Stainless Steel.

**CONTACT:** Silver or gold plated.

**TERMINAL SEAL:** Epoxy.

**RoHS:** 2002/95/EC

**RATING :**

R : 0.4 Volt-Amps(VA) max. @20V max.(AC or DC)

Q : 2Amps @250VAC

5Amps @120 VAC or 28 VDC

Dimensions – inch  
mm

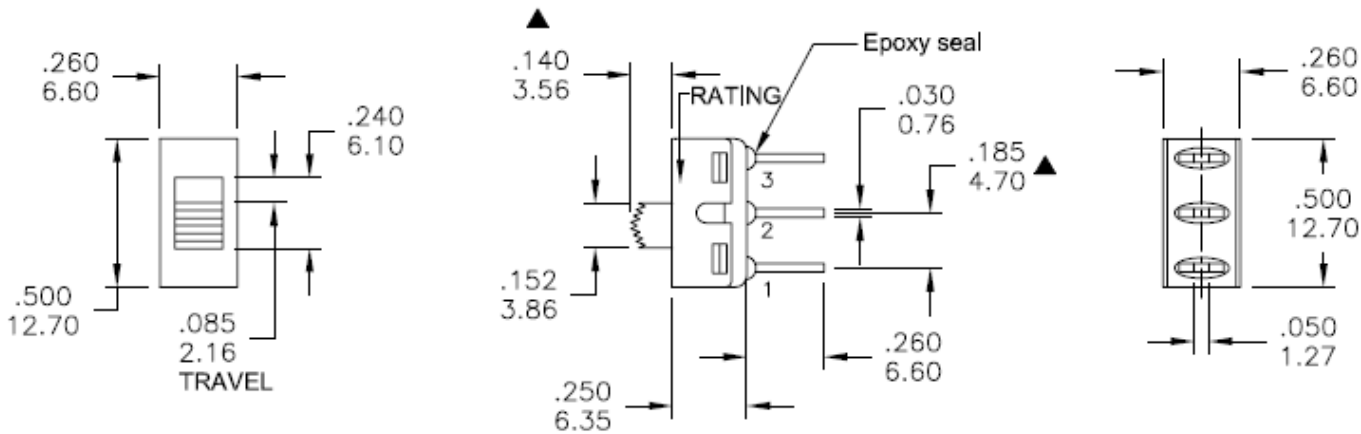

P.C. MOUNTING

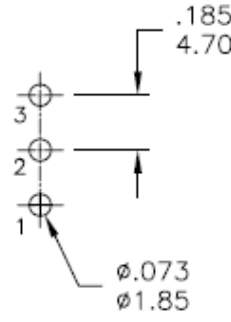

| Model No.   | POS.1 | POS.2 | POS.3 |
|-------------|-------|-------|-------|
|             |       |       |       |
| 5MS3        | ON    | OFF   | ON    |
| Term. Comm. | 2-1   | OPEN  | 2-3   |
| SCHEMATIC   |       |       |       |

SWITCH FUNCTION