





**Application Guide**  
**Bell Push Switch**

**CAT. NO.**  
E3031HBP  
E3031VBP

**NEO C-Metro**

Thank you for using **Schneider Electric** NEO C-Metro Bell Push Switch. To ensure proper application of our product, please read the following information before installation and use.

**This application guide applies to the following switches:**

|  | <b>Cat. no.</b> | <b>Description</b>                   |
|--|-----------------|--------------------------------------|
|  | E3031HBP        | 4A 1 Way Horizontal Bell Push Switch |
|  | E3031VBP        | 4A 1 Way Vertical Bell Push Switch   |

## **FEATURES**

1. Distinctive and superior dolly switch design.
2. Large dolly with curved profile for smooth switch action.
3. Fluorescent indicator as switch locator in the night.
4. Slim and stylish flush plate finishes with cross-type structural support to provide extra rigidity to flush plate.

## **SPECIFICATIONS**

|                 |               |
|-----------------|---------------|
| Voltage         | : 250VAC      |
| Dimension       | : 87mm X 87mm |
| Mounting Centre | : 60.3mm      |
| Compliance      | : IEC 60669-1 |

## MOUNTING INSTRUCTION

Please refer to the following diagram for proper installation of the faceplate and surround.

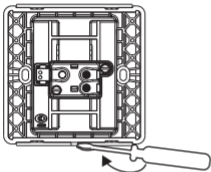

Wall Box

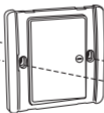

Faceplate

Mounting  
Screws



Surround

### Remark:

For surround mounting, align the clip locks on the faceplate and press firmly on the surround. Complete engagement of the clip locks is indicated by a clear "click" sound.

## IMPORTANT NOTE

Please check your local wiring regulation before actual installation

## WIRING DIAGRAM

