



SAMCOM ELECTRONICS PTE LTD SINCE 1980



WHAT WE STAND BY  
**SAMCOM ELECTRONICS - QUALITY  
EMERGENCY LIGHTING PRODUCTS YOU CAN  
RELY ON**

Continues over **40 years** practice with skill. Maturity complete with excellent for development and productivity. Experienced of company endeavoring to growth up the emergency escape lighting and related electronic product. Widely broad range for emergency escape lighting system and integrated solutions.

Our product consist for commercial buildings, healthcare facilities, hotel, shopping mall, operation plant and all other types of building.



PSB Singapore



QUALITY YOU CAN TRUST

- 89 Kaki Bukit Avenue 1 Shun Li Industrial Park Singapore 417957
- +65 6744 1100
- +65 6744 1114
- sales@samcom.com.sg



W W W . S A M C O M . C O M . S G



# OUR TEAM

Strengthening competition awareness, creating team spirit.



Emergency escape lighting systems designed more than support for fire disaster, its cover include for all civil structures where a power failure or mains supply failure to protect cause a risk of injury or death to the public, a major environmental hazard or substantial property damage.

## Highlights offered:

1. Local Manufacturer with truly ECO-Friendly design, secure and quality emergency escape lighting product range in Singapore.
2. Advanced LED lighting equipment focus increasingly to protecting the environment and improve energy saving and safety in mind.
3. Technical service support and solution to correspond for market requirement.
4. Customize to develop for new design requirement and new quality product.
5. Objective target a quality product with life cycle of trouble-free operation.
6. Local product warranty.



## Completed test and certified by TUV PSB Singapore.

Compliance:

**SS 563-2:2010/A1:2013**

Practice for the design, installation and maintenance of emergency escape lighting include power supply systems in buildings.

**SS IEC-60598-2-22:2016**

Particular requirements about luminaires for emergency escape lighting.



<b>FINAL EXIT</b> 	<b>EXIT SIGNS</b> 	<b>DIRECTION CHANGE</b> 	<b>INTERSECTIONS</b> 
At each exit door	At all safety exit signs	Within two metres of a change in direction	Within two metres of an intersection
<b>DIFFERENT LEVELS</b> 	<b>STAIRWAYS</b> 	<b>FINAL EXITS</b> 	<b>ALARM AREAS</b> 

Prepared a detailed database all of the emergency lighting product and present to customer. Our mission preservation for life safety.



W W W . S A M C O M . C O M . S G





**WELCOME TO OUR SHOWROOM**

**Our mission to preserve secure**



**SAMCOM**  
 郑在胜  
**Cheng Chye Sheng**  
 Business Development Sales & Engineering Manager

山峯電子私人有限公司  
**SAMCOM Electronics Pte Ltd**  
 89, Kaki Bukit Avenue 1, Shun Li Industrial Park, Singapore 417957  
 Tel : (65) 6744 1100 Fax : (65) 6744 1114 H/P : (65) 8200 1069  
 Email: chyesheng@samcom.com.sg www.samcom.com.sg

SUCCESSFUL ENTREPRENEUR

**EMERGENCY LUMINAIRE EXIT SIGN**

**EMERGENCY LUMINAIRE ESCAPE LIGHTING**

**SLIM SURFACE MOUNT**

**BOXES SURFACE MOUNT**

**SLIM RECESS**

**WIDER SURFACE MOUNT**

**RECESS OR SURFACE MOUNT**



**ELS 115M-LED**

**SLR 158**

**ETL 201P-LED**

**ETL 208-LED**

**EHL-101M-LED**

**EHL-101-LED**

**EHS-109-LED-CLD**



**SLED X1 WHITE / BLACK**

**ELW 115-LED-T5 (IP-65)**

**SLR 308 (DOUBLE SIDE)**

**ETL 208-LED-WP**

**ETL 108-LED**

**EHL-109-LED INTERSPACE WITHIN 50mm**

**EEL-115P-LED EEW-115P-LED-WP**

SLIM SIGN	SLED-X1 WHITE / BLACK CASING
SLIM SIGN RECESS	SLR 158 / SLR 308 ( DOUBLE SIDE )
BOX SIGN	ELS 115M - LED
BOX SIGN	ELW 115 -LED OR ELW 115-LED-T5
BOX SIGN	ELS 209-LED 2FT T8 TUBE

TWIN LAMP	ETL 201P-LED
TWIN LAMP	ETL-208-LED
TWIN LAMP (IP65)	ETL 208-LED-WP
SINGLE LAMP	ESS 108-LED

RECESS MOUNT	EHL 101M-LED EHL 101-LED EHL 109-LED
SURFACE MOUNT	EHS 109-LED-CLD EEL-115P-LED EEW-115P-LED-WP

Visit our product online support detail :



**W W W . S A M C O M . C O M . S G**





# WELCOME TO OUR SHOWROOM

Diving into a Fire & Life Safety Systems.



## EMERGENCY LUMINAIRE ESCAPE LIGHTING

### POWER PACK MODULE.



EMK 120 / 140-LED

CUSTOMIZE FITTING. 2FT or 4FT LED T8 TUBE.

SURFACE LOUVER FITTING

DIFFUSER FITTING



BATTEN FITTING

NON-CORROSIVE FITTING



ROUND CEILING LIGHT

SQURE CEILING LIGHT



SIZE: DIA34CM X H10CM

SIZE: SQU30CM X H9CM

### SURFACE MOUNT WARNING SIGN



IP65



IP65

1. DC INPUT 24V FLASH WARNING
2. DC INPUT 24V LIGHT UP WARNING
3. OR OTHER AC 230V INPUT.

### CUSTOMIZE SIGN BOARD OR WARNING LIGHT:



SLIM CASE

BOX CASE

IP65 BOX CASE

BOX SIGN (Metal)

BL2430-LED-SMT-EAI  
BL2430-LED-SMT-GD

BOX SIGN ( ABS-IP65 )

BL2430-LED-T5-WP-EAI  
BL2430-LED-T5-WP-GD

POWER PACK MODULE LIGHTING

EML 120 / 140-LED  
EML 120 / 140-DAIKON  
EML 120 / 140-LED-BATTEN  
EML 120 / 140-WP  
EPL 160-LED-ROUND / SQUIRE

## PRODUCT ACCESSORIES & OTHERS



NICKEL CADNIUM BATTERY. 2.4V / 4.8V / 6V (1.7AH OR 2.5AH)



SEALED LEAD ACID  
6V (4.5AH)  
6V (7.5AH)

### CUSTOMIZE Signage Catalogue

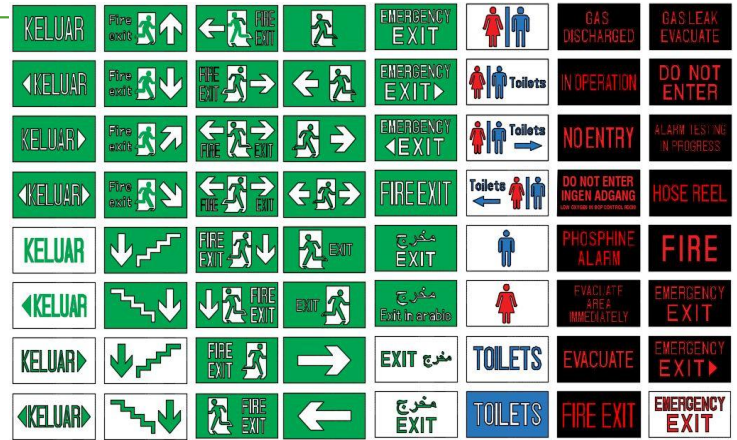

Visit our product online support detail :



W W W . S A M C O M . C O M . S G





## BENEFITS OF LED LIGHTING

- DURABILITY**: LED LIGHTS ARE MADE WITH SOLID COMPONENT
- EFFICIENCY**: LED USES AROUND 30-70% LESS POWER
- ENVIRONMENTAL SAFETY**: IT IS EASY TO DISPOSE
- TEMPERATURE**: LED'S EMIT ATLEAST 20-50% LESS HEAT COMPARED
- REACTION TIME**: LED LIGHTS CAN BE SWITCHED ON AND OFF INSTANTANEOUSLY
- LOW MAINTENANCE**: LESSER MAINTENANCE COMPARED TO OTHER LIGHTING OPTIONS
- COLOR VARIETY**: LED ARE AVAILABLE IN MULTIPLE COLOR OPTIONS
- LONGER LIFE SPAN**: 50 TIMES LONGER THAN INCANDESCENT

**Incandescent** 10% Light, 90% Heat  
**Fluorescent** 20% Light, 80% Heat  
**LED** 80% Light, 20% Heat



### Daylight Advantages

The overall objective of daylighting is to minimize the amount of artificial light and reduce electricity costs, but it can also lower HVAC costs as well. Most buildings incorporating daylighting, the overall energy savings range up to 60 percent. It can also have an improve the productivity and satisfaction of employees, students and retail service. People have a natural attraction and need for daylight. Studies suggest that daylighting has a direct impact on well-being, productivity and overall sense of satisfaction. Retail stores have seen the environmental and monetary benefits of daylighting for both employees and consumers.

### Environmental performance

Difference between the two led tube in terms of environmental performance, the rare earth trichromatic phosphor used in the t5 led tube, compared with the energy consumption, the t8 lamp can save almost 20% to 30% energy then t5 The lamp is more energy efficient and environmentally friendly than the t8 lamp.

### Cost Structure and revenue streams.

1. Switch to LED tubes improve triple-benefits-financial, health and environment.
2. Colour of daylight illustrate brighter technology indicating energy saving.
3. Extending lifespan particularly reduce maintenance cost.

## PREMIUM T8 LED TUBE.



<b>SINGLE-END CONNECTION</b>	<b>DAYLIGHT 6500K</b>
<b>SCLED-118-18DLT8-4FS</b>	<b>4 FEET 18W 1800lm</b>
<b>DOUBLE-END CONNECTION</b>	<b>DAYLIGHT 6500K</b>
<b>SCLED-109</b>	<b>2 FEET 9W 900lm</b>
<b>SCLED-118D-18</b>	<b>4 FEET 18W 1800lm</b>
<b>SCLED-118D-28</b>	<b>4 FEET 18W 2800lm</b>

**80%** **Reduced Energy Costs**  
 LED lighting can save you up to 80% on your existing energy bill. Plus, you may qualify for an Energy Rebate.

**Longer Life**  
 The life of other lighting sources average between 1,000-20,000 hours. LED lighting has a 50,000 hour life. This means lower maintenance and relamping costs.

**Environmental Advantage**  
 LED lighting is mercury free and generates less heat. Ideal for sustainability and Green solutions.

YOU USED TO BUY (Least efficient) → YOUR CHOICES NOW (Most efficient)

Lumens	STANDARD INCANDESCENT	NEW INCANDESCENT	CFL	LED
450	40 W \$5.34/yr	29 W \$3.87/yr	10 W \$1.34/yr	5 W \$0.87/yr
800	60 W \$8.02/yr	43 W \$5.74/yr	13 W \$1.74/yr	10 W \$1.34/yr
1100	75 W \$10.02/yr	53 W \$7.08/yr	16 W \$2.14/yr	15 W \$2.00/yr
1600	100 W \$13.36/yr	72 W \$9.62/yr	20 W \$2.67/yr	19 W \$2.54/yr (limited availability)

\*Rated life is based on 3 hours of use per day

#### INSTALLATION DOUBLE SIDE CONNECTION DIAGRAM:

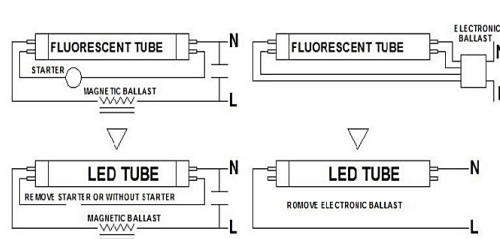

#### INSTALLATION SINGLE SIDE CONNECTION (12S LED) DIAGRAM:

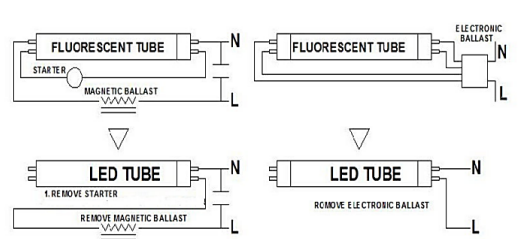





# SAMCOM ELECTRONIC SINGAPORE'S MANUFACTURER SINCE 1980.....

Design, development and production for related few type emergency escape lighting products. Our broad range and integrated solutions are widely suitable in commercial buildings, industrial buildings, public buildings, government institutional buildings for locally and regionally.

OUR VISION  
YOUR SECURITY

## FOCUS ON QUALITY



Quality is integral part of our company philosophy. Our quality management program product development fully comply with safety requirement standards. We provide products and services consistent with consumer needs and industry expectations.

## INNOVATIVE APPROACH



Since the company's inception, our innovative engineering develop the quality and reliability product lines, focused product offering allowed become experts in solutions to a variety of market segments.

## GROUNDING IN SERVICE



Our commitment to dedicated for customer beyond fulfilment, start beginning product development, production, delivery and service support. Our company service-orientated with manufacturing facilities cater to customize requirements, which has given us a valuable reputation among organisations worldwide markets.

## PROJECT REFERENCES



## COMPANY HISTORY TIMELINE

### Since 1980-1983

- Search, design and progress to safety emergency escape Product.
- Established brand new SAMCOM manufacturer in Singapore.

### Year 1987-1990

- Develop new skill to product the Hybrid IC controller.
- Productivity expanded to 4000 sq ft locate in Tampines Singapore.
- Setup Incorporate Company

### Year 1991-1997

- Product supply for international market.
- Exploitation AC/DC transformer section and CNC machine.
- Innovated Samcom Electronic website support.

### Year 1998-2003

- Explan9000sqft private factory at Kaki Bukit Singapore.
- Created Hybrid and Thick film factory.
- Subjoin metal stamping section.
- Hycer Pte Ltd joined.

### Year 2004-2011

- Obtained and Certification ISO9001 Quality standard.
- Enhance ROHS compliant and utilize led product.
- Apply automate SMT and punching machine.

### Year 2012-2019

- Expanded 2000sqft 2<sup>nd</sup> private factory at Enterprise one Singapore.
- Created social media support and launch E-commerce online sale platform.

### 2020 present....

- Sharing partnership Worldwide market.
- Carry on to develop new quality and secure product.
- Provide one stop solution support to customer need.

WELCOME  
THANK YOU FOR JOINING US



W W W . S A M C O M . C O M . S G