

Spring Check Valve

Features

- Spring type
- Material: SS316
- Seat: Metal/Viton
- Size: 1/4" – 2"
- Working Pressure: 1000 PSI
- Threaded End: BSPP, NPT
- Cracking Pressure: 1 Bar
- Applicable Medium: General oil, Gas & Water applications
- Temperature Range: -29°C to 150°C



Spring Check Valve with Metal Seat

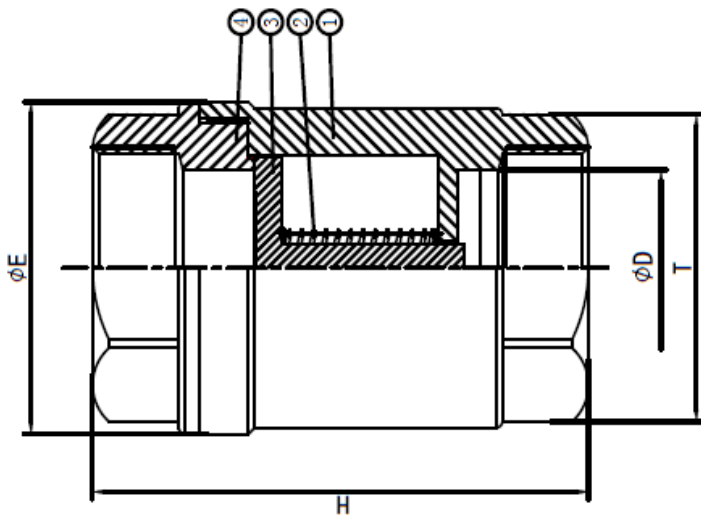

Material List

No.	Part Name	Material
1	Body	SS316, CF8M
2	Spring	SS316
3	Disc	SS316, CF8M
4	Cap	SS316, CF8M

Spring Check Valve with Viton Seat

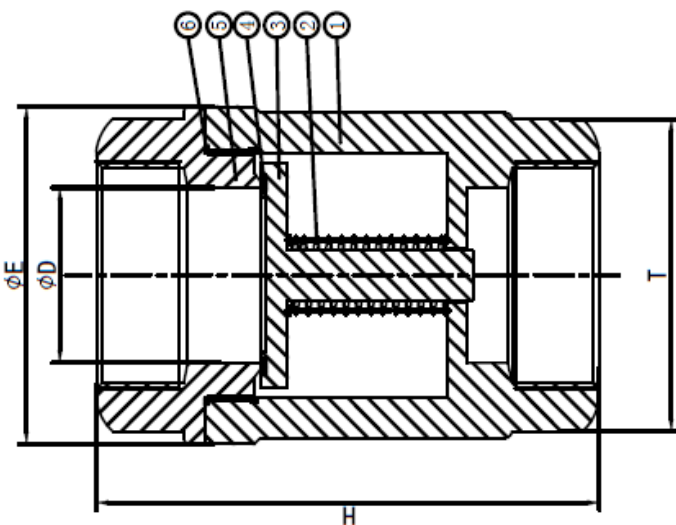

Material List

No.	Part Name	Material
1	Body	SS316, CF8M
2	Spring	SS316
3	Disc	SS316, CF8M
4	Seat Ring - (O-Ring)	VITON
5	Cap	SS316, CF8M
6	Seal Gasket	PTFE

Ordering Information

VL - S - B2 - G - 1000 - 08
 I II III IV V VI

I Type of Item

VL Low Pressure Valves

II Material Grade

S SS316, CF8M CI Cast Iron
 FS Forged Steel CS Cast Steel
 B Brass

III Item

GA Gate Valve B1 1 PC Ball Valve
 GL Globe Valve B2 2 PC Ball Valve
 YS Y-Strainer B3 3 PC Ball Valve
 SC Swing Check Valve BL 3 Way Ball Valve L Port
 VC Vertical Check Valve BT 3 Way Ball Valve T Port
 WC Wafer Check Valve BMF Male x Female Mini Ball Valve
 DD Dual Disk BU Butterfly Valve

IV Connection Type

SW S/W G BSPP
 BW B/W N NPT
 R BSPT F Flanged End
 W Wafer L Lug

V Pressure

200 200 PSI 1000 1000 PSI
 300 300 PSI 150 ANSI 150# Flange Standard
 600 600 PSI 10K JIS 10K Flange Standard
 800 800 PSI PN16 PN16 Flange Standard

For Inch OD & Inch NB Sizes

VI Size

Size	1/8"	1/4"	5/16"	3/8"	1/2"	5/8"	3/4"	1"
Code	02	04	05	06	08	10	12	16
Size	1 1/4"	1 1/2"	2"	2 1/2"	3"	4"	5"	6"
Code	20	24	32	40	48	64	80	96

VII Coating

(none) No additional Coating
 NI Nickel Plating

Dimension List

NPS	Connection	Impa Code	Part No	D	H	E	T	Weight (kg)
1/2"	BSPP	-	VL-S-VC-G-1000-08	14	62	39	27	0.25
			VL-S-VC-G-VI-1000-08					
3/4"	BSPP	-	VL-S-VC-G-1000-12	19	69	43	32	0.36
			VL-S-VC-G-VI-1000-12					
1"	BSPP	-	VL-S-VC-G-1000-16	24	82	48	38	0.48
			VL-S-VC-G-VI-1000-16					
1 1/4"	BSPP	-	VL-S-VC-G-1000-20	30	93	58	47	0.85
			VL-S-VC-G-VI-1000-20					
1 1/2"	BSPP	-	VL-S-VC-G-1000-24	38	102	71	55	1.32
			VL-S-VC-G-VI-1000-24					
2"	BSPP	-	VL-S-VC-G-1000-32	48	116	81	68	1.88
			VL-S-VC-G-VI-1000-32					
3"	BSPP	-	VL-S-VC-G-1000-48	78	170	140	98	-
			VL-S-VC-G-VI-1000-48					
1/2"	NPT	-	VL-S-VC-N-1000-08	14	62	39	27	0.25
			VL-S-VC-N-VI-1000-08					
3/4"	NPT	-	VL-S-VC-N-1000-12	19	69	43	32	0.36
			VL-S-VC-N-VI-1000-12					
1"	NPT	-	VL-S-VC-N-1000-16	24	82	48	38	0.48
			VL-S-VC-N-VI-1000-16					
1 1/4"	NPT	-	VL-S-VC-N-1000-20	30	93	58	47	0.85
			VL-S-VC-N-VI-1000-20					
1 1/2"	NPT	-	VL-S-VC-N-1000-24	38	102	71	55	1.32
			VL-S-VC-N-VI-1000-24					
2"	NPT	-	VL-S-VC-N-1000-32	48	116	81	68	1.88
			VL-S-VC-N-VI-1000-32					
3"	NPT	-	VL-S-VC-N-1000-48	78	170	140	98	-
			VL-S-VC-N-VI-1000-48					

Spring Check Valve with Metal Seat Part Number Reference

Impa Code	Part No	Description
-	VL-S-VC-G-1000-04	1/4"BSPP SS316 SPRING CHECK VALVE 1000 PSI,CRACKING PRESSURE:1 BAR,METAL SEAT
-	VL-S-VC-G-1000-06	3/8"BSPP SS316 SPRING CHECK VALVE 1000 PSI,CRACKING PRESSURE:1 BAR,METAL SEAT
-	VL-S-VC-G-1000-08	1/2"BSPP SS316 SPRING CHECK VALVE (1000 PSI,CRACKING PRESSURE:1 BAR,METAL SEAT
-	VL-S-VC-G-1000-12	3/4"BSPP SS316 SPRING CHECK VALVE 1000 PSI,CRACKING PRESSURE:1 BAR,METAL SEAT
-	VL-S-VC-G-1000-16	1"BSPP SS316 SPRING CHECK VALVE 1000 PSI,CRACKING PRESSURE:1 BAR,METAL SEAT
-	VL-S-VC-G-1000-20	1 1/4"BSPP SS316 SPRING CHECK VALVE 1000 PSI,CRACKING PRESSURE:1 BAR,METAL SEAT
-	VL-S-VC-G-1000-24	1 1/2"BSPP SS316 SPRING CHECK VALVE 1000 PSI,CRACKING PRESSURE:1 BAR,METAL SEAT
-	VL-S-VC-G-1000-32	2"BSPP SS316 SPRING CHECK VALVE 1000 PSI,CRACKING PRESSURE:1 BAR,METAL SEAT
-	VL-S-VC-N-1000-04	1/4"NPT SS316 SPRING CHECK VALVE 1000 PSI,CRACKING PRESSURE:1 BAR,METAL SEAT
-	VL-S-VC-N-1000-06	3/8"NPT SS316 SPRING CHECK VALVE 1000 PSI,CRACKING PRESSURE:1 BAR,METAL SEAT
-	VL-S-VC-N-1000-08	1/2"NPT SS316 SPRING CHECK VALVE 1000 PSI,CRACKING PRESSURE:1 BAR,METAL SEAT
-	VL-S-VC-N-1000-12	3/4"NPT SS316 SPRING CHECK VALVE 1000 PSI,CRACKING PRESSURE:1 BAR,METAL SEAT
-	VL-S-VC-N-1000-16	1"NPT SS316 SPRING CHECK VALVE 1000 PSI,CRACKING PRESSURE:1 BAR,METAL SEAT
-	VL-S-VC-N-1000-20	1 1/4"NPT SS316 SPRING CHECK VALVE 1000 PSI,CRACKING PRESSURE:1 BAR,METAL SEAT
-	VL-S-VC-N-1000-24	1 1/2"NPT SS316 SPRING CHECK VALVE 1000 PSI,CRACKING PRESSURE:1 BAR,METAL SEAT
-	VL-S-VC-N-1000-32	2"NPT SS316 SPRING CHECK VALVE 1000 PSI,CRACKING PRESSURE:1 BAR,METAL SEAT

Spring Check Valve with Viton Seat Part Number Reference

Impa Code	Part No	Description
-	VL-S-VC-G-VI-1000-04	1/4"BSPP SS316 SPRING CHECK VALVE 1000 PSI,CRACKING PRESSURE:1 BAR,VITON SEAT
-	VL-S-VC-G-VI-1000-06	3/8"BSPP SS316 SPRING CHECK VALVE 1000 PSI,CRACKING PRESSURE:1 BAR,VITON SEAT
-	VL-S-VC-G-VI-1000-08	1/2"BSPP SS316 SPRING CHECK VALVE 1000 PSI,CRACKING PRESSURE:1 BAR,VITON SEAT
-	VL-S-VC-G-VI-1000-12	3/4"BSPP SS316 SPRING CHECK VALVE 1000 PSI,CRACKING PRESSURE:1 BAR,VITON SEAT
-	VL-S-VC-G-VI-1000-16	1"BSPP SS316 SPRING CHECK VALVE 1000 PSI,CRACKING PRESSURE:1 BAR,VITON SEAT
-	VL-S-VC-G-VI-1000-20	1 1/4"BSPP SS316 SPRING CHECK VALVE 1000 PSI,CRACKING PRESSURE:1 BAR,VITON SEAT
-	VL-S-VC-G-VI-1000-24	1 1/2"BSPP SS316 SPRING CHECK VALVE 1000 PSI,CRACKING PRESSURE:1 BAR,VITON SEAT
-	VL-S-VC-G-VI-1000-32	2"BSPP SS316 SPRING CHECK VALVE 1000 PSI,CRACKING PRESSURE:1 BAR,VITON SEAT
-	VL-S-VC-N-VI-1000-04	1/4"NPT SS316 SPRING CHECK VALVE 1000 PSI,CRACKING PRESSURE:1 BAR,VITON SEAT
-	VL-S-VC-N-VI-1000-06	3/8"NPT SS316 SPRING CHECK VALVE 1000 PSI,CRACKING PRESSURE:1 BAR,VITON SEAT
-	VL-S-VC-N-VI-1000-08	1/2"NPT SS316 SPRING CHECK VALVE 1000 PSI,CRACKING PRESSURE:1 BAR,VITON SEAT
-	VL-S-VC-N-VI-1000-12	3/4"NPT SS316 SPRING CHECK VALVE 1000 PSI,CRACKING PRESSURE:1 BAR,VITON SEAT
-	VL-S-VC-N-VI-1000-16	1"NPT SS316 SPRING CHECK VALVE 1000 PSI,CRACKING PRESSURE:1 BAR,VITON SEAT
-	VL-S-VC-N-VI-1000-20	1 1/4"NPT SS316 SPRING CHECK VALVE 1000 PSI,CRACKING PRESSURE:1 BAR,VITON SEAT
-	VL-S-VC-N-VI-1000-24	1 1/2"NPT SS316 SPRING CHECK VALVE 1000 PSI,CRACKING PRESSURE:1 BAR,VITON SEAT
-	VL-S-VC-N-VI-1000-32	2"NPT SS316 SPRING CHECK VALVE 1000 PSI,CRACKING PRESSURE:1 BAR,VITON SEAT