

Datasheet

RS PRO Bearing Adapter Sleeve

Stock No: 196-4136



Technical Specifications:

Inside Diameter	45
Locknut Diameter	70
Total Length	55

Features & Benefits:

- Most commonly used method of locating bearings with a tapered bore onto a cylindrical shaft
- Easy to install
- Require no additional location on the shaft required
- Fitted with a slit that allows for easy mounting to increase flexibility
- Different Options available to suit many bearing variations
- Range of sizes available to accommodate oil injection

Dimensional line drawings

Dimensions

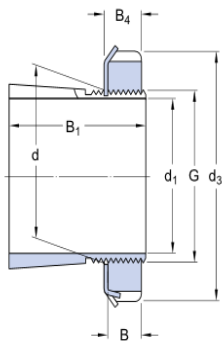

d ₁	45	mm
d	50	mm
d ₃	70	mm
B ₁	55	mm
B	11	mm
B ₄	12	mm
G	M 50x1.5	

Mass

Mass adapter sleeve assembly

0.34

kg

Quality Standards

ISO – 2982-1

