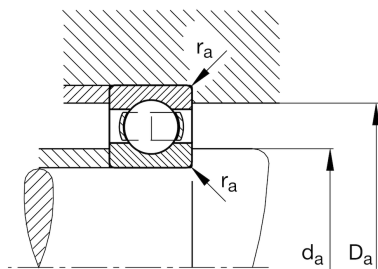
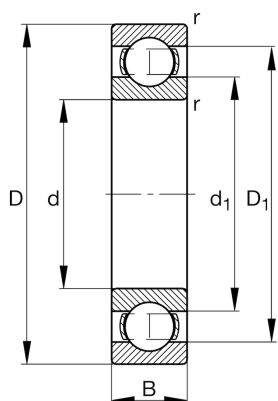

**FAG****6217-C3**

Deep groove ball bearing

Schaeffler ID:
0167214380030Deep groove ball bearing 62, single row,
steel sheet metal cage

Technical information

**Main Dimensions & Performance Data**

d	85 mm	Bore diameter
D	150 mm	Outside diameter
B	28 mm	Width
C_r	89,000 N	Basic dynamic load rating, radial
C_{0r}	64,000 N	Basic static load rating, radial
C_{ur}	4,050 N	Fatigue load limit, radial
n_G	6,700 1/min	Limiting speed
n_{gr}	5,300 1/min	Reference speed
	1.798 kg	Weight

Mounting dimensions

$d_{a \min}$	96 mm	Minimum diameter shaft shoulder
$D_{a \max}$	139 mm	Maximum diameter of housing shoulder
$r_{a \max}$	2 mm	Maximum fillet radius

Dimensions

r_{\min}	2 mm	Minimum chamfer dimension
D_1	129.8 mm	Shoulder diameter outer ring
d_1	106.6 mm	Shoulder diameter inner ring

Temperature range

T_{\min}	-30 °C	Operating temperature min.
T_{\max}	150 °C	Operating temperature max.

Calculation factors

f_0	14.8	Calculation factor
-------	------	--------------------