

Fuji USER MANUAL

— DRILLS —

MODELS : FRD-23R-21, -21S, -22, -22S



FRD-23R-21, -21S

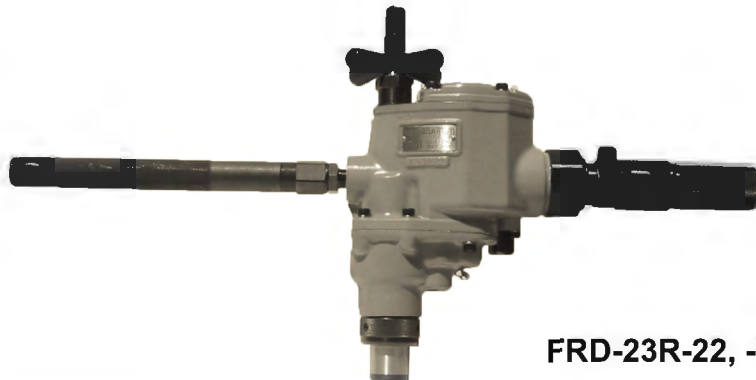

FRD-23R-22, -22S

SPECIFICATIONS

Model	Capacity			Socket	Stall Torque	Max. Output	Rotational Frequency	Max. Air Consumption	Feed Length	Overall Length	Mass	Air Inlet Thread Size	Air Hose Size
	Drilling	Reaming	Tapping										mm
	mm	mm	mm	M.T.#	N·m	W	min ⁻¹	m ³ /min	mm	mm	kg	mm	
FRD-23R-21	22	19	19	2	78.4	880	480	1.2	67	282	7.3	PT or NPT1/2	12.7
FRD-23R-21S	22	19	19	2	78.4	880	480	1.2	67	282	7.3	PT or NPT1/2	12.7
FRD-23R-22	22	19	19	3	78.4	880	480	1.2	67	307	7.4	PT or NPT1/2	12.7
FRD-23R-22S	22	19	19	3	78.4	880	480	1.2	67	307	7.4	PT or NPT1/2	12.7

The performance figures are at 0.63MPa (6.3bar).

 Refer to "The Instructions and Warning for Safety Use" enclosed in each tool box.

Fuji Industrial Technique Co.,Ltd.

2-1-14, Kamiji, Higashinari-ku, Osaka, 537-0003 Japan

Tel : 81-6-6972-2335

Fax : 81-6-6972-2380

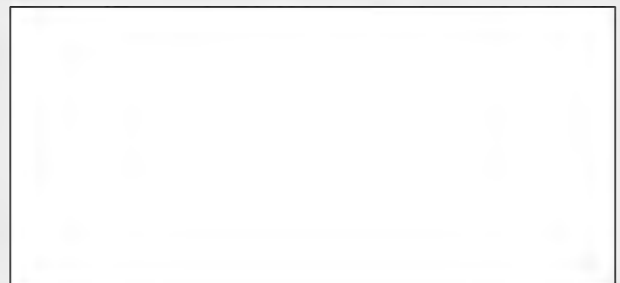

MODELS : FRD-23R-21, -21S, -22, -22S

EXPLODED VIEW

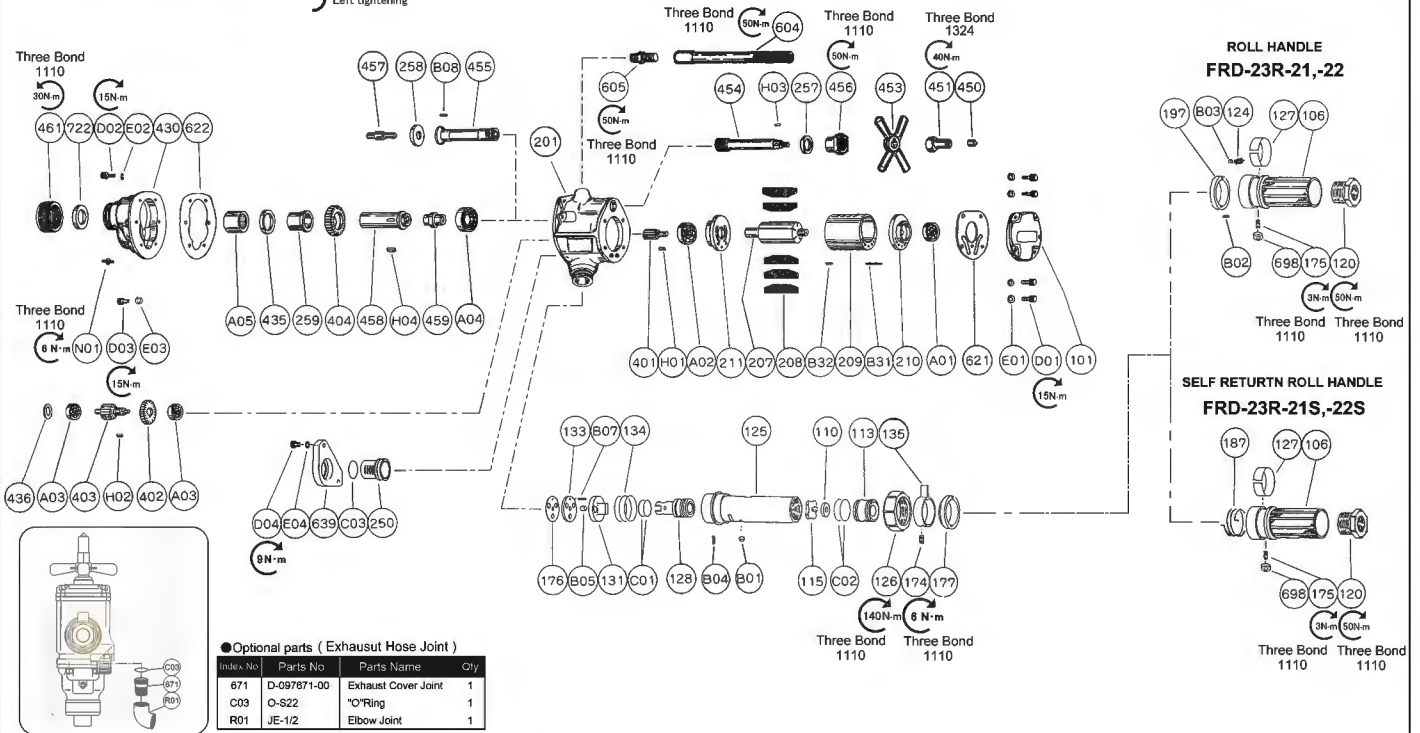
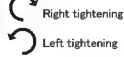

●Optional parts (Exhaust Hose Joint)

Index No.	Parts No.	Parts Name	Qty
671	D-097871-00	Exhaust Cover Joint	1
C03	O-S22	"O"Ring	1
R01	JE-12	Elbow Joint	1

PARTS LIST

Index No.	Parts No.	Parts Name	Qty	Index No.	Parts No.	Parts Name	Qty	Index No.	Parts No.	Parts Name	Qty				
FRD-23R-21,-22															
Roll Handle Type															
—	D-095004-03	Throttle Valve Stem Ass'y < PT >		175	M-040175-00	Small Screw (B)	1	459	D-008459-00	Socket Arbor	1				
—	D-095004-10	Throttle Valve Stem Ass'y < NPT >		177	M-040177-00	Throttle Handle Step	1	461	D-008461-A	Socket Nut	1				
106	M-040106-00	Throttle Valve Handle	1	187	M-040187-00	Throttle Valve Handle Spring	1	604	T-004604-00	Dead Handle	1				
110	M-040110-00	Throttle Valve	1	698	D-026698-00	Guide Roller	1	605	D-008605-00	Dead Handle Joint	1				
113	M-040113-00	Throttle Valve Rod	1	B01	NR-45	Needle Roller	1	621	D-095621-00	Packing (A)	1				
115	M-040115-00	Throttle Valve Sheet	1	B04	SP-38	Spring Pin	1	622	D-008622-00	Packing (B)	1				
120	M-040120-00	Throttle Valve Cover < PT >	1	C01	O-11	"O"Ring	2	639	D-095639-00	Exhaust Cover Holder	1				
	M-040120-01	Throttle Valve Cover < NPT >	1	C02	O-S20	"O"Ring	2	722	D-008722-00	Leather Packing	1				
124	G-005124-00	Knock Spring	1	FRD-23R-21,-21S											
125	M-040125-00	Throttle Valve Stem	1	—	D-095006-54	Housing Ass'y		A01	BB-6202	Ball Bearing	1				
126	D-095126-00	Throttle Valve Stem Nut	1	133	D-008133-02	Reverse Valve Sheet	1	A02	BB-6203	Ball Bearing	1				
127	M-040127-00	Throttle Valve Handle Band	1	176	D-008176-00	Reverse Valve Sheet Packing	1	A03	BB-627	Ball Bearing	2				
128	M-040128-00	Reverse Valve Rod	1	201	D-095201-04	Housing	1	A04	BB-7203	Ball Bearing	1				
135	D-026135-00	Reverse Valve Lever	1	B07	SP-38	Spring Pin	1	A05	NB-SC2016	Needle Bearing	1				
174	D-026174-00	Small Screw	1	101	D-095101-00	Housing Cover	1	B05	NR-412	Needle Roller	1				
175	M-040175-00	Small Screw (B)	1	131	D-008131-01	Reverse Valve	1	B08	SP-38	Spring Pin	1				
177	M-040177-00	Throttle Handle Step	1	134	D-008134-01	Reverse Valve Spring	1	C03	O-S22	"O"Ring	1				
197	D-097197-00	Handle Bushing	1	207	D-026207-00	Rotor	1	D01	CS-622	Cap Screw	4				
(B02)	SP-28	Spring Pin	1	208	D-026208-00	Rotor Blade	5	D02	CS-622	Cap Screw	4				
698	D-026698-00	Guide Roller	1	209	D-026209-00	Cylinder	1	D03	CS-616	Cap Screw	2				
B01	NR-45	Needle Roller	1	(B31)	SP-320	Spring Pin	1	D04	CS-520	Cap Screw	2				
B03	NR-35FR	Needle Roller	1	(B32)	SP-310	Spring Pin	1	E01	SW-6	Spring Washer	4				
B04	SP-38	Spring Pin	1	210	D-026210-00	Cylinder Upper Plate	1	E02	SW-6	Spring Washer	4				
C01	O-11	"O"Ring	2	211	D-008211-00	Cylinder Lower Plate	1	E03	SW-6	Spring Washer	2				
C02	O-S20	"O"Ring	2	250	D-097250-00	Exhaust Cover	1	E04	SW-5	Spring Washer	2				
FRD-23R-21S,-22S															
Self Return Roll Handle Type															
—	D-095004-04	Throttle Valve Stem Ass'y < PT >		257	D-008257-00	Washer	1	H01	K-3311	Key	1				
—	D-095004-08	Throttle Valve Stem Ass'y < NPT >		258	D-008258-00	Washer (B)	1	H02	K-338.5	Key	1				
106	M-040106-00	Throttle Valve Handle	1	259	D-008259-00	Inner Race (FRD-23R-21,-21S)	1	H03	K-3.53.511	Key	1				
110	M-040110-00	Throttle Valve	1	401	D-026401-00	No.1 Pinion	1	H04	K-4511.5	Key	1				
113	M-040113-00	Throttle Valve Rod	1	402	D-008402-00	No.1 Gear	1	N01	GN-6	Grease Nipple	1				
115	M-040115-00	Throttle Valve Sheet	1	403	D-009403-00	No.2 Pinion	1	FRD-23R-22,-22S							
120	M-040120-00	Throttle Valve Cover < PT >	1	404	D-009404-00	No.2 Gear	1	It is common with FRD-23R-21,-21S							
	M-040120-01	Throttle Valve Cover < NPT >	1	430	D-008430-A	No.1 Gear Case	1	excluding the parts below.							
125	M-040125-00	Throttle Valve Stem	1	435	D-034435-00	Thrust Washer	1	430	D-034430-00	No.1 Gear Case	1				
126	D-095126-00	Throttle Valve Stem Nut	1	436	D-008436-00	Bearing Holder	1	457	D-034457-00	Extractor	1				
127	M-040127-00	Throttle Valve Handle Band	1	450	D-008450-00	Feed Screw Center	1	458	D-034458-00	Mt. Socket	1				
128	M-040128-00	Reverse Valve Rod	1	451	D-008451-00	Center Holder	1	459	D-034459-00	Socket Arbor	1				
135	D-026135-00	Reverse Valve Lever	1	453	D-008453-00	Feed Screw Handle	1	461	D-034461-00	Socket Nut	1				
174	D-026174-00	Small Screw	1	454	D-008454-00	Feed Screw	1	722	D-034722-00	Leather Packing	1				
				455	D-008455-00	Feed Sleeve	1	H04	K-4412	Key	1				
				456	D-008456-00	Feed Sleeve Nut	1								
				457	D-008457-00	Extractor	1								
				458	D-008458-00	Mt. Socket	1								

□ The related parts are shown in a thick frame.
 □ #197 and #209 are supplied together with parts shown in ().
 □ Specify parts number and quantity when ordering.