

## FEATURES

- All Fluids compatible
- Mechanical resistance
- Silicon free

# RS PRO MALE HOSE ADAPTER (PARALLEL) WITH O-RING

RS Stock No.: 2312545



RS PROfessionally Approved Products bring to you professional quality parts across all product categories. Our product range has been tested by engineers and provides a comparable quality to the leading brands without paying a premium price.

## Product Description

The RS PRO male hose adapter (parallel) with o-ring mainly used in compressed air, pneumatic automation, industrial water circuit applications. High performances in pressure and temperatures (+300°C). Available with sharp threads. RoHS and REACH compliant.

## General Specifications

<b>Coupling Type</b>	Straight
<b>Hose Connector Type</b>	Hose Adapter
<b>Body Material</b>	Brass
<b>Application</b>	Compressed Air, Pneumatic Automation, Textile, Packaging, Handling

## Mechanical Specifications

<b>Maximum Working Pressure</b>	75bar
<b>Threaded Connection</b>	3/8 in BSPP Male
<b>Thread Standard</b>	BSPP
<b>Thread Gender</b>	Male
<b>Connector Gender</b>	Male
<b>Hose Inner Diameter</b>	14mm
<b>Thread Size</b>	3/8in
<b>Length</b>	39.5mm
<b>Wrench Size</b>	19mm

## Similar Products

Parameters	2312502	2312503
Brand	RS PRO	RS PRO
Coupling Type	Straight	Straight
Body Material	Brass	Brass
Maximum Working Pressure	10bar	10bar
Connector Gender	Male	Male
Hose Inner Diameter	4mm	6mm
Hose Outer Diameter	11mm	11mm
Application	Compressed Air, Pneumatic Automation, Textile, Packaging, Handling	Compressed Air, Pneumatic Automation, Textile, Packaging, Handling

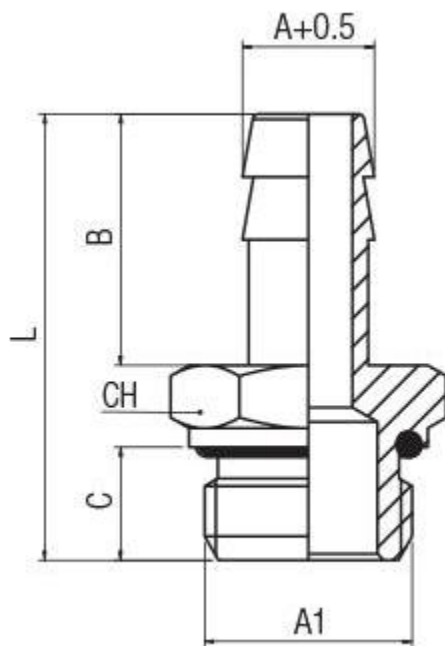

A	A1	B	C	L	CH	Pack.
14	3/8	24	9	39.5	19	10