



Datasheet

RS PRO XT60PW Female connector

Stock number: 180-5374

EN

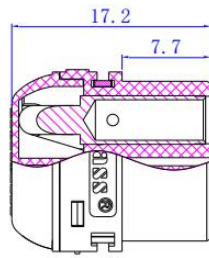
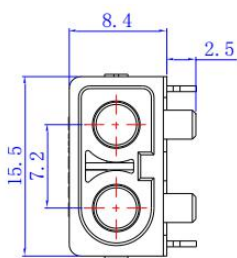

Section

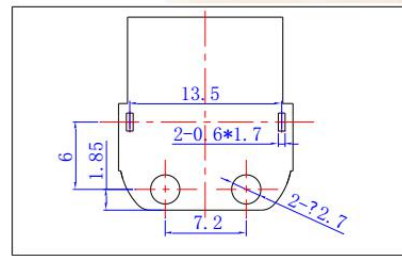

Installation hole diagram

Material & Parameter

Recommend USE :Battery/charger

Color: Yellow

Metal Material: Brass Gold Plated

Plastic Material: PA

FR Level: UL94 V0

Cable Spec: PCB

Certification: UL

Contact Resistance: 0.50mΩ

Rated Voltage: DC 500V

Rated Current: 45A

Momentary Current: 60A

Use Times: 1000 TIMES

Use Temperature: -20°C to 120°C

Remark: Data sheet will change according with the test background