



ENGLISH

Datasheet

Stock No: 394471

RS PRO Toggle Switch



Feature:

ON-NONE-ON

16.00 high

8.00 high,keyway, (thd)

Solder Lug

Silver

EPOXY (std)

RoHS & Lead Free

Code symbol:

2MS1

TL1

B25

M1

Q

E

S

▼ SWITCH FUNCTION

NO. POLES	UL/CSA MODEL NO.	MODEL NO.	SWITCH FUNCTION			CONNECTED TERMINALS / SCHEMATIC		
			POS.1	POS.2	POS.3	POS.1	POS.2	POS.3
SP	Q2211	2MS1	ON	NONE	ON	2-3	N/A	2-1
	Q2212	2MS2	ON	NONE	(ON)			
	Q2213	2MS3	ON	OFF	ON		OPEN	
	Q2214	2MS4	(ON)	OFF	(ON)			
	Q2215	2MS5	ON	OFF	(ON)	OPEN	N/A	3-1
	Q2216	2MS6*	OFF	NONE	ON			
DP	Q2221	2MD1	ON	NONE	ON	2-3,5-6	N/A	2-1,5-4
	Q2222	2MD2	ON	NONE	(ON)			
	Q2223	2MD3	ON	OFF	ON		OPEN	
	▲ Q2226	2MD6	ON	ON	ON			

()=MOMENTARY

▲ Please confirm the availability before order.

▼ POLE OPTIONS

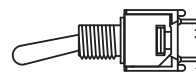
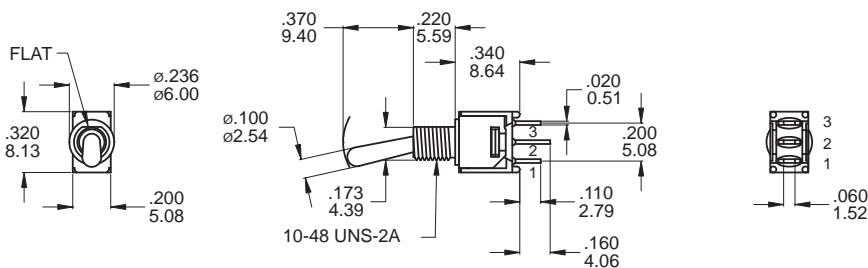

SPDT

Model name. 2MS1T1B1M1QES

* 2MS6 Models: Omit terminal 2

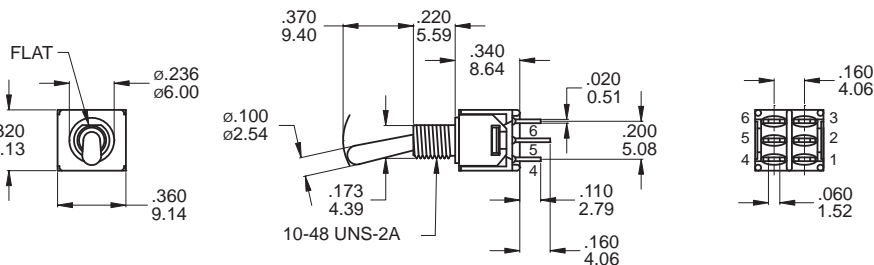

DPDT

Model name. 2MD1T1B1M1RES

2M Series

Sub-Miniature Toggle Switches



2M Toggle Switches

▼ ACTUATOR OPTIONS

T1

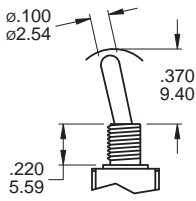

T2

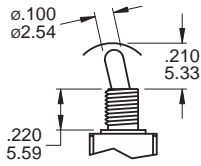

T3

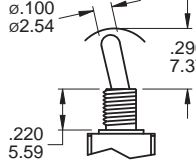

T4

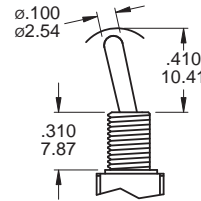

T5

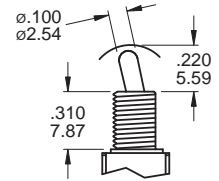

Note:

1. Above schematic T1, T2, T3 are shown with Bushing B1-B4.

For B5 Bushing: - .090inch(2.29mm)

For B7 Bushing: - .040inch(1.02mm)

2. T4, T5 Actuator are shown with Bushing B5, B6.

For B1-B3 Bushing: +.090inch(2.29mm)

For B7 Bushing: +.050inch(1.27mm)

3. T1~T5 Actuator are shown with Terminal M1 and M2.

For M6, M7, VSX: - .016inch(0.40mm)

TL1B25

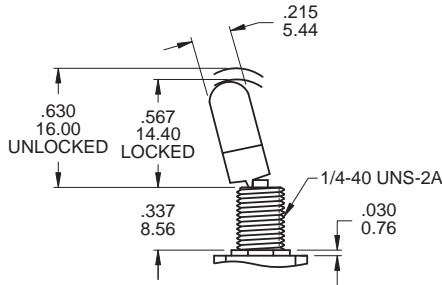

TL2B25

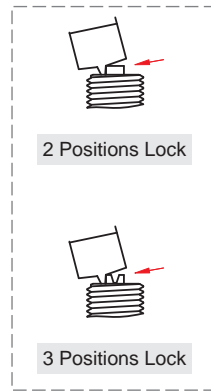
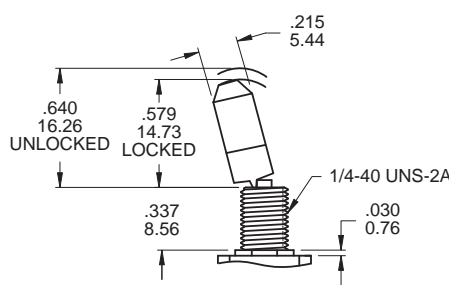

▼ BUSHING OPTIONS

B1 THD
B2 NON-THD

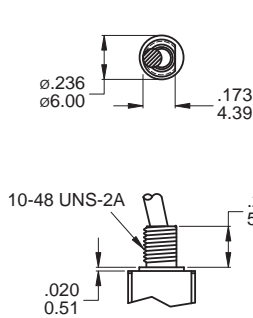

B3 THD
B4 NON-THD

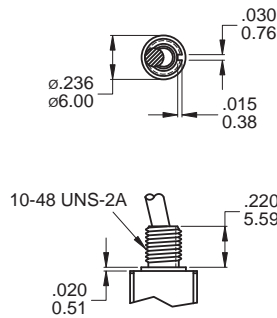

B5 THD
B6 NON-THD

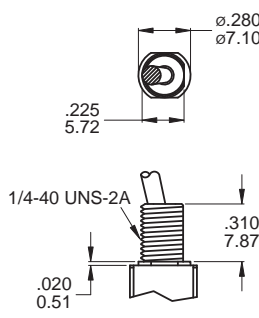

B7 THD
B8 NON-THD

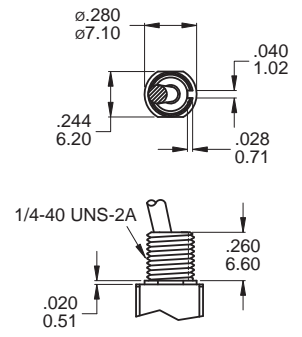

▼ PANEL MOUNTING

10-48 BUSHING

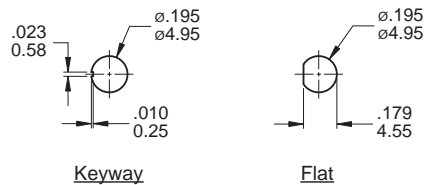

Keyway

Flat

Without locking ring

1/4 IN BUSHING

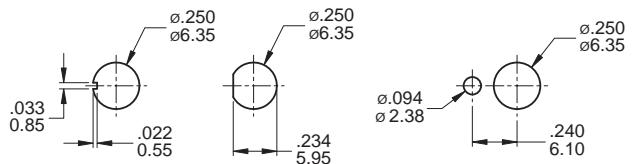

Keyway

Flat

Without locking ring

With standard locking ring

▼ TERMINAL OPTIONS

M1 Solder lug

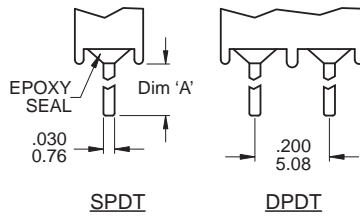
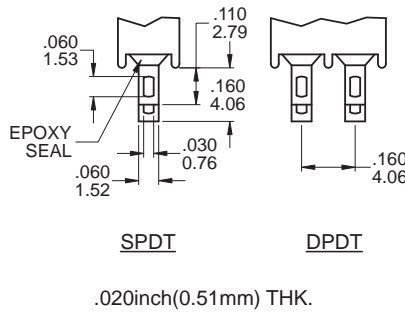

.020inch(0.51mm) THK.

TERMINAL	DIM. 'A'
M2 PC Thru-hole	.130 (3.30)
M51 Wire Wrap	.600 (15.24)

OTHER TERMINAL OPTIONS

- M6** Right angle P.C. Mount
- M6N** Right angle P.C. Mount Snap-in bracket
- M7** Vertical right angle P.C. Mount
- M7N** Vertical right angle P.C. Mount Snap-in bracket
- VS2-VS3** Vertical bracket P.C. Mount
- V2N-V3N** Vertical bracket P.C. Mount Snap-in bracket

M6 (M6N - Snap-in)

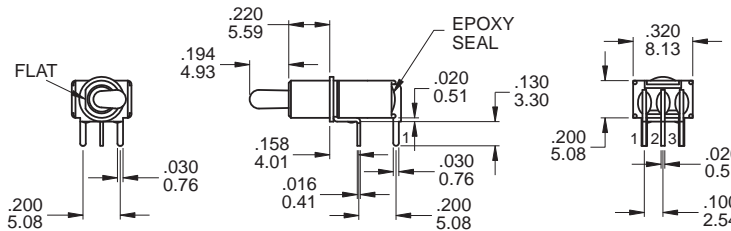

PCB MOUNTING

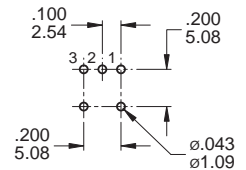

Note: Not available for 2MS6.

SPDT

Model name. 2MS1T2B2M6RES

M6

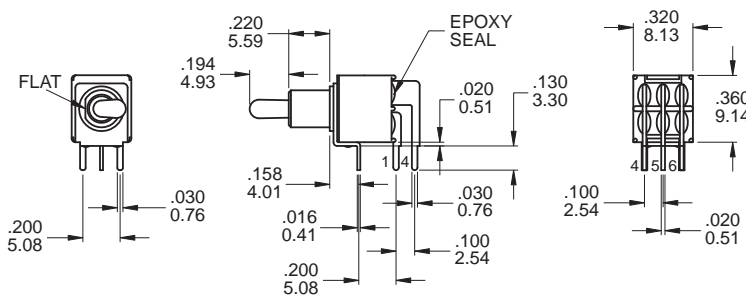

PCB MOUNTING

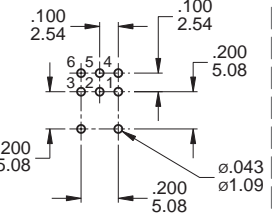

Note: Not available for 2MS6.

DPDT

Model name. 2MD1T2B2M6QES

M7 (M7N - Snap-in)

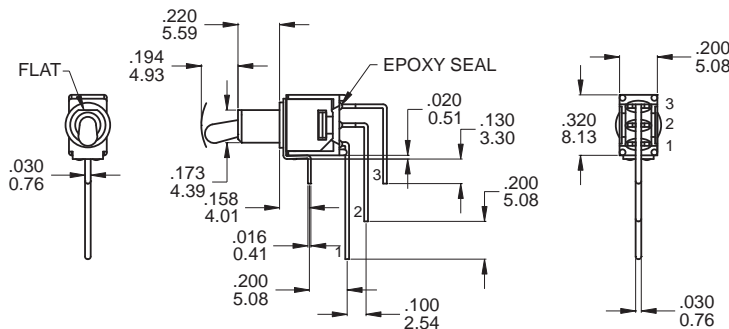

PCB MOUNTING

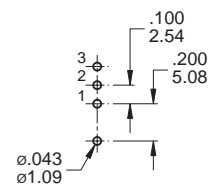

Note: Not available for 2MS6.

SPDT

Model name. 2MS1T2B2M7RES

▼ **HARDWARE**

EXAMPLE: -
 Model name. 5 Standard hardware

* Standard Hardware: 10-48 Bushing: 2 nut, 1 lockwasher
 1/4-40 Bushing: 2 nut, 1 locking ring, 1 lockwasher

10-48 NUT (Std.)

Model name. MNU-2M01

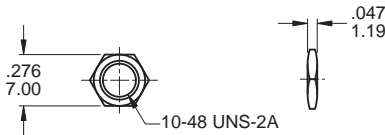

LOCKWASHER (Std.)

Model name. MNU-2M03

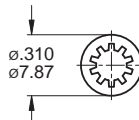

.018inch(0.46mm)THK

Available with bushing B1, B3 only.

LOCKWASHER (Std.)

Model name. MNU-1M03

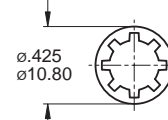

.018inch(0.46mm)THK

Available with bushing B5, B7 only.

1/4 NUT (Std.)

Model name. MNU--1M01A

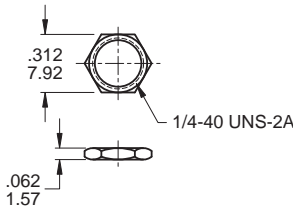

LOCKING RING (Std.)

Model name. MNU-1M02

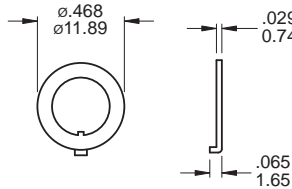

Available with bushing B7 only.

LOCKING RING (Std.)

Model name. MNU-1M11

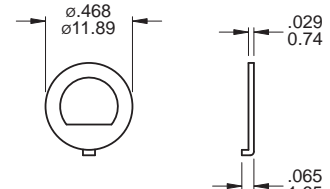

Available with bushing B5 only.

▼ **CONTACT & TERMINAL PLATING OPTIONS**

	CONTACT PLATING	TERMINAL PLATING	RATINGS
Q	Silver	Silver	3 Amps with resistant load @ 120VAC or 28VDC 1 Amps with resistant load @ 250VAC
C	Gold over Silver	Gold over silver	
R	Gold	Gold	0.4 Volt - Amps (VA) max. @ 20V max. (AC or DC)

▼ **SOLDERING PROCESS**

MANUAL SOLDERING: Use 30 watts soldering iron and controlled the temperature at 350°.

Duration of solder immersion: Max. 5 sec.

WAVE SOLDERING: Recommend soldering temperature: 260 ± 5°C

Duration of solder immersion: Max. 5 sec. (PCB thickness is 1.6mm)