

AI/DC5424

STANDARD INSTALLATION

Closer mounted on door on pull side

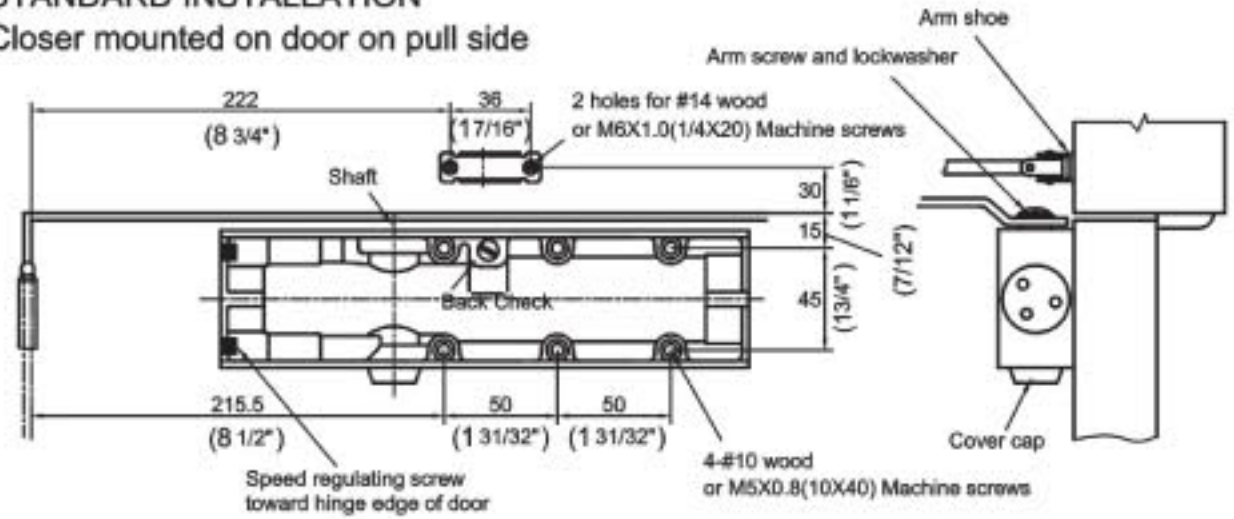

CLOSING POWER ADJUSTMENT

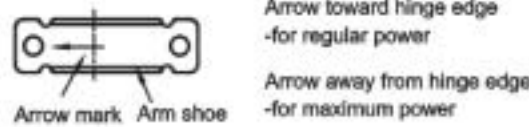

RIGHT HAND DOOR shown, Same dimensions apply for left hand door measured from hinge edge.

POSITION OF ARMS AND INDEX SETTINGS

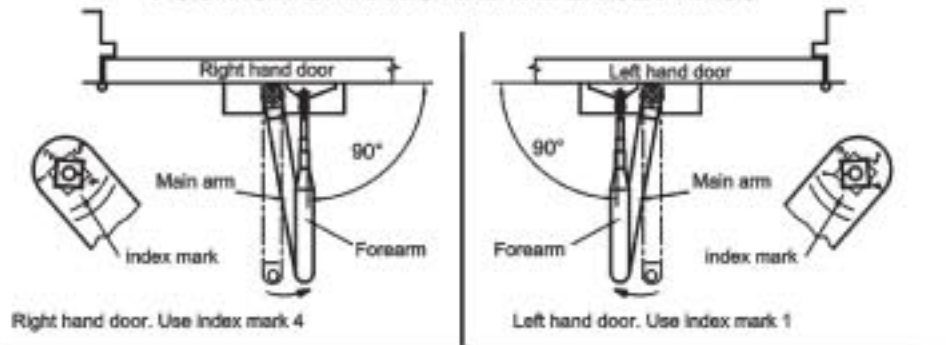

TOP JAMB INSTALLATION

Closer mounted on top jamb on push side of door.

Reveals of 70(2 3/4") to 127(5") requires long top jamb forearms.

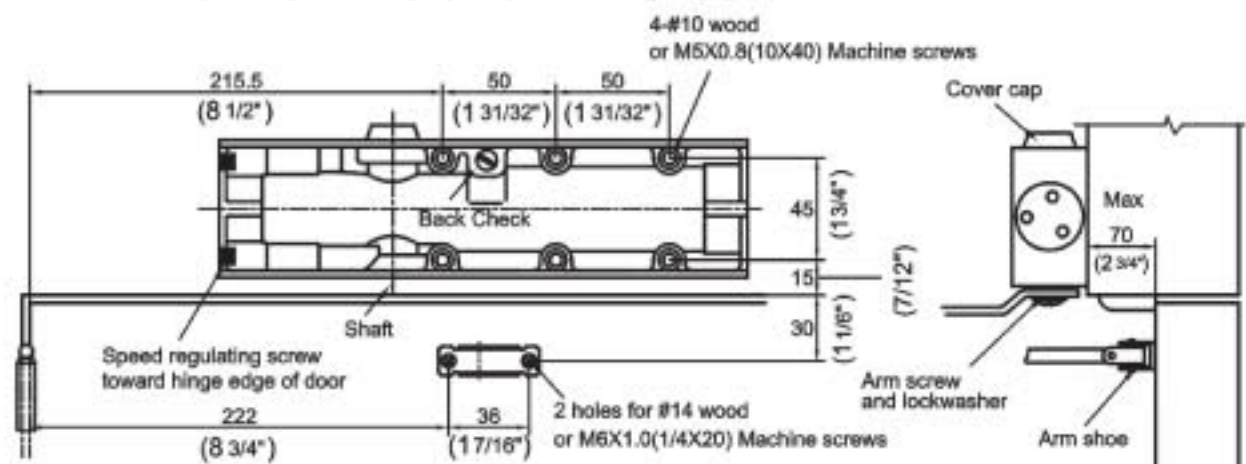

CLOSING POWER ADJUSTMENT

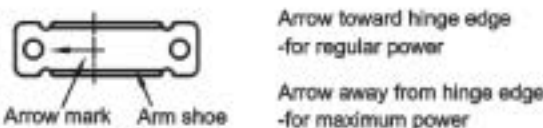

LEFT HAND DOOR shown, Same dimensions apply for right hand door measured from hinge edge.

POSITION OF ARMS AND INDEX SETTINGS

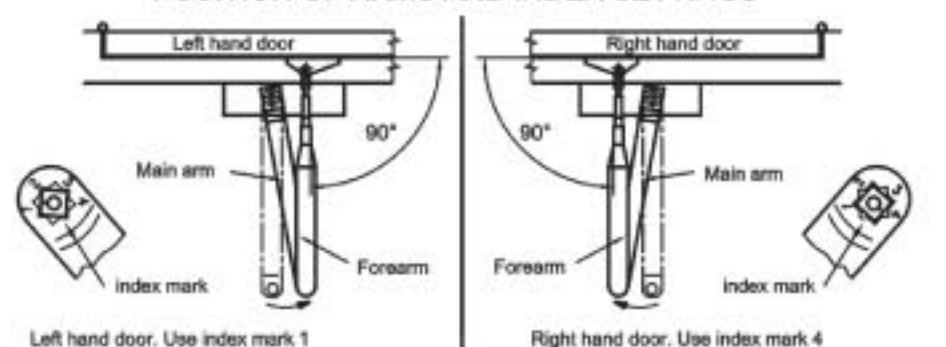

Top jamb of frame

CUT OFF HERE FOR TEMPLATE

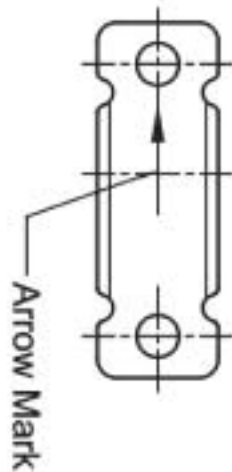

Standard Installation Template
For Right Hand Doors
Mounted on door on pull side

PARALLEL ARM INSTALLATION

Closer mounted on door on pull side

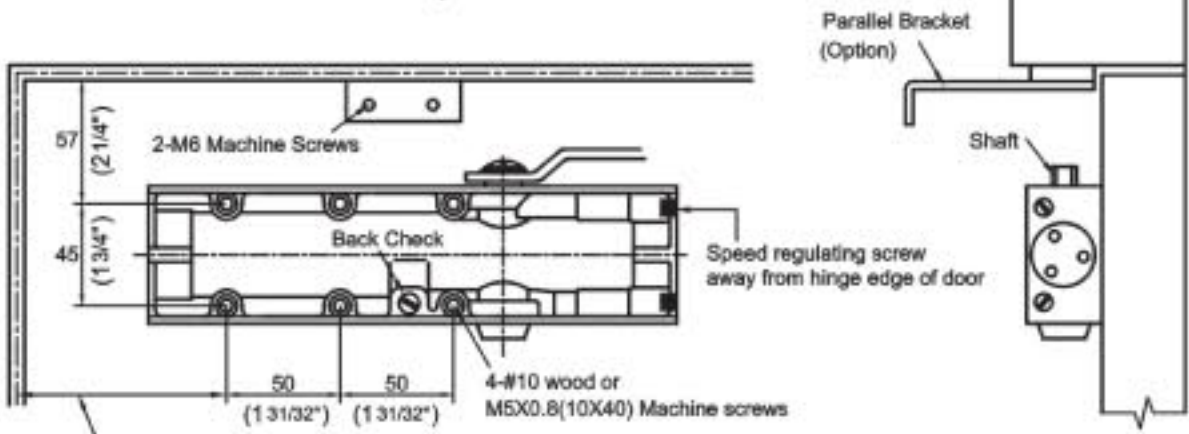

for opening to 150° -64(2 1/2")

for opening to 150° -160(6 5/16")

LEFT HAND DOOR shown, Same dimensions apply for right hand door measured from hinge edge.

Using a wrench on the square shaft on bottom of closer, rotate shaft approximately 45° toward hinge edge of door. Hold and place main arm on shaft on top of closer at proper index mark as illustrated. FOR LEFT HAND DOOR NO. 3 (illustration "A"). FOR RIGHT HAND DOOR NO. 2 (illustration "B"). Tighten arm screw with lockwasher securely.

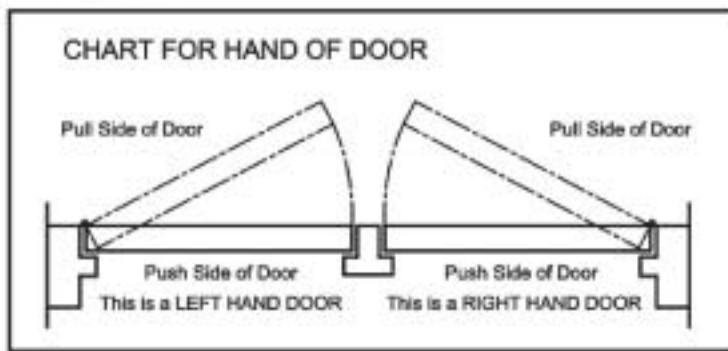
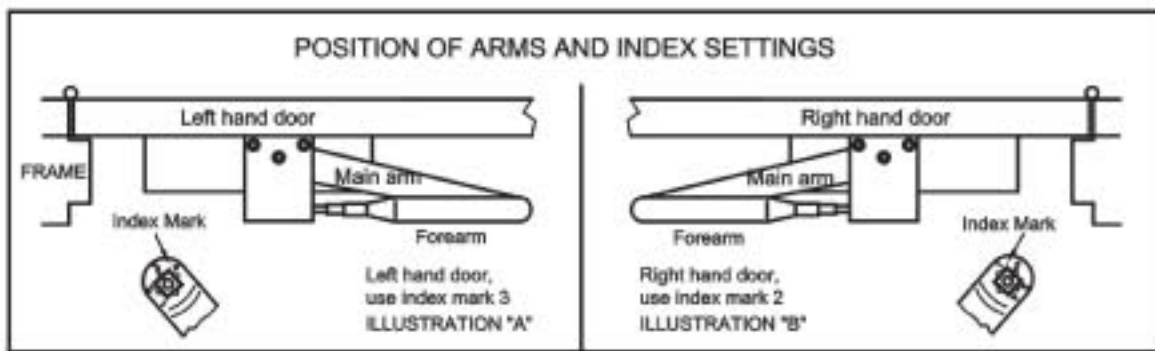

SPRING POWER & VALVE ADJUSTMENT

- A. CLOSING RANGE 150° -15"
- B. LATCHING RANGE 15° -0"
- C. BACKCHECK RANGE 70° -150"

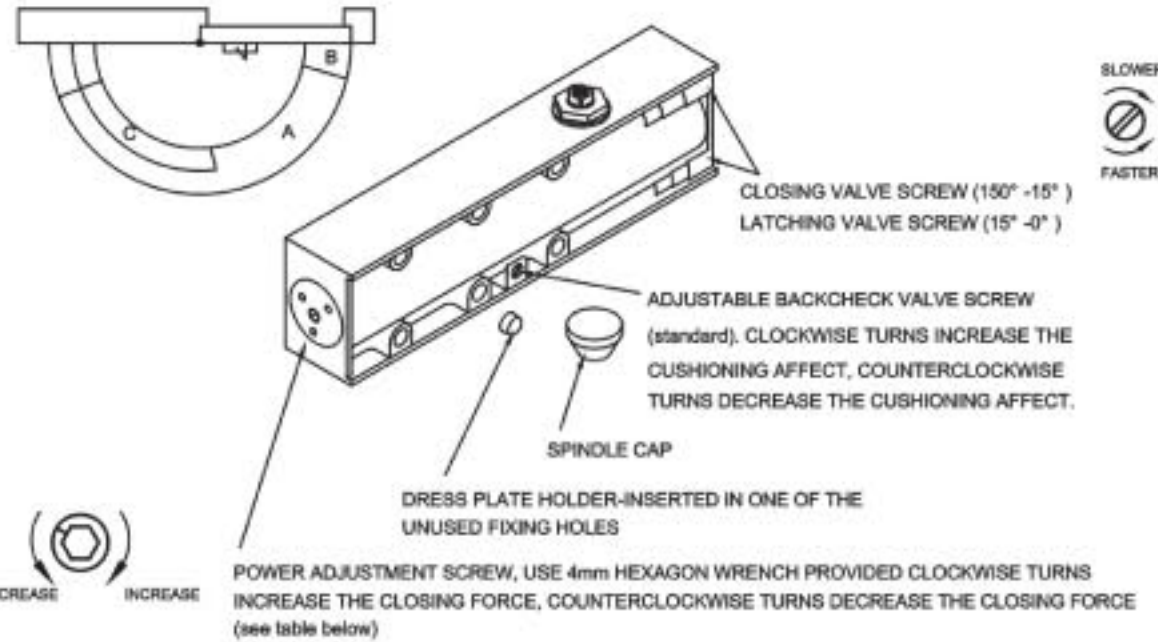

SIZE	NO. OF TURNS	DIRECTION
2	6	COUNTERCLOCKWISE
3	0	FACTORY PRESET
4	5	CLOCKWISE

CE

1121 AD6652 EN1154: 1996 + A1: 2002 3 8 1 1 1 3

Model Number: Owlitt Architectural AIDC5424

- AFTER INSTALLATION PLEASE CHECK AND TEST:**
- Open the door leaf to its maximum opening angle and release. The door leaf should close fully into door frame and against the lock.
 - Open the door leaf and rest the lock bolt against the strikeplate. Release the door leaf. The door closer should have sufficient power to seal the lock.
- WARNING:**
- In accordance with Approved Document B requirements, Power open 1 & 2 are not suitable for use on Fire/Smoke/Glass Assemblies. The minimum closing cycle power size required is 3.
 - Mechanical Hold Open devices MUST NOT be installed on Fire/Smoke/Glass Assemblies.
 - To a Unit Must not be opened beyond its maximum opening angle and latched in above table.
 - The Door Closer contains a powerful spring mechanism which is inserted into the main body under pressure, under no circumstances should any attempt be made to dismantle the unit.
- MAINTENANCE:**
- Please ensure you check the operation and timing of the unit every 3 months to a check performance, and adjust as necessary, also the latching speed/closing speed as necessary to enable the unit to lock on securely in accordance with requirements of BS EN 1154:1996.
 - Apply light oil to arms & bearing joints to ensure smooth operation.

CUT OFF HERE FOR TEMPLATE

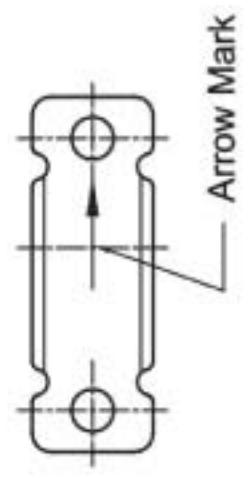

Top jamb of frame

