

Datasheet

# SPECIFICATION BL/D6636/01

## DRAIN PLUG AND PANEL BUSH ADAPTOR

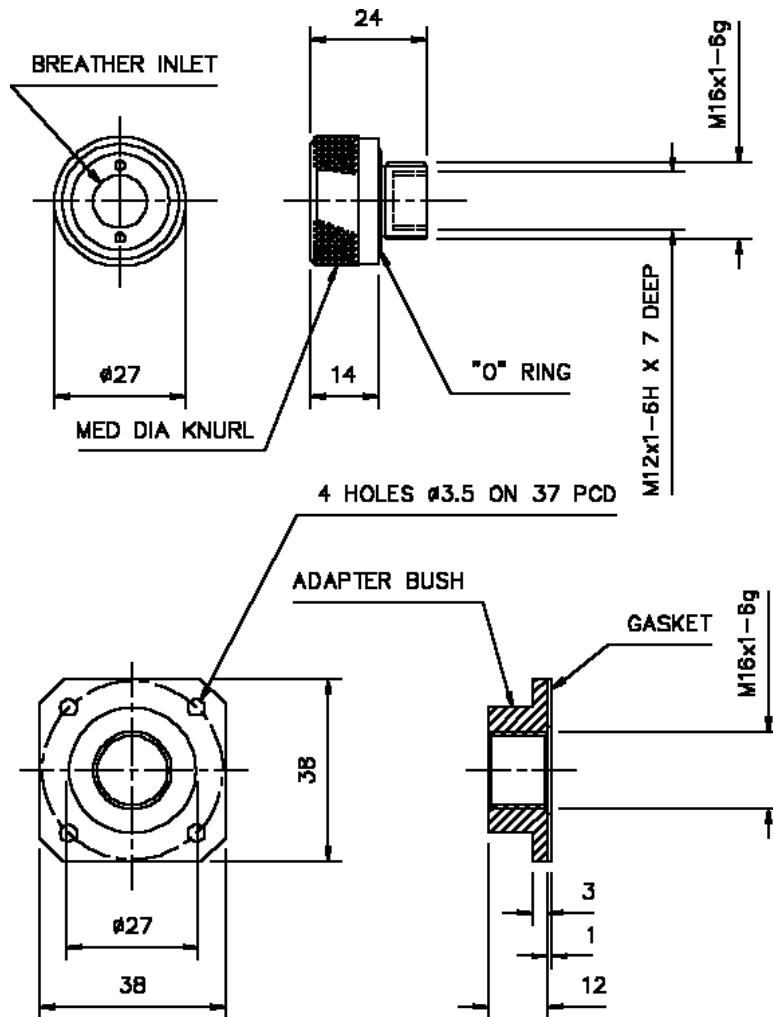

### DESCRIPTION

A Drain Plug and flanged bush adaptor provided for fixing to panels and equipment to enable the drain plug to be mounted and de-mounted from outside of the equipment.

### APPLICATIONS

Ideally suited for mounting Drain Plugs, which require removal without opening the equipment. Their use affords the minimum protrusion within the equipment and allows unimpeded flow of fluid due its under flush mounting.



ENGLISH

<b>PART NUMBER</b>	BL/D6636/01
<b>MATERIAL</b>	Plastic (Polycarbonate)
<b>COLOUR</b>	Black
<b>OPERATING TEMPERATURE</b>	Maximum 70°C Minimum -40°C
<b>ENVIRONMENTAL PROTECTION</b>	Resistant to Alcohols, Ethers, weak acids and bases.
<b>ADAPTOR THREAD SIZE</b>	M16 x 1 - 6g
<b>TIGHTENING TORQUE</b>	(Of Drain Plug) 2Nm
<b>PACKAGING</b>	Sealed polythene bag.