



# Datasheet

## RS PRO

Stock number: 1774525

EN



- ◆ CI10 has a built-in rocker switch to control the operation for one actuator; no additional handset is required.
- ◆ Main applications : industrial automation
- ◆ Input voltage : 230V AC 50Hz
- ◆ Output voltage : 24V DC
- ◆ Max. current : 10A @ 24V DC
- ◆ Overload protection current : 13A
- ◆ Max. number of actuators this control box can drive : 1
- ◆ Duty cycle : 10% or 2 min continuous operation in 20 min.
- ◆ Color : Pantone 432U
- ◆ Cable type : power cord
- ◆ Cable length : 3000mm
- ◆ Emergency stop button
- ◆ Power indicator LED
- ◆ 2<sup>nd</sup> output for supplementary device : 24V DC @350mA.

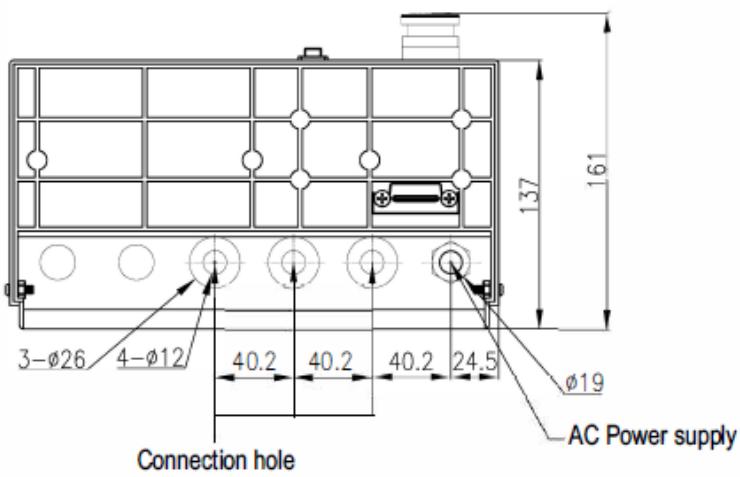
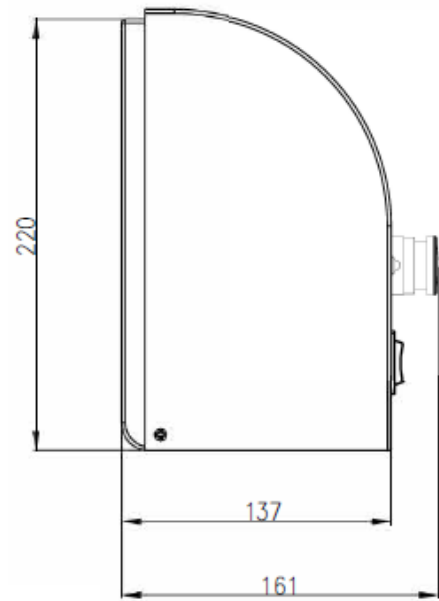
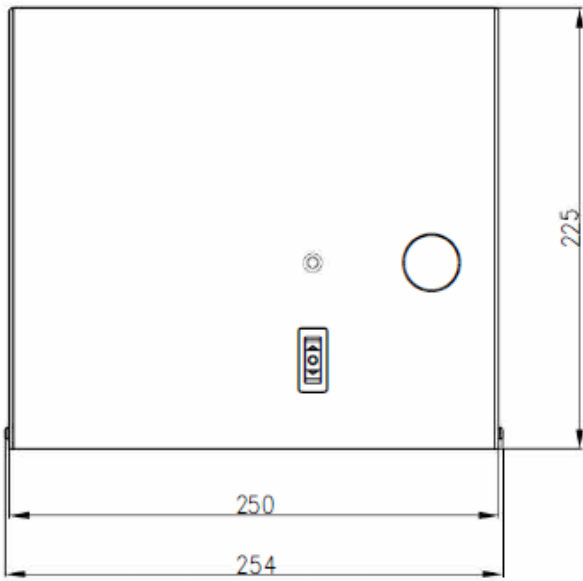

Unit: mm

# Ordering Key

CI10—□□□—24—1—□—□

Type

Input Voltage

230 : 230V AC

Output Voltage

24 : 24V DC

Number of Motors

1 : for 1 actuator

Power Cord Length

1 : 3000mm

Power Plug Type

UK plug