



ENGLISH

## Datasheet

# RS PRO 2 WAY, 1 ROW, STRAIGHT, SPRING LOADED MALE, .100" [2.54mm] PITCH, SMT

Stock No: 2272136, 2272137



## Product Details:

RS PRO Pogo Pins and Connectors (spring loaded terminals) consist of a pin, barrel, and steel spring with or without an insulator carrier. They are used in many industries across a wide range of applications to make a secure, high reliability connection. This series is highly customizable to meet specific stroke lengths, heights, and electrical capabilities. High-temp plastics are used for our insulators and unlimited molding designs allow for many different shapes and styles to be created for specific applications.

## Features & Benefits:

- High reliability, corrects connection between uneven surfaces and satisfies high vibration connection requirements.
- Increased durability for heavy duty applications Highly Customizable-
- Size, stroke, shape, pin count, etc.
- Low Cost and Easily Integrated

**Material:**

Insulator: PA46, rated UL 94V-0, Color: Black

Contacts: Copper Alloy

Spring: Stainless Steel

Plating:

Gold flash over Nickel underplate overall

**Electrical:**

Voltage rating: 12 Volts

Current rating: 1A max (3.30mm), 3A max (4.30&5.30mm)

Contact resistance @ working stroke: 20 mohms max. before test  
60 mohms max. after test

Insulation resistance: 100 Mohms min

Dielectric withstanding voltage: 100 VRMS @ 60HZ

**Mechanical:**

Spring force: 90±20gf @ 1.0mm working stroke (3.30mm)

70±20gf @ 1.0mm working stroke (4.30 & 5.30mm)

Full stroke: 1.40mm

Life test: 10,000 Cycles Min

**Temperature Rating:**

Operating temperature: -30°C to +85°C

**Environmental:**

Lead free, RoHS compliant.

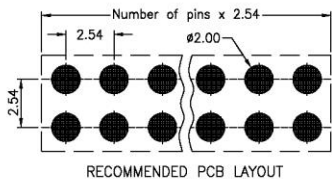
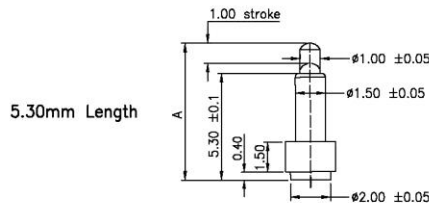
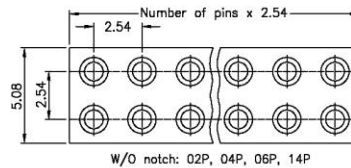
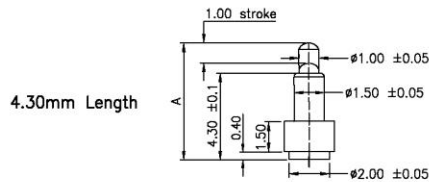
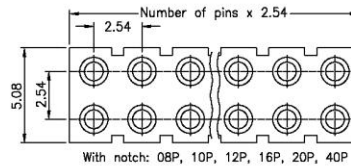
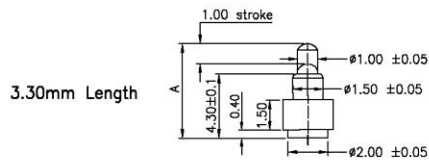
**Dimensional line drawings**

3.30mm Length

Example: PH2-3B-08-MVF-3345 = 2X4 PIN

| ADAM P/N           | Initial Height |
|--------------------|----------------|
| PH2-3B-XX-MVF-3345 | 4.5mm          |
| PH2-3B-XX-MVF-3350 | 5.0mm          |

4.30mm Length

Example: PH2-3B-08-MVF-4355 = 2X4 PIN

| ADAM P/N           | Initial Height |
|--------------------|----------------|
| PH2-3B-XX-MVF-4355 | 5.5mm          |
| PH2-3B-XX-MVF-4360 | 6.0mm          |

5.30mm Length

Example: PH2-3B-08-MVF-5365 = 2X4 PIN

| ADAM P/N           | Initial Height |
|--------------------|----------------|
| PH2-3B-XX-MVF-5365 | 6.5mm          |
| PH2-3B-XX-MVF-5370 | 7.0mm          |
| PH2-3B-XX-MVF-5375 | 7.5mm          |
| PH2-3B-XX-MVF-5380 | 8.0mm          |



[rspro.com](http://rspro.com)

