

Assembly of other products using:
body/contact assemblies: see page 36068/2
accessories: see page 36069/2

Selector switches with standard handle (1)
Screw clamp terminal connections (Schneider Electric anti-retightening system)

Shape of head	Type of operator	Type of contact		Positions		Reference	Weight kg
		N/O	N/C	Number	Type		

Complete units

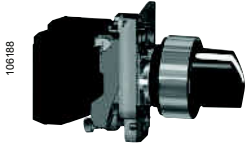

XB4 BD33

	Standard handle, black	1	–	2-position 90°	Stay put		XB4 BD21 (ZB4 BZ101 + ZB4 BD2)	0.095
		1	–		Spring return from right to left		XB4 BD41 (ZB4 BZ101 + ZB4 BD4)	0.100
		1	1		Stay put		XB4 BD25 (ZB4 BZ105 + ZB4 BD2)	0.095
		2	–	3-position ± 45°	Stay put		XB4 BD33 (ZB4 BZ103 + ZB4 BD3)	0.095
					Spring return to centre		XB4 BD53 (ZB4 BZ103 + ZB4 BD5)	0.095

Heads only



ZB4 BD4

	Standard handle, black			2-position 90°	Stay put		ZB4 BD2	0.040
					Spring return from right to left		ZB4 BD4	0.045
				3-position ± 45°	Stay put		ZB4 BD3	0.040
					Spring return to centre		ZB4 BD5	0.040
					Spring return from left to centre		ZB4 BD7	0.040
					Spring return from right to centre		ZB4 BD8	0.040

Heads only with other coloured handles

	Standard handle, white	add suffix 01 to the reference, example: ZB4 BD201
	Standard handle, green	add suffix 03 to the reference, example: ZB4 BD203
	Standard handle, red	add suffix 04 to the reference, example: ZB4 BD204
	Standard handle, yellow	add suffix 05 to the reference, example: ZB4 BD205
	Standard handle, blue	add suffix 06 to the reference, example: ZB4 BD206

Heads with black metal bezel

For heads with standard black handle only. To order, add the suffix 7 to the references selected from above. Example: **ZB4 BD2** becomes **ZB4 BD27**.

(1) Recommended maximum number of contacts and sequence of contacts constituting the body (fixing collar + contact) associated with the head, see page 36072/2.