



**1455 Kleppe Lane, Sparks, NV 89431-6467 * (775) 359-4712 * fax: (775) 3597424
** Bachweg 3, CH-3401 Burgdorf, Switzerland * (34) 423 2300 * fax: (34) 423 2301
** 74, Sungei Kadut Loop, Singapore 729513 * (65) 6367 0359 * fax: (65) 6269 4110
* e-mail: hawsmfg@singnet.com.sg website: www.hawesco.com

SP65

Specifications

AXION MSR™ eye/face head is antimicrobially treated using the natural protection of silver.

Impregnating these components with silver helps protect the head against the growth of mold and mildew on the treated components.

AXION MSR™ is the only eye/face product on the market to feature antimicrobial protection.

Inverted directional flow with laminar flow

Integral 3.7 gpm flow control, along with a yellow plastic pop-off dust cover.



** picture shown after installation and for illustration purpose only*

Disclaimer:

Illustrations, detail drawings and accompanying descriptions describe standard features and sometimes optional variations of each product. They do not necessarily show or describe all the variations available. All designs are subject to change without notice and unless stated in the order, material will be furnished of design in effect at the time the order is filled. As may be necessary, we reserve the right to substitute materials and/or to make changes in design or other specification, as shown and described in any of our printed literature, without liability to purchasers.

Notice: Model shown meet **ANSI** standard and **OSHA** rules and regulations relating to this type of product. Units should be tested regularly.

INSTALLATION/ RETRO FIT STEPS

1. IF REPLACING AN EXISTING EYEWASH ASSEMBLY WITH SP65 FOLLOW STEPS 2 THROUGH 5
IF INSTALLING SP65 ON NEW UNIT FOLLOW STEPS 3 THROUGH 5
NOTE: NOT FOR USE ON ANY FREEZE RESISTANT UNIT; i.e. 8300FP, 8300.158, 7433FP, 8317CTFP, 8317CTFP-220V, AND 8317CTFP-1D1.
- 2 REMOVE EXISTING EYEWASH BY SPINNING EYEWASH TEE COUNTER CLOCKWISE.
DO NOT REMOVE BRASS NIPPLE FROM BOWL HOLDER.
- 3 PLACE SP65 ADAPTER THROUGH DUST COVER LOOP. THREAD SP65 ADAPTER ONTO BRASS NIPPLE UNTIL SNUG AGAINST STRAINER.
- 4 THREAD SP65 ONTO ADAPTER. ORIENT TAB TOWARDS THE BACK (AWAY FROM USER). DO NOT OVER-TIGHTEN.
- 5 PLACE DUST COVER ONTO EYEFACE WASH

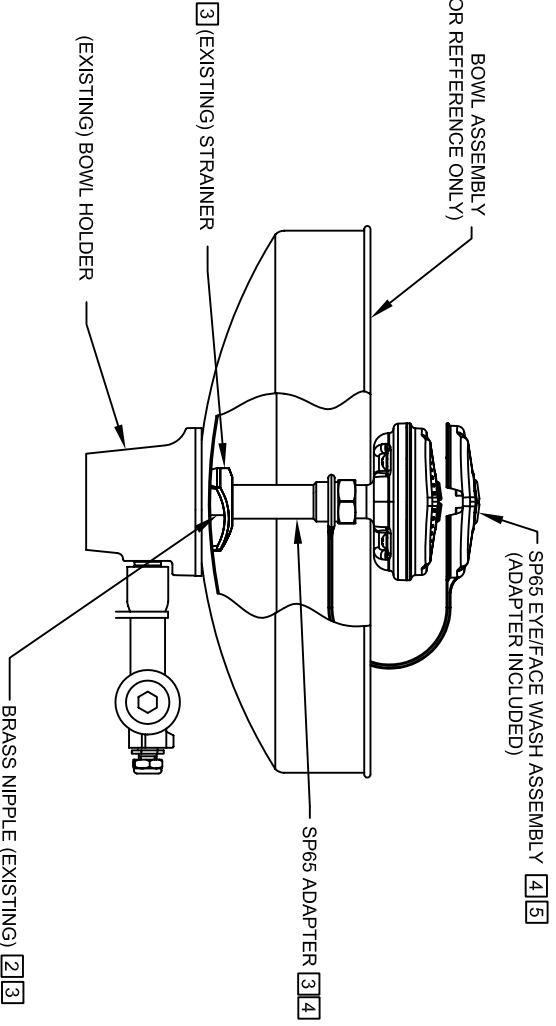
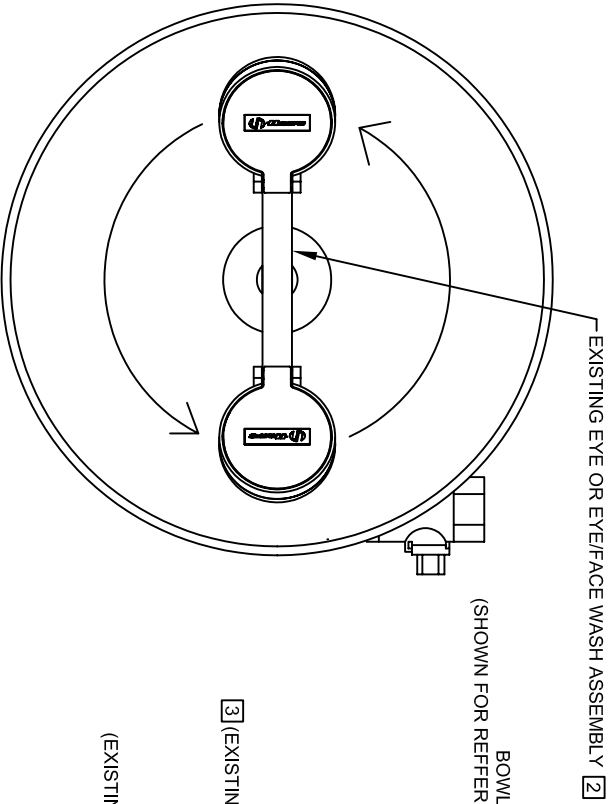
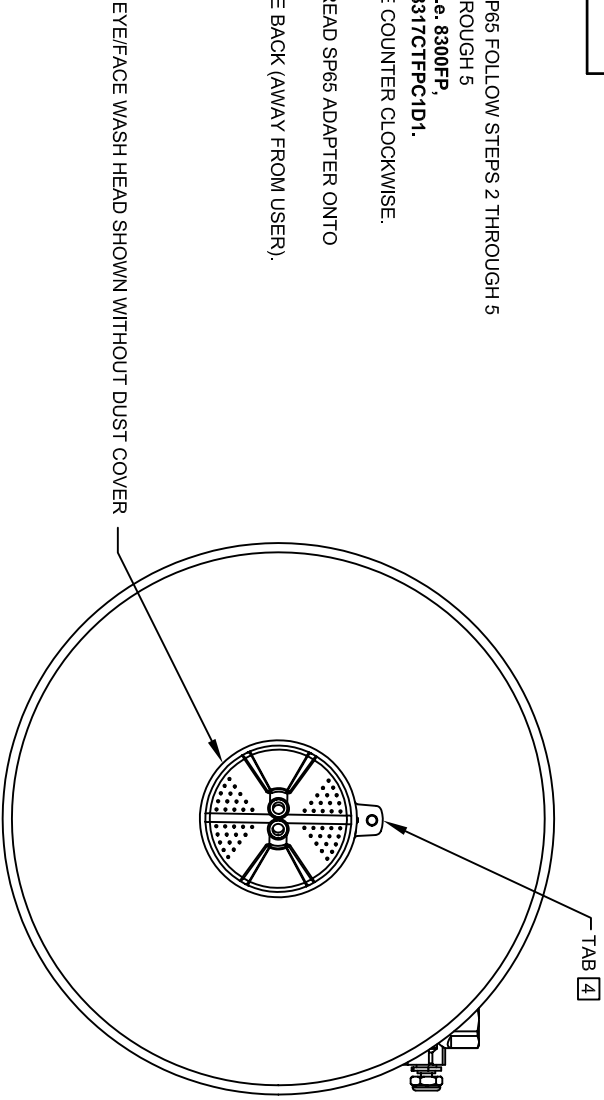

SEE SHEET 2 OF 2
FOR FLOW CONTROL
CLEANING STEPS



1455 KLEPPE LANE
SPARKS, NEVADA 89431
(775) 359-4712 FAX (756) 359-7424
E-MAIL: HAWS@HAWS.CO.COM
WEBSITE: WWW.HAWS.CO.COM

ECON. NO. REVISED PER BY:		MODEL(S)	
4109	ECON:4511	HM	
DRAWN:	DATE:	CHKD:	
L.ROBERTS	10/24/08		
APPROVER:	DATE:		
SCALE: 1/18		DRAWING TYPE:	INSTALLATION
SIZE: A		SHEET	1 OF 1
PART NUMBER		DRAWING NO.	REV
0002077031		15342A00	6

EYE/FACE WASH HEAD HAS 2 LARGE OPENINGS (FOR EYES) AND MULTIPLE SMALLER OPENINGS (FOR FACEWASH) [2]

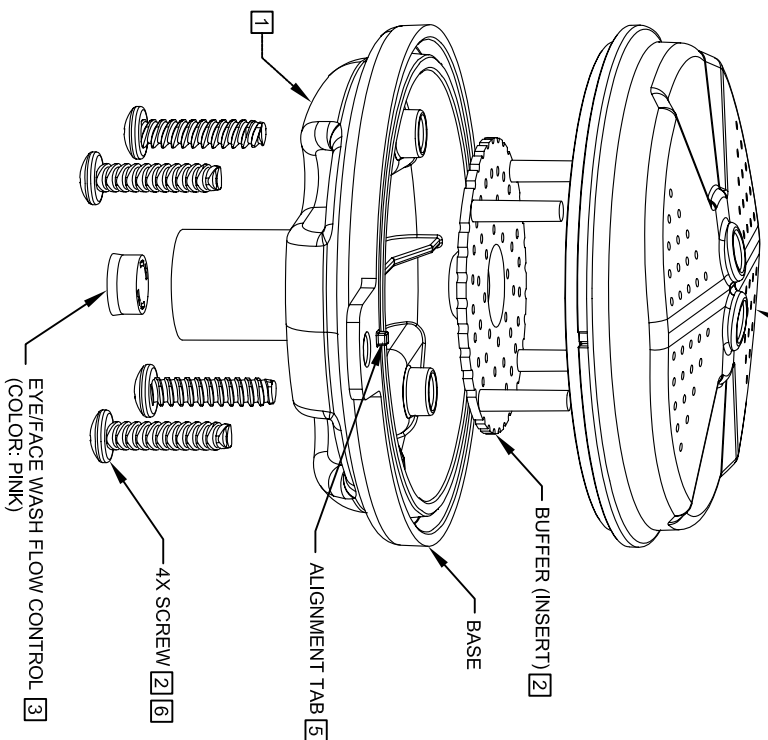

FLOW CONTROL SHOWN IN PLACE
NOTE: PRESS FLOW CONTROL IN
UNTIL IT BOTTOMS OUT

3 DETAIL A

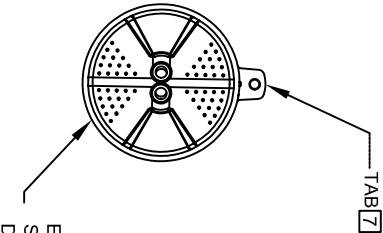

FLOW CONTROL CLEANING STEPS:

- 1 UNSCREW EYE/FACE WASH ASSEMBLY FROM ADAPTER.
- 2 REMOVE SCREWS (QTY. 4) FROM SP65 EYE/FACE WASH ASSEMBLY. REMOVE EYE/FACE WASH HEAD AND BUFFER (INSERT).
- 3 REMOVE EXISTING FLOW CONTROL FROM BASE. BY PUSHING IT OUT FROM THE TOP AND CAREFULLY REMOVE ANY DEBRIS LODGED BETWEEN O-RING AND HOUSING OR OPENINGS. ALSO, CHECK FOR ANY SEDIMENT OR MINERAL DEPOSITS BLOCKING OPENINGS. EXERCISE CAUTION NOT TO DAMAGE OR LOSE O-RING IN THE PROCESS. ALL OPENINGS ON FLOW CONTROL MUST BE FREE AND CLEAR OF ANY OBSTRUCTIONS FOR FLOW CONTROL TO FUNCTION PROPERLY. REINSTALL FLOW CONTROL. SEE DETAIL A FOR ORIENTATION.
- 4 INSERT BUFFER (INSERT) INTO EYE/FACE WASH HEAD NOTING ORIENTATION OF POST IN RELATIONSHIP TO ALIGNMENT GROOVE AS SHOWN ON DETAIL B.
- 5 REINSTALL EYE/FACE WASH HEAD MAKING SURE THAT ALIGNMENT GROOVE ON EYE/FACE WASH HEAD LINES UP WITH ALIGNMENT TAB ON BASE.
- 6 REINSTALL SCREWS (QTY. 4) INTO THE EYE/FACE WASH ASSEMBLY.
- 7 REASSEMBLE SP65 EYE/FACE WASH ASSEMBLY ONTO ADAPTER. ORIENT TAB TOWARDS THE BACK (AWAY FROM USER). DO NOT OVER-TIGHTEN.
- 8 PLACE DUST COVER ONTO EYE/FACE WASH.

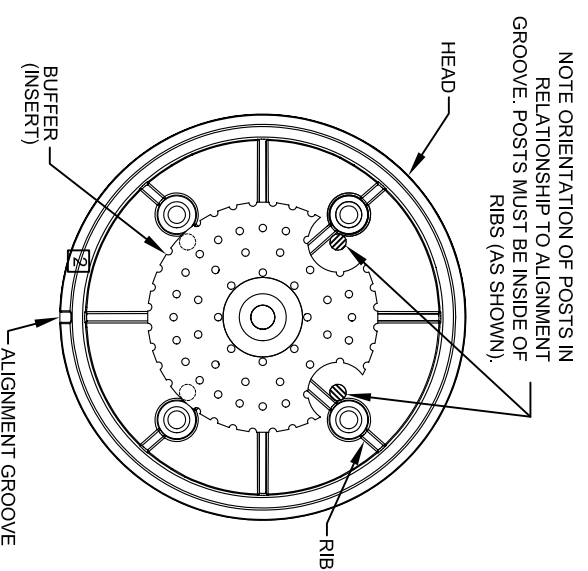

4 DETAIL B

SEE SHEET 1 OF 1
FOR INSTALLATION/
RETROFIT STEPS

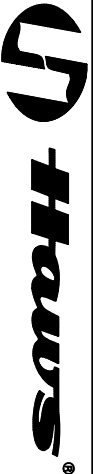

1455 KLEPPE LANE
SPARKS, NEVADA 89431
(775) 359-4712 FAX (755) 359-1424
E-MAIL: HAWS@HAWS.CO.COM
WEBSITE: WWW.HAWS.CO.COM

ECON. NO. REVISED PER BY:		MODEL(S)		PART NUMBER	
4109	ECON:4511	HM	SP65 AXION EYE/FACE WASH	DRAWING NO.	RET
L. ROBERTS	DATE: 10/2/08	CHKD:		15342A00	6
APPROVER:	DATE:	SCALE: 1:18		DRAWING TYPE: (SEE COMMENTS)	SIZE: A SHEET 2 OF 2