

Datasheet

Cat6 UTP Faceplate 2 Port

RS Stock number 791-8488

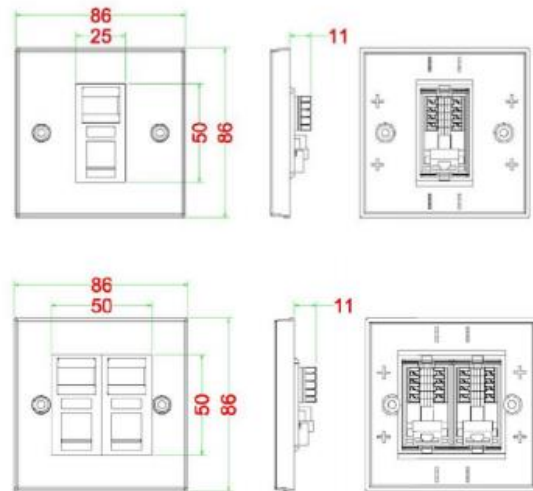

Specification

- Insulation Resistance: 500M ohms (min)
- Contact resistance: 20m ohms (max)
- Current Rating: 1.5 Amps
- DC Resistance: 1.5 Amps
- DC Resistance: 0.1 ohms (max)
- Withstanding Voltage: 1000 VAC RMS @ 60Hz / 1 min
- IDC Punch Down Cycle: Over 250 Cycles (min)
- Jack Insertion Cycle: Over 2000 Cycles (min)
- Operation Temperature: -40°C ~ +70°C