

## FEATURES

- Slimline adapter to protect interface ports
- Connector A is a D-sub, 15-pin (VGA) male connector
- Connector B is a D-sub, 15-pin (VGA) female connector
- Operating temperature range of -55°C to +105°C
- Tin-plated shell
- Brass contacts

## RS PRO D-sub Adapter Male 15 Way D-Sub to Female 15 Way D-Sub

RS Stock No.: 233-8925



RS Professionally Approved Products bring to you professional quality parts across all product categories. Our product range has been tested by engineers and provides a comparable quality to the leading brands without paying a premium price.

### Product Description

This slimline network adapter protects your interface ports from wear and tear caused by the plugging and unplugging of cables. It slots into any computer or peripheral with a 15-pin VGA port. If damage from wear and tear occurs, you can simply replace the adapter rather than having to replace the interface port.

### General Specifications

|                           |   |
|---------------------------|---|
| <b>Connector A</b>        | D-Sub, 15 Pin Male                              |
| <b>Connector B</b>        | D-Sub, 15 Pin Female                            |
| <b>Connector A Gender</b> | Male  |
| <b>Connector B Gender</b> | Female  |
| <b>Connector A Type</b>   | 15 Way D-Sub                                    |
| <b>Connector B Type</b>   | 15 Way D-Sub                                    |
| <b>Housing</b>            | PBT Glass fibre reinforced UL94VO               |
| <b>Contacts</b>           | Brass   |
| <b>Contact Plating</b>    | Gold Over Nickel                                |
| <b>Body Orientation</b>   | Straight  |
| <b>Accessory Type</b>     | Gender Changer                                  |
| <b>For Use With</b>       | 15 Way D-Sub Connector                          |
| <b>Applications</b>       | Helps enable devices like printers or scanners. |

### Mechanical Specifications

|               |         |
|---------------|---------|
| <b>Height</b> | 17.9mm  |
| <b>Length</b> | 31.11mm |
| <b>Width</b>  | 12.65mm |

### Operation Environment Specifications

|                                      |       |
|--------------------------------------|-------|
| <b>Maximum Operating Temperature</b> | 105°C |
| <b>Minimum Operating Temperature</b> | -55°C |

### Approvals

|                                  |         |
|----------------------------------|---------|
| <b>Compliance/Certifications</b> | EN61340 |
|----------------------------------|---------|

**SPECIFICATION**

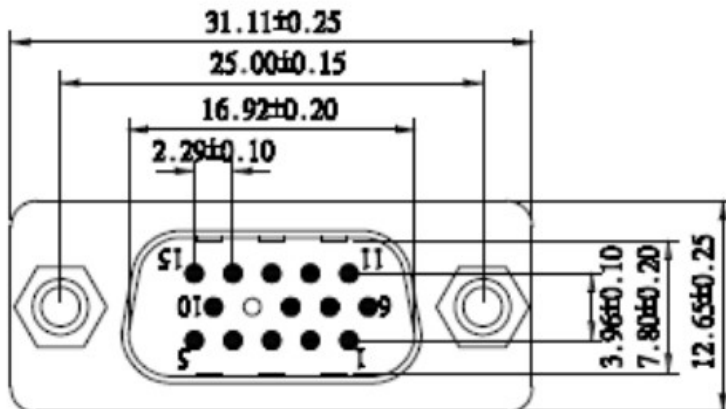
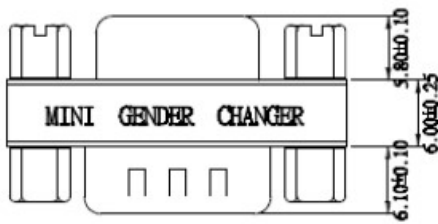
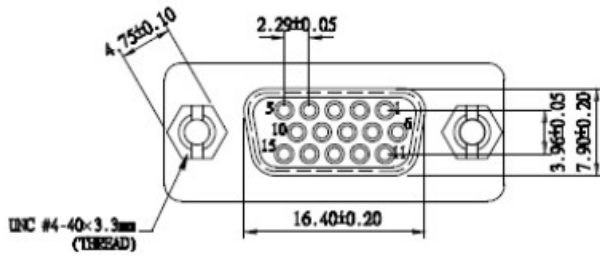

UNC #4-40 Hexscrew      UNC #4-40 Hexnut

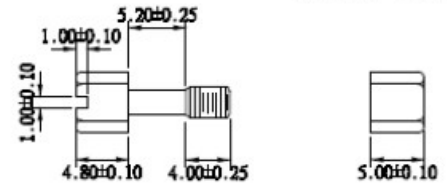

HGC 15M/F GENDER CHANGER

PIN OUT: 15Male

15Female

|    |       |    |
|----|-------|----|
| 1  | ----- | 1  |
| 2  | ----- | 2  |
|    | }     |    |
| 8  | ----- | 8  |
| 10 | ----- | 10 |
|    | }     |    |
| 15 | ----- | 15 |
| G  | ----- | G  |

**INSULATOR:** PBT Glass fibre reinforced UL 94 V0  
**CONTACT:** Brass  
**CONTACT PLATING:** Gold plated over nickel  
**SHELL:** Tin plated shell