



**ENGLISH**

**Waisted Mounts Male/Female**

This mount is designed with a waisted diameter specifically to achieve high vibration damping in both shear and compression.

**Applications:**

- Vibrating equipment & compactors
- Suspension of electronic equipment
- Small static electric motors and generators

H = Height  
 D = Diameter  
 G = Tread  
 L = Stud Length

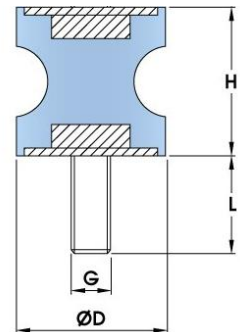

Item Code	Description	D (mm)	H (mm)	G x L (mm)	Max Compression Load (kg)	Max Shear Load (kg)
1265942	Waisted Mount (M/F) 95mm D x 75mm M16x41mm 60 Shore	95	75	M16x41	374	81
1265941	Waisted Mount (M/F) 60mm D x 60mm M10x25mm 60 ShA	60	60	M10x25	82	20
1265940	Waisted Mount (M/F) 40mm D x 30mm H M8x15 45 ShA NR	40	30	M8x15	23	6
1264334	Waisted Mount (M/F) 30mm x 20mm M8x20 60 ShA NR	30	20	M8x20	23	6
1264333	Waisted Mount (M/F) 20mm Dx 20mm H M6x18 55 ShA NR	20	20	M6x18	11	2.5