

Hand Type Pipe Cleaner



D-1 D-3H

Type	Spec.	Weight (kg)
D-1	Φ9.5 × 0.9m	1.1
D-2	Φ8 × 0.75m	0.9
D-3H	Φ12.7 × 0.9m	1.5

Ideal for quick and safe removal of obstructions in the toilet.
Specially desinged to traverse tough traps.
Vinyl guard protects damage to toilets.

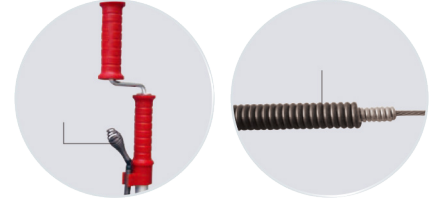

Specially desing to traverse tough traps. Three-tier comp site cable Anti-Kinking



GQ-38S GQ-50S

Applicable for household small pipes in lavatories, bathrooms and kitchens, different types are provided to choose.
Soft shafts are suitable for removing all kinds of complex indoor pipe blockages.
Soft flexible shafts are put in large metal barrels, to ensure cleaner and more convenient use.
Simple in structure, easy-to-handle. Release the locking screw, insert a soft shaft of certain length into the pipe, latch the lock and rotate the handle, and press it, repeated operation will easily remove the pipe blockages.



Type	Spec.	Weight (kg)
GQ-38S-1	Φ6 × 3m	1.3
GQ-38S-3	Φ6 × 6m	1.9
GQ-50S-2	Φ8 × 6m	3.5
GQ-50S-4	Φ10 × 6m	4.5

Handing Power Type



D-60Z



Applicable for both indoor and outdoor small pipes of Φ20-65mm in lavatories.
Using Φ8mm*7.6M enhanced inner core flexible soft shafts, the enhanced plastic cores are added to improve twisting transmission, against twisting torque and winding.
Entirely sealed structure, soft flexible shafts are put in large metal barrels, to ensure cleaner and more convenient use.
Shift with stepless 0-450 rpm speed adjustable, for adept passage through curved pipes.
Automatic device effect feeding and backing with maximum speed of 5m/min.
Motor power:800W, Rated voltage 220V;110V optional.

Type	Description	Weight (kg)
D-60Z	Including: Φ 8mm*7.6m Enhanced elastic soft shaft	6.9
F-6-b	Toolbox	0.6
F-9-c	Automatic device	0.5

Pumping Cleaner



D-10A



seal I seal II seal III

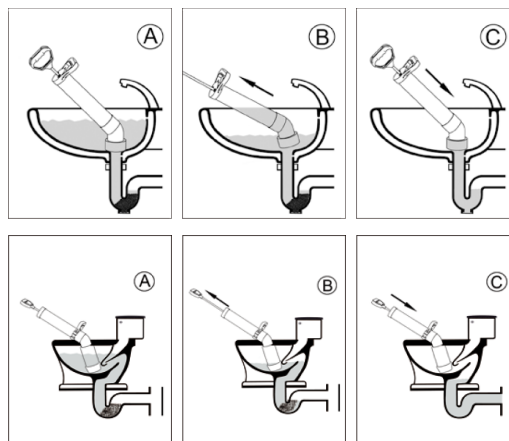

Easy and safe operation, can effectively remove blockages.

Push down the seal piston on the pipe opening, push and pull over again..

Type	Description	Weight (kg)
D-10A	Main machine	1.1
	seal I	0.2
	seal II	1.0
	seal III	0.3

Pneumatic Type Pipe Cleaner



GQ-4



F-9-e



F-9-f

Type	Description	Weight (kg)
GQ-4	Main machine	3.36
F-9-e	Air release extension pipe	0.47
F-9-f	Seal piston	0.98

Applicable for blockages in indoor facilities as in vegetable-rinsing basins, washing basins, kitchens, bathrooms and lavatories, and bathing facilities.

Easy and safe in operation. Inflate the pump with enough gas for the seriousness of the blockage, usually less than 0.4 Mpa; press the seal piston on the pipe opening and release quickly, the sudden air pressure will remove the blockages in the pipe.

The rubber seal piston can be used in both directions, for openings of different diameters and shapes. Using air release extension pipes will accommodate complex working environment.

Power Type Pipe Cleaner



Applicable for all kinds of indoor pipes of $\Phi 20-100\text{mm}$. Lightweight, strong, convenient, flexible in operation, soft shafts of $\Phi 8\text{mm}$, $\Phi 15\text{mm}$ and $\Phi 16\text{mm}$ can be used.

Soft shafts of $\Phi 8\text{mm}$ are used to clean pipes of $\Phi 20-75\text{mm}$ in diameter, with a cleaning length of 4.6 meters, especially applicable to complex pipes of small diameters like traps.

Soft shafts of $\Phi 15\text{mm}$ are used to clean small complex pipes.

Using sectional helical flexible shafts of $\Phi 16\text{mm}$, pipes of $\Phi 32-100\text{mm}$ in diameter can be cleaned, the soft shafts can be lengthened at will.

Press the clutch, the rotating speed is up to 400 rpm, and the soft shaft stops when the handle is released.

Rated Power: 250w.

Rated voltage: 220V, 110V optional, frequency of 50Hz, 60Hz options.



Type	Spec.	Description	Weight (kg)
GQ-75		Main machine	12.3
RH1-1	$\Phi 430 \times 120$	Including: a $\Phi 15\text{mm}$ soft shaft, 7 \times $\Phi 16\text{mm}$ soft shafts, a $\Phi 430$ soft shaft holder	0.6
FH1-1		Accessory barrel, 8 $\Phi 16\text{mm}$ drills, an $\Phi 8\text{mm}$ soft shaft combination, key	5.1
F-5-a		Protection gloves	

Power Type Pipe Cleaner



Applicable for all kinds of indoor pipes of $\Phi 20-150\text{mm}$. Multifunctional, heavy duty, compact structure, wide application scope, using soft shafts of $\Phi 8\text{mm}$, $\Phi 16\text{mm}$ and $\Phi 22\text{mm}$. Support is provided, to adjust the height and angle of the machine to accommodate different working environment.

Using soft shafts of $\Phi 8\text{mm}$, the cleaning diameter range is $\Phi 20-75\text{mm}$, cleaning length is 4.3 meters, especially suitable for small diameter pipes or complex pipes like traps. Using soft flexible shafts of $\Phi 15$, it is more suitable for small complex pipelines.

Using sectional helical flexible shafts of $\Phi 16\text{mm}$, pipes of $\Phi 32-100\text{mm}$ in diameter can be cleaned, the soft shafts can be lengthened at will, with a cleaning length up to 30 meters.

Using sectional helical flexible shafts of $\Phi 22\text{mm}$, pipes of $\Phi 50-150\text{mm}$ in diameter can be cleaned, the soft shafts can be lengthened at will. Press the clutch, the rotating speed is up to 400 rpm, and the soft shaft stops when the handle is released. Rated Power: 250w.

Type	Spec.	Description	Weight(kg)
D-160		Main machine	16.5
RH1-3	$\Phi 430 \times 120$	Including: a $\Phi 15\text{mm}$ flexible soft shaft, 5 \times $\Phi 16\text{mm}$ soft shafts, a $\Phi 430$ soft shaft holder	7.63
RH2-1	$\Phi 430 \times 120$	Including: 3 $\Phi 22\text{mm}$ soft shaft, a $\Phi 430$ soft shaft holder	11.67
FH1-2		Accessory barrel, 4 $\Phi 16\text{mm}$ drills, 4 $\Phi 22\text{mm}$ drills and an $\Phi 8\text{mm}$ soft shaft combination, $\Phi 4$ key	5.5
F-4-a		Stand	1.2
F-5-a		Protection gloves	

Electric Pipe Cleaner



Applicable for all kinds of outdoor pipes of $\Phi 50-200\text{mm}$.
 The choice type of multifunction, heavy duty type, the main machine and soft shafts have walking wheels, one man is capable of doing complex pipe cleaning jobs easily.
 Special drill suspenders are easy to maintain and use.
 Using sectional helical flexible shafts of $\Phi 30\text{mm}$, pipes of $\Phi 50-200\text{mm}$ in diameter can be cleaned, the soft shafts can be lengthened at will.
 Press the clutch, the rotating speed is up to 700 rpm, and the soft shaft stops when the handle is released.
 Rated Power: 750w
 Rated voltage: 220V, 110V, optional, frequency of 50Hz, 60Hz optional.

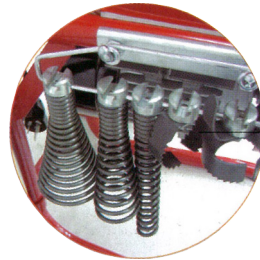

 NO:2.0213 T-1-C Straight Auger	 NO:2.0243 T-4-C Funnel Auger	 NO:2.0253 T-5-C Retrieving Auger	 NO:2.0273 T-7-C Grease Cutter	 NO:2.0283 T-8-C Sawtooth cutter	 NO:2.0273 T-9-C "C"- Cutter
 NO:2.2114 RH3-1 $\Phi 30\text{mm}$ Soft Shaft	 NO:2.3611 F-6-a Accessory barrel	 NO:2.0271 F-7-a Protection tube	 NO:2.0391 F-9-a Drill Shelf	 NO:2.0331 F-3-a Key	 NO:2.0351 F-5-a Protection gloves

Automatic Electric Drum Type Pipe Cleaner



Applicable for both indoor and outdoor of $\Phi 32-100\text{mm}$ in lavatories, bathrooms and kitchens. With $\Phi 12.5\text{mm}$ Inner-core cable.
 Entirely sealed structure, soft fl exible shafts are put in barrels, to ensure cleaner and more convenient use.
 Drum spin at 250rpm, cable feeding speed 5m/min.
 Rated Power: 350w.
 Rated voltage 220V; 110V optional Frequencies of 50HZ; 60HZ optional.

Type.	Description	Weight(kg)
D-1000A	Main machine Including: $\Phi 12.5\text{mm} \times 15\text{m}$ Enhanced innercore fl exible soft shafts Drilling: T-2-e; T-5-e ; T-7-e; T-8-e; Protection tube: F-7-d Key: F-3-a	68
D-1000B	Main machine Including: $\Phi 12.5\text{mm} \times 23\text{m}$ Enhanced innercore fl exible soft shafts Drilling: T-2-e; T-5-e ;T-7-e; T-8-e; Protection tube: F-7-d Key: F-3-a	73