

Datasheet

150mm Dial Caliper

RS Stock number **725-5698**



Features

- Hardened stainless steel body
- Satin chrome finish
- Thumbroll
- Depth Rod
- Four-way measurement
- Outside
- Inside
- Step
- Depth
- White dial face

| Code | Range | Metric Grads | Inch Grads | Accuracy External Jaws | Accuracy Internal Jaws & Depth Rod | External Jaw Length | Internal Jaw Length |
|----------|-------|--------------|------------|------------------------|------------------------------------|---------------------|---------------------|
| 725-5698 | 150mm | 0.02mm | N/A | ±0.02mm | ±0.04mm | 40mm | 18mm |

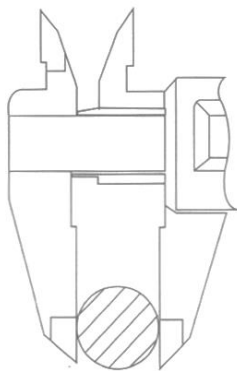

Outside Measurement

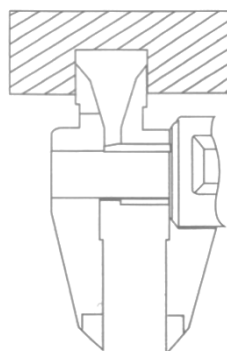

Inside Measurement

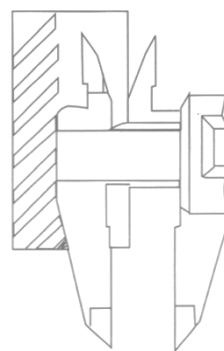

Step Measurement

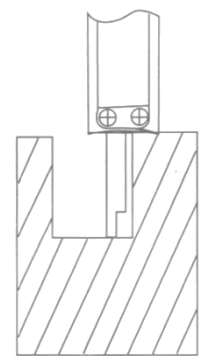

Depth Measurement