

## FEATURES

- Nitrile rubber material
- Hardness 70 shore A
- Continuous operating temperature -40°C to 110°C, short term to 135°C
- Resistant to mineral hydraulic oils and greases
- Tolerance BS4518

## RS PRO Nitrile Rubber SealBonded Seal, 21.54mm Bore, 28.58mm Outer Diameter

RS Stock No.: 689-495



RS Professionally Approved Products bring to you professional quality parts across all product categories. Our product range has been tested by engineers and provides a comparable quality to the leading brands without paying a premium price.

### Product Description

RS PRO metric O-Rings made from Nitrile, the most widely used elastomer in sealing applications. These O-Rings have an excellent resistance to petroleum products and work well in either low or high temperatures. Nitrile is highly resistant to abrasion and is an ideal choice in most industries

### General Specifications

<b>Type</b>	Bonded Seal
<b>Material</b>	Nitrile Rubber
<b>Application</b>	Automotive; Plumbing; Aerospace; General Engineering
<b>Resistance To</b>	Mineral Hydraulic Oils And Grease
<b>Kit Contents</b>	8 Pieces

### Mechanical Specifications

<b>Inside Diameter</b>	21.54mm
<b>Outside Diameter</b>	28.58mm
<b>Thickness</b>	2.5mm
<b>Hardness</b>	70 Shore A
<b>Tensile Strength</b>	14N/mm <sup>2</sup>
<b>Elongation At Break Point</b>	250%
<b>Specific Gravity</b>	1.372
<b>Density</b>	1.3g/cm <sup>3</sup>
<b>Heat Resistance</b>	Tested To 100°C For 70 Hours
<b>Compression Set 22h/ 100°C</b>	14%
<b>Volume Change</b>	-5.57%

## Operation Environment Specifications

Minimum Operating Temperature	-10°C
Maximum Operating Temperature	80°C
Glass Transition Temperature	-35°C

## Approvals

Compliance/Certifications	CE / UR / cUR
---------------------------	---------------

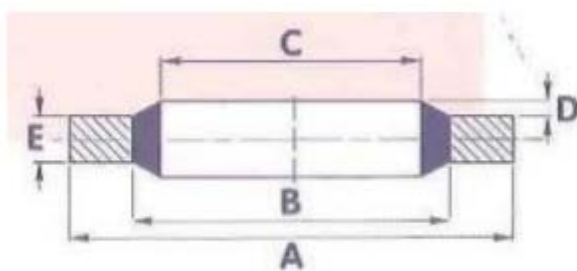

**PLAIN**

REFERENCE	SIZE (INCHES)		A	B	C	D	E	APPROX BURST PRESSURE (BAR)
	BSP	BOLT	+0.13 -0.00	+0.10 -0.10	+0.10 -0.10		+0.15 -0.15	
	-	6BA	6.35	4.09	3.05	0.20/ 0.45	1.22	2150
	-	4BA	7.26	5.26	4.12			1570
	-	2BA	8.38	6.35	5.21			1375
	-	1/4	13.21	8.00	6.86			2450
	-	1/4	13.34	9.53	6.99			1700
	-	5/16	13.34	9.53	8.31			1700
	-	5/16	14.22	10.04	8.64			1750
689-467	1/8	3/8	15.88	11.84	10.37	0.25/ 0.51	2.03	1500
	-	0.4	18.36	12.45	11.26			1950
	-	7/16	19.05	13.08	11.69			1900
689-473	1/4	1/2	20.57	15.21	13.74			1550
	-	9/16	22.23	16.39	14.86			1575
	-	0.6	22.23	17.30	15.83			1310
	-	5/8	25.40	18.75	16.51			1550
689-489	3/8	-	23.80	18.75	17.28			1260
	-	11/16	25.40	19.69	18.16			1320
	-	3/4	26.92	21.21	19.69			1260
689-495	1/2	13/16	28.58	23.01	21.54			1150
	5/8	7/8	31.75	24.97	23.49			1250
	-	15/16	33.27	26.04	24.26			1275
689-502	3/4	1.0	34.93	28.53	27.05			1060
	-	1.1/16	38.61	30.61	27.82	1250		
	-	1.1/8	36.58	30.86	29.33	900		
	-	7/8	38.10	32.29	30.81	900		
	-	1.1/4	41.40	35.69	32.64	3.38	800	
689-518	1.0	1.5/16	42.80	36.88	33.89	2.50	810	