

# Datasheet

## Spacer For Use With Any Enclosure

RS Stock number 603-514

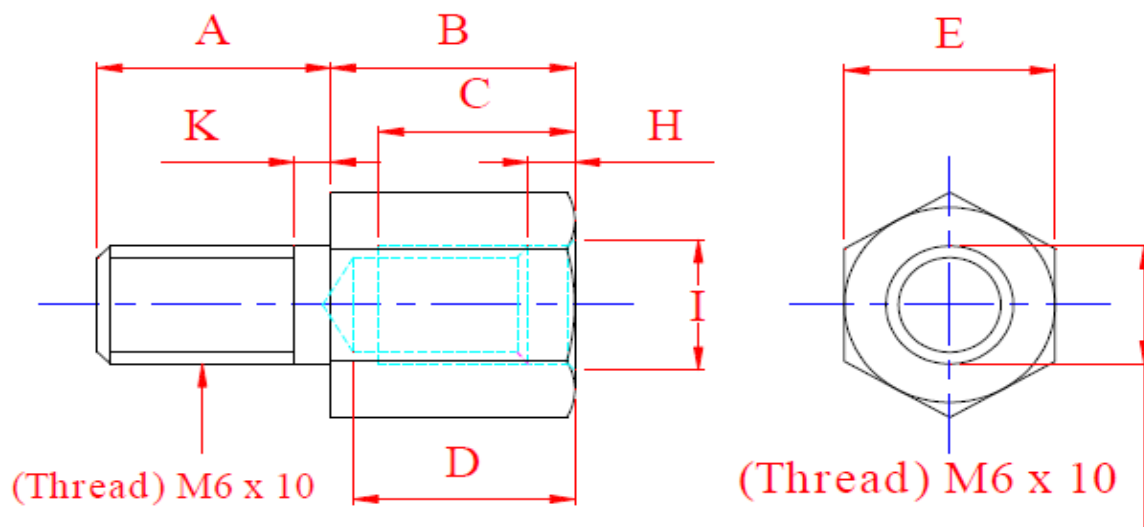

| Stock No.                                       | Dimensions (in mm) |    |               |          |
|---|--------------------|----|---------------|----------|
|   | A                  | B  | C             | D (Max.) |
| 603-485   | 7-5                | 10 | 6.0 +0/ -1.0  | 8        |
| 603-491   | 7-5                | 12 | 8.0 +0/ -1.0  | 10       |
| 603-508   | 10                 | 14 | 10.0 +0/ -1.0 | 12       |
| 603-514   | 10                 | 16 | 10.0 +0/ -1.0 | 12       |
| 603-520   | 10                 | 18 | 10.0 +0/ -1.0 | 12       |
| 603-536   | 20                 | 20 | 16.0 +0/ -1.0 | 18       |
| E : 10 ; H : 2 ; I : (Dia) 6.1 ; K : (Max.) 1.7 |                    |    |               |          |

Material : Cold Rolled Steel.

Finish : Zinc Plated.