

Thank you for choosing **Schneider Electric** Affle Plus series products. To ensure proper application of our product, please read through the following information before installation and use.

This application guide applies to the following products.

Cat. No.	Description
A3G31RJ4	1 Gang Telephone Socket
A3G31RJ5E	1 Gang Category 5e Data Socket
A3G31TVM	1 Gang TV Socket, 75Ω Master
A3G32RJ4_5E	2 Gang Telephone & Category 5e Data Socket
A3G32RJ5E	2 Gang Category 5e Data Socket
A3G32TVFMM	2 Gang TV 75Ω Master / FM Socket
A3G32TVRJ5E	2 Gang TV Through connection & Category 5e Data Socket

REV.00

SPECIFICATIONS

Mounting centre : 60.3mm
Compliance : BS5733

IMPORTANT NOTE

- The products must be installed by qualified electricians.
- Please check your local wiring regulations before installation.
- Safekeeping the surround to prevent damage during product installation.
- Turn off the power supply when you clean the product. Use a soft, slightly-moistened cloth or tissue paper to wipe off the dust and dirt on the surface. Clean with much diluted detergent if necessary but avoid using corrosive chemicals.

WIRING DIAGRAMS

TV outlet wiring instructions

- Cut off 20mm long outer jacket from the end of the cable (Figure 1);
- Stripping 14mm long braiding and copper core insulation, expose copper core (Figure 2);
- Loosen the screw thread, insert the copper core and tighten the screw as shown in Figure 3

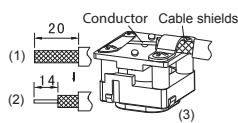

Information outlet wiring instructions

- Stripping the cable jacket 15-17 mm with a stripping tool,
- Spread and fan out the wires according to the selected wiring standard (568A / 568B).
- Open the protective cover and insert all 8 wires into corresponding slots as shown in Figure (a)
- Press the protective cover until it snaps into position and secure termination as shown in Figure (b)
- After completion of wiring, check and maintain the twisted pairs as close to the end of cable

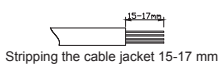

Stripping the cable jacket 15-17mm

The selected wiring standard

	TIA/EIA 568A	TIA/EIA 568B
1	A	B
2	5 6 A	5 6 B
3	5 6 B	5 6 A
4	5 6 4	5 6 4
5	4	4
6	B	A
7	7	7
8	5 6 7	5 6 7

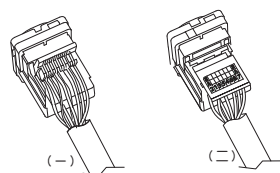

Telephone socket wiring instructions

- Stripping the wire with a stripping tool 15-17mm.
- Please refer to the selected wiring standard (568B), the line according to the product color order arranged.
- The product pressure line cover to open the order of the line into the corresponding trunking; as shown in Figure (a)
- Cover the crimping cover so that the edges are fastened to the slot to complete the wiring. As shown in Figure (b)
- After the completion of the line, from the connection point, each pair of twisted pair of non-stranded length of not more than 13mm.

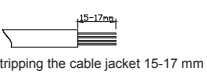

Stripping the cable jacket 15-17mm

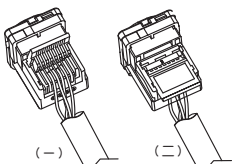

MOUNTING INSTRUCTION

- Connect the wires to the terminals.
- Screw the grid plate onto the wall box.
- Snap the dolly and surround.

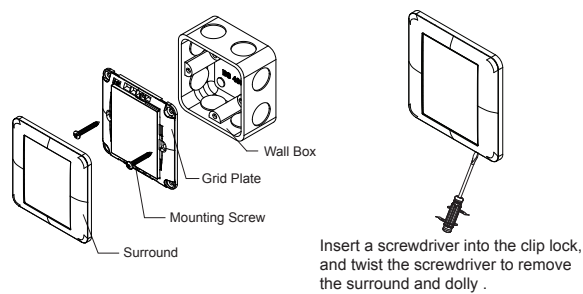

Insert a screwdriver into the clip lock, and twist the screwdriver to remove the surround and dolly .

感謝閣下選用 **Schneider Electric** 施耐德電氣Affle Plus系列產品。在安裝及使用本產品前，請仔細閱讀內文指示。

此手冊適用於以下產品型號：

型號	摘要
A3G31RJ4	單位電話插座
A3G31RJ5E	單位5e類數據插座
A3G31TVM	單位電視天線·75Ω主板插座
A3G32RJ4_5E	單位電話及5e類數據插座
A3G32RJ5E	兩位5e類數據插座
A3G32TVFMM	兩位電視/收音機天線主板插座
A3G32TVRJ5E	單位電視及5e類數據插座

REV.00

產品規格

安裝中心距 : 60.3mm
安全標準 : BS5733

注意事項

- 產品安裝須由符合資格的電工完成
- 安裝前請查核是否抵觸當地之有關布線規例
- 產品安裝期間，請妥善放置與保管面蓋，以防壓傷損壞
- 清潔時，切記先關上電源，再用輕微濕潤的軟性布料或紙巾抹拭表面的塵埃或贓物，必要時可用極為稀釋的清潔劑，但切忌使用帶有腐蝕性的化學溶液(如：堿性或酸性洗滌、稀釋劑、汽油、殺蟲劑等)，否則，可能會導致本產品表面開裂或其他故障

接線圖

電視插座接線說明

- 由電纜端部起剝開20mm長的塑料外皮(圖1);
- 剝除14mm長的屏蔽網和銅芯絕緣套,露出銅芯(圖2);
- 松開壓線螺絲,按圖3所示裝好線並擰緊螺絲。

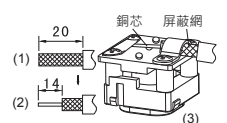

信息插座接線說明

- 用剝線工具剝線15-17mm,
- 請參照所選布線標準(568A/568B),將線按產品色標順序排列好。
- 將產品壓線蓋打開把排好順序的線放入對應的線槽內;如圖(壹)所示
- 將壓線蓋蓋下,使邊上扣位入槽扣住完成接線。如圖(二)所示
- 打線完畢後,從連接點起,每對雙絞線的未絞合長度不得大于13mm。

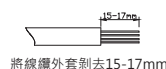

將線纜外套剝去15-17mm

兩種線序和顏色對應表

	TIA/EIA 568A	TIA/EIA 568B
1	A	B
2	5 6 A	5 6 B
3	5 6 B	5 6 A
4	5 6 4	5 6 4
5	4	4
6	B	A
7	7	7
8	5 6 7	5 6 7

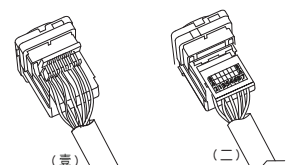

電話插座接線說明

- 用剝線工具剝線15-17mm,
- 請參照所選布線標準(568B),將線按產品色標順序排列好。
- 將產品壓線蓋打開把排好順序的線放入對應的線槽內;如圖(壹)所示
- 將壓線蓋蓋下,使邊上扣位入槽扣住完成接線。如圖(二)所示
- 打線完畢後,從連接點起,每對雙絞線的未絞合長度不得大于13mm。

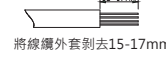

將線纜外套剝去15-17mm

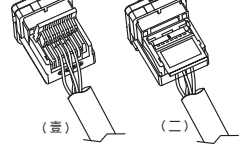

安裝指南

- 把線纜接入接線端子;
- 把內框固定於底箱;
- 安裝面板。

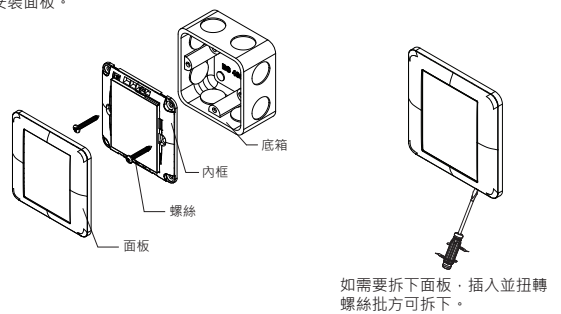

如需要拆下面板,插入並扭轉螺絲批方可拆下。

> Note:
1/ 70g high quality uncoated Book-Paper (white).
2/ Double side printing.



> Folding / Appearance & Size :

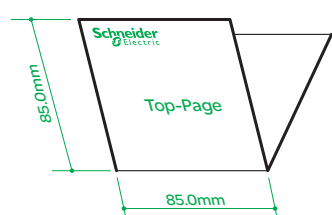

> ARTWORK :
File Size = A3

*****		Initial Release	ZXZ	00
DECN/ECN/TCAN	DESCRIPTION		DRN	REV
NUMBER :	MBA BS VDI manual	Revision:	Sheet:	
		00	1/1	