

## Through Thread Scallop Knob



### Material

High impact resistant thermoplastic

### Standard colour

Black

### Finish

Matt

### Female insert material

Brass

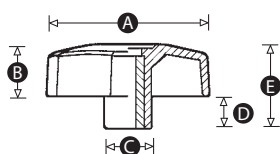

Part No.	A	B	C	D	E	Thread size
161212	40	12	17	8	20	M6
161228	50	15	18	9	24	M6
161234	50	15	18	9	24	M8
161240	60	18	20	12	30	M10