

# Datasheet

## RS PRO 6 Pole Male Miniature DIN Connector, MDN Series , 50 V ac/dc, 1A

RS Stock number [463-388](#)

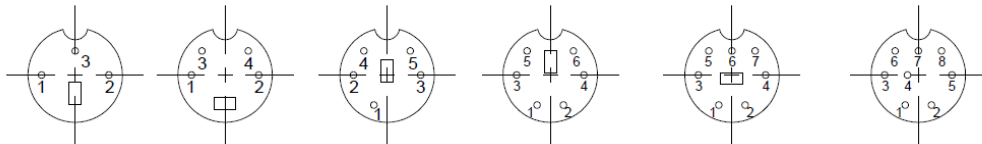

GTT P/N	MDP3SA	MDP4SA	MDP5SA	MDP6SA	MDP7SA	MDP8SA
RS P/N	463-366	463-372		463-388		463-394
NO of pins	3	4	5	6	7	8

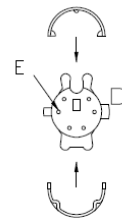
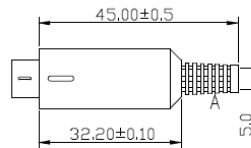
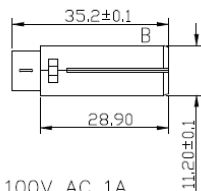
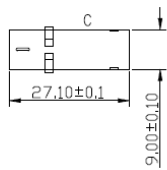

Rating: 100V AC 1A  
 Insulation  
 Resistance: 50Mohm/500V DC  
 Dielectric: 500V AC/1minute

REACH  
RoHS

### Materials:

- A.BOOT: PVC
- B.MIDDLE HOOD: ABS
- C.METAL PART: COPPER, NICKEL PLATED
- D.INSULATOR: PC
- E.PIN CONTACT: COPPER,SILVER

## Specifications

- Temperature Range:-25 ° C to +85 ° C
- Applicable Wires: AWG 26-30
- Current Rating: 1A AC/DC
- Insulation Resistance: 50M Ω min
- Voltage Rating: 50V AC/DC
- Withstanding Voltage: 500V AC for 1 min
  
- Material/ Finish
- Metal Shell: Brass
- Contacts: Solder Bucket
- Contact Materials: Plug- Brass, Receptacle – Phosphor/Bronze
- Contact Plating: Pb/Sn, Tin or Au/Nickel
- Mould-in Cover: Tinned/ Bass
- Insulator: PBT or Nylon +30% Fibre reinforced (UL94V-0)