

## Main

|                           |                      |
|---------------------------|----------------------|
| Range of product          | Easy Harmony XA2     |
| Product or component type | Complete push-button |
| Device short name         | XA2                  |
| Bezel material            | Plastic              |
| Fixing collar material    | Plastic              |

## Complementary

|   |   |
|---|---|
| Mounting diameter                           | 22.5 mm   |
| Sale per indivisible quantity               | 1   |
| Protective treatment                        | TC  |
| Operating position                          | Any position  |
| Fixing center                               | >= 30 x 40 mm (panel) - thickness: 1...5 mm   |
| Fixing mode                                 | Fixing nut: 2...2.4 N.m   |
| Shape of signaling unit head                | Round   |
| Type of operator                            | Spring return   |
| Operator profile                            | Green flush   |
| Contacts type and composition               | 1 NO  |
| Contact operation                           | Slow-break  |
| Mechanical durability                       | 1500000 cycles  |
| Connections - terminals                     | Screw clamp terminal, <= 2 x 1.5 mm <sup>2</sup><br>Screw clamp terminal, <= 1 x 2.5 mm <sup>2</sup><br>Screw clamp terminal, >= 1 x 0.5 mm <sup>2</sup><br>Faston terminals, connection size: 6.3 mm |
| Tightening torque                           | 0.8 N.m   |
| Short-circuit protection                    | 10 A gL fuse conforming to IEC 60269-1  |
| [Ith] conventional free air thermal current | 10 A  |
| [Ui] rated insulation voltage               | 600 V conforming to IEC 60947-1   |
| [Uimp] rated impulse withstand voltage      | 6 kV conforming to IEC 60947-1  |
| [Ie] rated operational current              | 3 A at 240 V, AC-15, A600<br>0.27 A at 250 V, DC-13, Q600   |
| Electrical durability                       | 500000 Cycles, AC-15, 3 A at 230 V, operating rate <60 cyc/mn, load factor: 0.5 conforming to IEC 60947-5-4<br>500000 cycles, DC-13, 0.2 A at 110 V, operating rate <60 cyc/mn, load factor: 0.5      |
| Electrical reliability                      | $\Lambda < 10\text{exp}(-8)$ at 24 V  |
| Width                                       | 30 mm   |
| Height                                      | 42 mm   |
| Depth                                       | 54.7 mm   |
| Net weight                                  | 0.032 kg  |
| Cap/operator or lens colour                 | Green   |
| Type of operator                            | Spring return   |

## Environment

|                                       |   |
|---------------------------------------|---|
| Ambient air temperature for storage   | -40...70 °C   |
| Ambient air temperature for operation | -25...55 °C   |
| Overvoltage category                  | Class I conforming to IEC 536   |
| IP degree of protection               | IP65 conforming to IEC 60529  |
| IK degree of protection               | IK03 conforming to IEC 60529  |
| Standards                             | IEC 60947-5-1<br>GB 14048.1<br>GB 14048.5<br>IEC 60947-1                              |
| Product certifications                | CCC[RETURN]CE   |
| Vibration resistance                  | 10 gn (f= 40...500 Hz) conforming to IEC 60068-2-6                                    |
| Shock resistance                      | 70 gn (duration = 11 ms) for half sine wave acceleration conforming to IEC 60068-2-27 |

## Packing Units

|                              |           |
|------------------------------|-----------|
| Unit Type of Package 1       | PCE       |
| Number of Units in Package 1 | 1         |
| Package 1 Height             | 3.000 cm  |
| Package 1 Width              | 3.000 cm  |
| Package 1 Length             | 6.500 cm  |
| Package 1 Weight             | 32.000 g  |
| Unit Type of Package 2       | BB1       |
| Number of Units in Package 2 | 5         |
| Package 2 Height             | 9.000 cm  |
| Package 2 Width              | 11.500 cm |
| Package 2 Length             | 14.500 cm |
| Package 2 Weight             | 160.000 g |
| Unit Type of Package 3       | S02       |
| Number of Units in Package 3 | 100       |
| Package 3 Height             | 15.000 cm |
| Package 3 Width              | 30.000 cm |
| Package 3 Length             | 40.000 cm |
| Package 3 Weight             | 3.568 kg  |

## Offer Sustainability

|                            |   |
|----------------------------|---|
| Sustainable offer status   | Green Premium product   |
| REACH Regulation           | <a href="#">REACH Declaration</a>   |
| REACH free of SVHC         | Yes   |
| EU RoHS Directive          | Pro-active compliance (Product out of EU RoHS legal scope) <a href="#">EU RoHS Declaration</a>                              |
| Mercury free               | Yes   |
| China RoHS Regulation      | <a href="#">China RoHS Declaration</a>  |
| RoHS exemption information | <a href="#">Yes</a>   |
| Environmental Disclosure   | <a href="#">Product Environmental Profile</a>   |
| Circularity Profile        | <a href="#">End Of Life Information</a>   |
| WEEE                       | The product must be disposed on European Union markets following specific waste collection and never end up in rubbish bins |

Dimensions

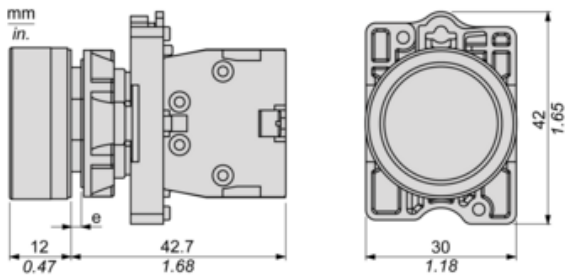

(e) Clamping thickness: 1 to 6 mm / 0.04 to 0.24 in.

Panel Cut-out for Pushbuttons, Switches and Pilot Lights (Finished Holes, Ready for Installation)

Connection by Screw Clamp Terminals

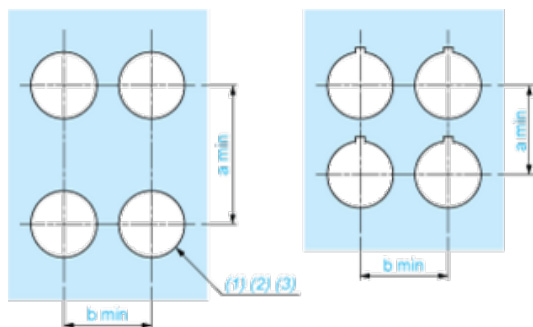

- (1) Diameter on finished panel or support
- (2) For selector switches and Emergency stop buttons, use of an anti-rotation plate type ZB5AZ902 is recommended.
- (3)  $\varnothing 22.5$  mm recommended ( $\varnothing 22.3_0^{+0.4}$ ) /  $\varnothing 0.89$  in. recommended ( $\varnothing 0.88$  in.  $^{+0.016}$ )

| Connections                        | a in mm | a in in. | b in mm | b in in. |
|------------------------------------|---------|----------|---------|----------|
| By screw clamp terminals connector | 40      | 1.57     | 30      | 1.18     |
| By Faston connectors               | 45      | 1.77     | 32      | 1.26     |

Detail of Lug Recess

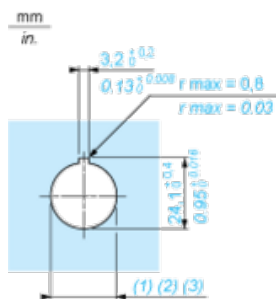

- (1) Diameter on finished panel or support
- (2) For selector switches and Emergency stop buttons, use of an anti-rotation plate type ZB5AZ902 is recommended.
- (3)  $\varnothing 22.5$  mm recommended ( $\varnothing 22.3_0^{+0.4}$ ) /  $\varnothing 0.89$  in. recommended ( $\varnothing 0.88$  in.  $^{+0.016}$ )