



MD-M2 electric operational mechanism



Schematic diagram of assembly of motor-driven mechanism with the body

External Accessories

MD motor-driven mechanism

Function: it is applicable for switching circuit breaker on and off and retrip remotely, as well as automation application.

Model description

MD - □ □ □ □

Applicable product: Thermal-magnetic (omit), Electronic type (E), residual current type (LE).

Product breaking capacity: General (omit), S,H.

Applicable voltage code (see table2, only A1, A2 are applicable)

Frame size code (see table1)

Name code of motor-driven mechanism

For example: motor driven code of 63/125 frame moulded case circuit breaker 400V: MD-M1A2

Table1 frame size code

Frame size	63/125	160	250/320	400/630	800	1000	1250/1600
Code	M1	M2	M3	M4	M5	M6	M7

Table2 Applicable voltage code

Voltage	AC220V/230V/240V	AC380V/400V/415V	DC24V	DC110V	DC220V
Code	A1	A2	D1	D2	D3

Electrical characteristics

Category	Model	63/125/250/320 frame	All series
Structural style		Electromagnet	DC-AC
Voltage specification		AC230V, 400V	AC110V, 230V, 400V, AC220V, 230V, 240V, AC380V, 400V, 415V, DC24V, 110V, 220V, DC110V, 220V
Rated frequency		50Hz	50/60 Hz

Wiring diagram

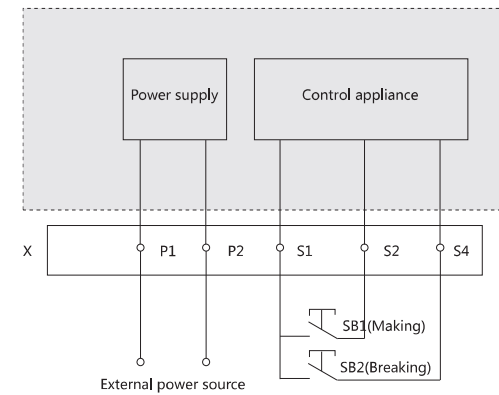

Description: SB1, SB2 is separately the on and off button;

P1, P2 are the external power line terminal. P1 will be connected to "+", and P2 will be connected to "-" if the external power source is DC.

Motor-driven mechanism

Installation sketch of electric operational mechanism

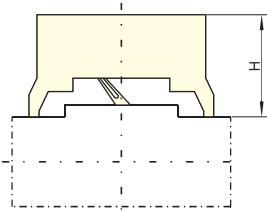

M

Frame size	63A	160A	250A	400A	800A	1000A	1250/1600A
	125A		320A	630A			
Installation size H(mm)	93	97	97.5	154	153	154.5	156