

FEATURES

- Piezo buzzer with a slow-pulsed tone
- Screw mounting
- Minimum supply voltage of 6 V DC
- Maximum supply voltage of 28 V DC
- 80 dB sound level
- Internal drive
- Diameter of 42.5 mm
- Height of 33 mm
- Operating temperature range of -30°C to +85°C
- Supply current of 32 mA
- Minimum frequency of 2300 kHz
- Maximum frequency of 3.3 kHz

RS PRO 80dB, Panel Mount Slow Pulse Internal Piezo Buzzer

RS Stock No.: 535-8499



RS Professionally Approved Products bring to you professional quality parts across all product categories. Our product range has been tested by engineers and provides a comparable quality to the leading brands without paying a premium price.

Product Description

Part of our stringently tested RS PRO series, these internal buzzers are designed to be versatile. They operate at a wide voltage range and deliver crisp sound from a compact package. The buzzers are suitable for use in many areas, including most consumer appliances, including computers and microwaves. They draw a 32 mA current, making them more reliable than lower current buzzers, and they can function between 6 V DC to 28 V DC. Their slow-pulsing 80 dB tone is audible and clear, even from some distance. Compared to magnetic buzzers, they have a lower impact on surrounding circuitry. For fast and simple installation, they come with a screw mounting.

General Specifications

Mounting Type	Panel Mount
Sound Level	80dB
Drive Type	Internal
Tone Type	Slow Pulse
Colour	Black
Application	Alarms or warning systems, communications equipment and electronic cash registers.

Electrical Specifications

Minimum Supply Voltage	6Vdc
Maximum Supply Voltage	28Vdc
Maximum Frequency	3.3kHz
Minimum Frequency	2300Hz
Supply Current	32 mA

Mechanical Specifications

Diameter	42.5mm
Height	33mm
Dimensions	42.5 (Dia.) x 33mm
Weight	32g
Sound Level Distance	30cm

Operation Environment Specifications

Minimum Operating Temperature	-30°C
Maximum Operating Temperature	85°C

Approvals

Compliance/Certifications	ANSI/ESD S20.20:2014, BS EN 61340-5-1:2007
----------------------------------	--





Top View

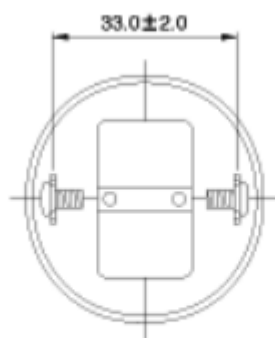

Bottom View 1

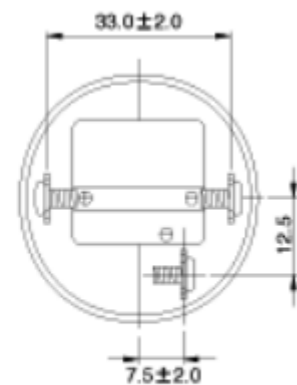

Bottom View 2

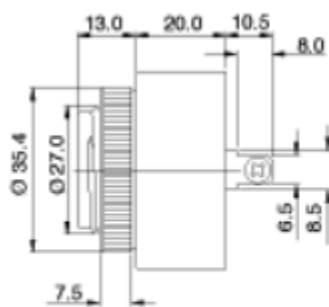

Side View A

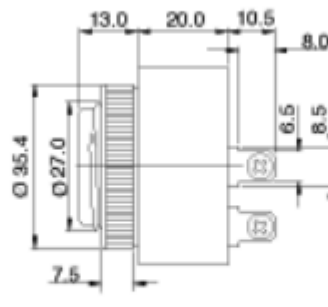

Side View B

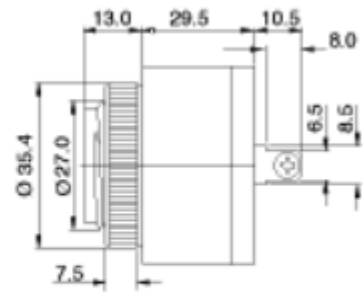

Side View C

Tolerance: ±0.5mm Unit: mm